



Polamco | Polamco Swept Elbow

TE Internal #: AAF2404-00

Unscreened, Backshell, Aluminum Alloy, Swept Right Angle, 09

Shell Size, 04 Entry Size, Polamco Swept Elbow

[View on TE.com >](#)

Connectors > Connector Accessories > Connector Backshells



Connector Backshell Product Style: **Unscreened**

Connector Backshell Product Type: **Backshell**

Primary Product Material: **Aluminum Alloy**

Body Orientation: **Swept Right Angle**

Compatible With Connector Shell Size: **09**

Features

Contact Features

| | |
|---------------------------------------|--------------------|
| Primary Product Underplating Material | Electroless Nickel |
|---------------------------------------|--------------------|

Industry Standards

| | |
|---------------------------------------|---------------|
| Connector Detail Specification Number | MIL-DTL-38999 |
|---------------------------------------|---------------|

Dimensions

| | |
|----------------|------------------|
| Product Length | 18.8 mm [.74 in] |
|----------------|------------------|

Product Type Features

| | |
|-----------------------------------|------------|
| Connector Backshell Product Style | Unscreened |
| Connector Backshell Product Type | Backshell |
| Sealable | Yes |

Body Features

| | |
|----------------------------------|----------------|
| Primary Product Material | Aluminum Alloy |
| Primary Product Plating Material | Cadmium |

Housing Features

| | |
|---------------------------------|-------------------|
| Body Orientation | Swept Right Angle |
| Compatible With Connector Shape | Circular |

Operation/Application

| | |
|--------------------------------------|----|
| Compatible With Connector Shell Size | 09 |
|--------------------------------------|----|



Other

| | |
|-----------------------------------|-------------------------------|
| Connector Interface Specification | MIL-DTL-38999 Series III & IV |
| TE Connector Interface Code | 40 |
| Entry Size Code | 04 |
| EU RoHS Compliance | Not Compliant |
| EU ELV Compliance | Not Compliant |

Usage Conditions

| | |
|-----------------------------|----------------------------|
| Operating Temperature Range | -65 – 175 °C[-85 – 347 °F] |
|-----------------------------|----------------------------|

Product Compliance

For compliance documentation, visit the product page on [TE.com](#)>

| | |
|---|--|
| EU RoHS Directive 2011/65/EU | Not Compliant |
| EU ELV Directive 2000/53/EC | Not Compliant |
| China RoHS 2 Directive MIIT Order No 32, 2016 | Restricted Materials Above Threshold |
| EU REACH Regulation (EC) No. 1907/2006 | Current ECHA Candidate List: JUNE 2024 (241) Candidate List Declared Against: JAN 2024 (240) SVHC > Threshold: Pb (.3% in BODY AND NUT) Cd (3% in BODY AND NUT) Article Safe Usage Statements: Use personal protective equipment as required. Do not eat, drink or smoke when using this product. Wash thoroughly after handling. Recycle if possible and dispose of the article by following all applicable governmental regulations relevant to your geographic location. |
| Halogen Content | Low Halogen - Br, Cl, F, I < 900 ppm per homogenous material. Also BFR/CFR/PVC Free |
| Solder Process Capability | Not applicable for solder process capability |

Product Compliance Disclaimer

This information is provided based on reasonable inquiry of our suppliers and represents our current actual knowledge based on the information they provided. This information is subject to change. The part numbers that TE has identified as EU RoHS compliant have a maximum concentration of 0.1% by weight in homogenous materials for lead, hexavalent chromium, mercury, PBB, PBDE, DBP, BBP, DEHP, DIBP, and 0.01% for cadmium, or qualify for an exemption to these limits as defined in the Annexes of Directive 2011/65/EU (RoHS2). Finished electrical and electronic equipment products will be CE marked as required by Directive 2011/65/EU. Components may not be CE marked. Additionally, the part numbers that TE has identified as EU ELV compliant have a maximum concentration of 0.1% by weight in homogenous materials for lead, hexavalent chromium, and mercury, and 0.01% for cadmium, or qualify for an exemption to these limits as defined in the Annexes of Directive 2000/53/EC (ELV). Regarding the REACH Regulation, the information TE provides on SVHC in articles for this part number is based on the latest European Chemicals Agency (ECHA) 'Guidance on requirements for substances in articles' posted at this URL: <https://echa.europa.eu/guidance-documents/guidance-on-reach>



Compatible Parts



TE Part # CW2823-000
R85049/128-3

Also in the Series | Polamco Swept Elbow



Circular Connector Backshells & Clamps(25)



Connector Backshells(25)



Unscreened Backshells & Adapters(25)

Customers Also Bought



TE Part #3-928343-8
STD-TIMER GEH 8P



TE Part #1-965641-3
TAB HOUSING 2,8 6P

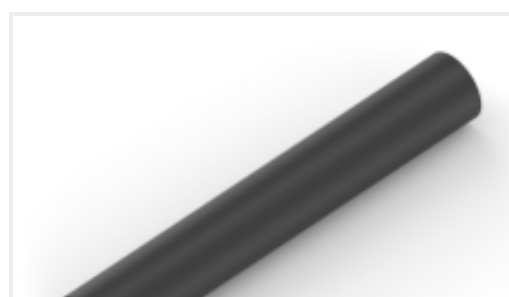

TE Part #NB11644001
ATUM-6/2-0-SP



TE Part #A70754-000
B-155-03



TE Part #D561523001
RAY-101-4.0(100)



TE Part #CAT-AM705-CH8173
AMP Unsealed Connector Housing



TE Part #1241404-1
AMP MCP 6.3/4.8K, CONTACT



TE Part #1-967325-3
2,5MM BU-GEH 2P



Documents

Product Drawings

[BTH3-09-04-1-B-SE](#)

English