

## AMP-HDI

TE Internal #: 533914-3

PCB Mount Receptacle, Right Angle, Board-to-Board, 120 Position,  
2.54 mm [.1 in] Centerline, Gold, Through Hole - Solder, Signal,  
Black, Tube

[View on TE.com >](#)

Connectors &gt; PCB Connectors &gt; PCB Headers &amp; Receptacles

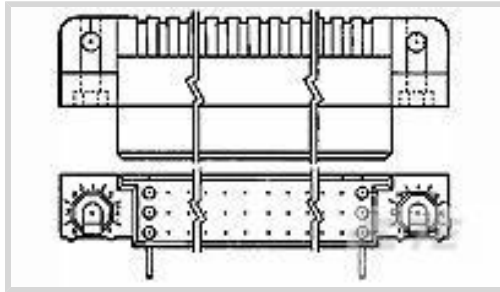
PCB Connector Assembly Type: **PCB Mount Receptacle**PCB Mount Orientation: **Right Angle**Connector System: **Board-to-Board**Number of Positions: **120**Number of Rows: **3****Features****Electrical Characteristics**

|                       |      |
|-----------------------|------|
| Insulation Resistance | 3 MΩ |
|-----------------------|------|

**Dimensions**

|                             |                  |
|-----------------------------|------------------|
| PCB Thickness (Recommended) | 2.36 mm[1.27 in] |
| Connector Height            | 9.1 mm[.36 in]   |

**Packaging Features**

|                    |      |
|--------------------|------|
| Packaging Quantity | 4    |
| Packaging Method   | Tube |

**Operation/Application**

|                          |        |
|--------------------------|--------|
| Assembly Process Feature | None   |
| Circuit Application      | Signal |

**Mechanical Attachment**

|                          |               |
|--------------------------|---------------|
| PCB Mount Retention Type | Mounting Hole |
| Mating Alignment Type    | Keyed         |
| PCB Mount Retention      | Without       |
| PCB Mount Alignment      | Without       |
| Connector Mounting Type  | Board Mount   |
| Mating Alignment         | Without       |

**Termination Features**



|   |                       |
|---|-----------------------|
| Rectangular Termination Post & Tail Width     | .58 mm[.023 in]       |
| Rectangular Termination Post & Tail Thickness | .25 mm[.01 in]        |
| Termination Post & Tail Length                | 4.57 mm[.18 in]       |
| Termination Method to PCB                     | Through Hole - Solder |

### Contact Features

|  |                  |
|--|------------------|
| Contact Mating Area Plating Material Thickness | 1.27 µm[50 µin]  |
| Mating Square Post Dimension                   | .64 mm[.025 in]  |
| Contact Shape & Form                           | Four Beam        |
| Contact Layout                                 | Matrix           |
| Contact Base Material                          | Beryllium Copper |
| PCB Contact Termination Area Plating Material  | Tin-Lead         |
| Contact Mating Area Plating Material           | Gold             |
| Contact Type                                   | Socket           |
| Contact Current Rating (Max)                   | 3 A              |

### Housing Features

|                    |                |
|--------------------|----------------|
| Housing Material   | Thermoplastic  |
| Centerline (Pitch) | 2.54 mm[.1 in] |

### Configuration Features

|                       |             |
|-----------------------|-------------|
| Stackable             | No          |
| PCB Mount Orientation | Right Angle |
| Number of Positions   | 120         |
| Number of Rows        | 3           |

### Product Type Features

|                                   |                       |
|-----------------------------------|-----------------------|
| PCB Connector Assembly Type       | PCB Mount Receptacle  |
| Connector System                  | Board-to-Board        |
| Sealable                          | No                    |
| Connector & Contact Terminates To | Printed Circuit Board |

### Body Features

|                       |       |
|-----------------------|-------|
| Primary Product Color | Black |
|-----------------------|-------|

### Usage Conditions

|                             |                            |
|-----------------------------|----------------------------|
| Operating Temperature Range | -65 – 125 °C[-85 – 257 °F] |
|-----------------------------|----------------------------|

### Industry Standards



|                        |          |
|------------------------|----------|
| UL Flammability Rating | UL 94V-0 |
|------------------------|----------|

**Other**

|                    |                           |
|--------------------|---------------------------|
| EU RoHS Compliance | Not Compliant             |
| EU ELV Compliance  | Compliant with Exemptions |

**Product Compliance**

[For compliance documentation, visit the product page on TE.com>](#)

|   |  |
|---|--|
| EU RoHS Directive 2011/65/EU                  | Not Compliant  |
| EU ELV Directive 2000/53/EC                   | Compliant with Exemptions  |
| China RoHS 2 Directive MIIT Order No 32, 2016 | Restricted Materials Above Threshold   |
| EU REACH Regulation (EC) No. 1907/2006        | Current ECHA Candidate List: JUNE 2024 (241)<br>Candidate List Declared Against: JAN 2020 (205)<br>Does not contain REACH SVHC |
| Halogen Content                               | BFR/CFR/PVC Free, but Br/Cl >900 ppm in other sources.   |
| Solder Process Capability                     | Not lead free process capable  |

Product Compliance Disclaimer

This information is provided based on reasonable inquiry of our suppliers and represents our current actual knowledge based on the information they provided. This information is subject to change. The part numbers that TE has identified as EU RoHS compliant have a maximum concentration of 0.1% by weight in homogenous materials for lead, hexavalent chromium, mercury, PBB, PBDE, DBP, BBP, DEHP, DIBP, and 0.01% for cadmium, or qualify for an exemption to these limits as defined in the Annexes of Directive 2011/65/EU (RoHS2). Finished electrical and electronic equipment products will be CE marked as required by Directive 2011/65/EU. Components may not be CE marked. Additionally, the part numbers that TE has identified as EU ELV compliant have a maximum concentration of 0.1% by weight in homogenous materials for lead, hexavalent chromium, and mercury, and 0.01% for cadmium, or qualify for an exemption to these limits as defined in the Annexes of Directive 2000/53/EC (ELV). Regarding the REACH Regulation, the information TE provides on SVHC in articles for this part number is based on the latest European Chemicals Agency (ECHA) 'Guidance on requirements for substances in articles' posted at this URL: <https://echa.europa.eu/guidance-documents/guidance-on-reach>

**Compatible Parts**

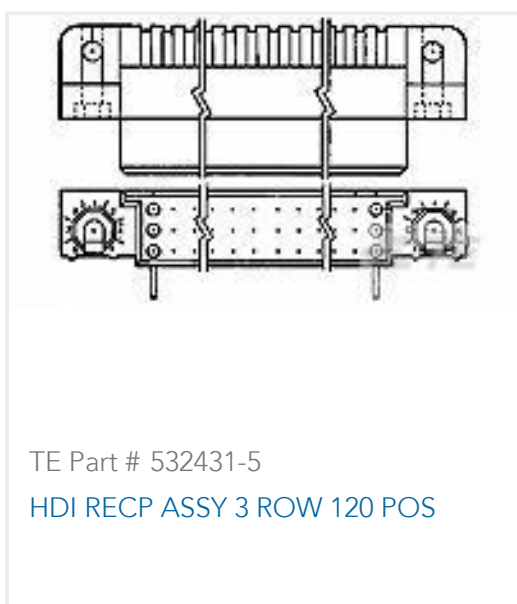

## Customers Also Bought

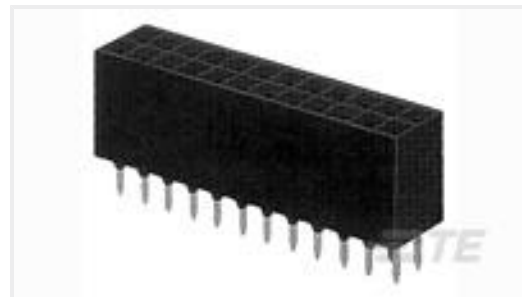

TE Part #2-534236-7  
54 MODII VRT DR CE 100/120

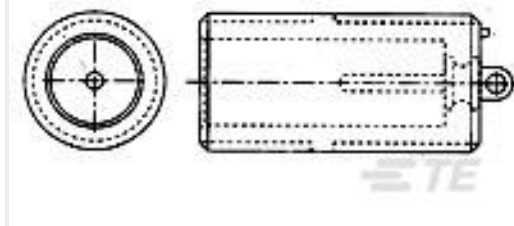

TE Part #448463-1  
LGH-1 RCPT,W/1/2-32 UN THREAD



TE Part #CAT-D38999-DTS24L  
D38999: Straight Plug, 23-21 Insert

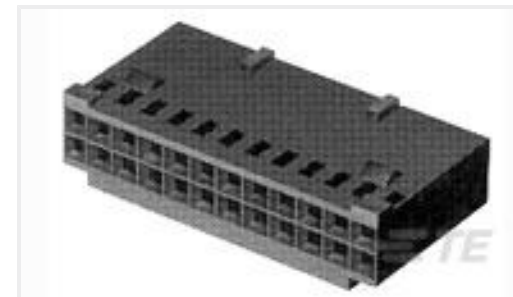

TE Part #5-87631-7  
72 MODIV HSG COMP DR .100 POL

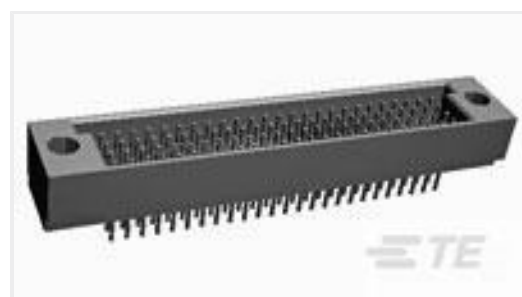

TE Part #533935-6  
HDI PIN ASSY 4 ROW 240 POS



TE Part #YDTS24W23-21AAV001  
RECP ASSY

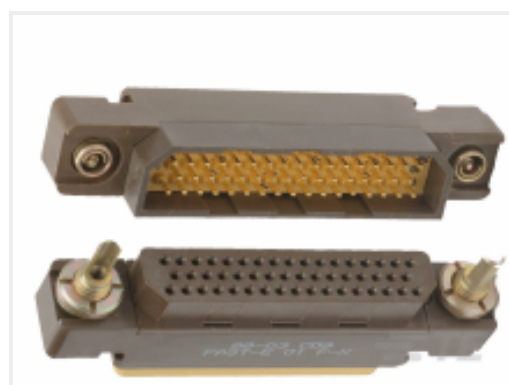

TE Part #ZPF000000000017895  
FAST-E 07 M-X-B 00 A

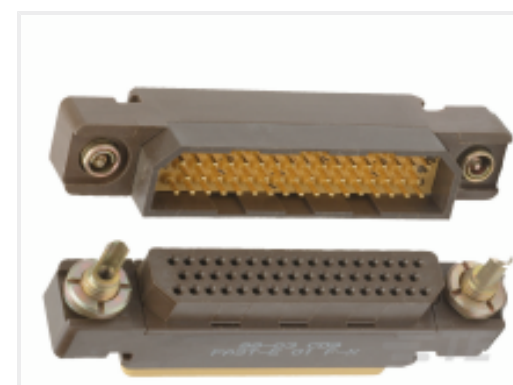

TE Part #FAST-E07F-XA00A  
MODULE ASSY



TE Part #1-532956-3  
86 MODII 2PC CE RCPT ASSY

## Documents

### Product Drawings

[HDI RECP ASSY 3 ROW 120 POS](#)

English

### CAD Files

[3D PDF](#)

3D

Customer View Model

[ENG\\_CVM\\_CVM\\_533914-3\\_H.2d\\_dxf.zip](#)

English

Customer View Model

[ENG\\_CVM\\_CVM\\_533914-3\\_H.3d\\_igs.zip](#)

English

Customer View Model

[ENG\\_CVM\\_CVM\\_533914-3\\_H.3d\\_stp.zip](#)

English

By downloading the CAD file I accept and agree to the [Terms and Conditions](#) of use.



**Product Specifications**

[Application Specification](#)

English

---

**Instruction Sheets**

[Instruction Sheet \(U.S.\)](#)

English

---

**Agency Approvals**

[Agency Approval Document](#)

English