

153211-1 ✓ ACTIVE

MATE-N-LOK | Commercial MATE-N-LOK

TE Internal #: 153211-1

Socket Contact, Tin, 250 VAC, Locking Lance Contact Retention, 20 – 15 AWG, .52 – 1.5 mm<sup>2</sup> Wire, Crimp, Brass, Power, Commercial MATE-N-LOK

[View on TE.com >](#)



Connectors > Contacts > Connector Contacts



Contact Type: **Socket**

Contact Mating Area Plating Material: **Tin**

Wire Contact Termination Area Plating Material: **Pre-Tin**

Operating Voltage: **250 VAC**

Contact Retention Within Housing: **With**

## Features

### Packaging Features

Packaging Method	Reel
------------------	------

### Dimensions

Compatible Insulation Diameter Range	2.03 – 3.05 mm [.08 – .12 in]
Wire Size	.52 – 1.5 mm <sup>2</sup>

### Mechanical Attachment

Wire Insulation Support	Without
Contact Retention Type Within Housing	Locking Lance

### Contact Features

Contact Orientation	Straight
Mating Pin Diameter	3 mm [.118 in]
Wire Contact Termination Area Plating Thickness	.81 – 3.175 μm [32 – 125 μin]
Wire Contact Termination Area Plating Material Finish	Bright
Contact Type	Socket
Contact Mating Area Plating Material	Tin



Wire Contact Termination Area Plating Material	Pre-Tin
Contact Retention Within Housing	With
Contact Base Material	Brass
Contact Current Rating (Max)	15 A

### Electrical Characteristics

Operating Voltage	250 VAC
-------------------	---------

### Termination Features

Termination Method to Wire & Cable	Crimp
Product Terminates To	Wire & Cable

### Usage Conditions

Operating Temperature Range	-55 – 105 °C[-67 – 221 °F]
-----------------------------	----------------------------

### Operation/Application

Circuit Application	Power
---------------------	-------

## Product Compliance

[For compliance documentation, visit the product page on TE.com>](#)

EU RoHS Directive 2011/65/EU	Compliant
EU ELV Directive 2000/53/EC	Compliant
China RoHS 2 Directive MIIT Order No 32, 2016	No Restricted Materials Above Threshold
EU REACH Regulation (EC) No. 1907/2006	Current ECHA Candidate List: JUNE 2024 (241) Candidate List Declared Against: JUNE 2024 (241) Does not contain REACH SVHC
Halogen Content	Low Halogen - Br, Cl, F, I < 900 ppm per homogenous material. Also BFR/CFR/PVC Free
Solder Process Capability	Not applicable for solder process capability

#### Product Compliance Disclaimer

This information is provided based on reasonable inquiry of our suppliers and represents our current actual knowledge based on the information they provided. This information is subject to change. The part numbers that TE has identified as EU RoHS compliant have a maximum concentration of 0.1% by weight in homogenous materials for lead, hexavalent chromium, mercury, PBB, PBDE, DBP, BBP, DEHP, DIBP, and 0.01% for cadmium, or qualify for an exemption to these limits as defined in the Annexes of Directive 2011/65/EU (RoHS2). Finished electrical and electronic equipment products will be CE marked as required by Directive 2011/65/EU. Components may not be CE marked. Additionally, the part numbers that TE has identified as EU ELV compliant have a maximum concentration of 0.1% by weight in homogenous materials for lead, hexavalent chromium, and mercury, and 0.01% for cadmium, or qualify for an exemption to these limits as defined in the Annexes of Directive 2000/53/EC (ELV). Regarding the REACH Regulation, the information TE provides

on SVHC in articles for this part number is based on the latest European Chemicals Agency (ECHA) 'Guidance on requirements for substances in articles' posted at this URL: <https://echa.europa.eu/guidance-documents/guidance-on-reach>

## Compatible Parts



## Also in the Series | Commercial MATE-N-LOK

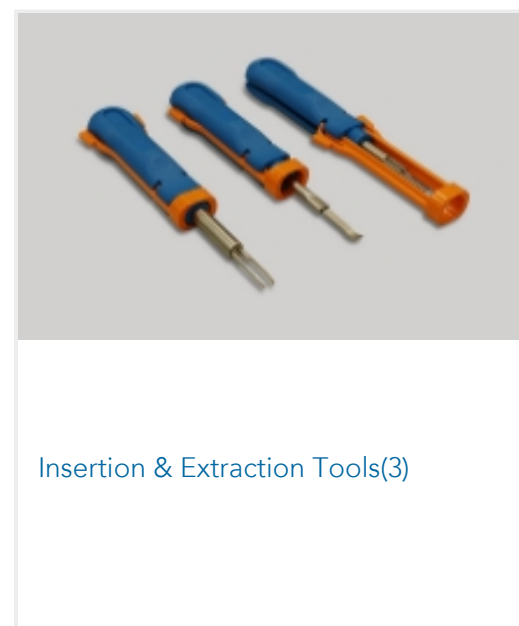
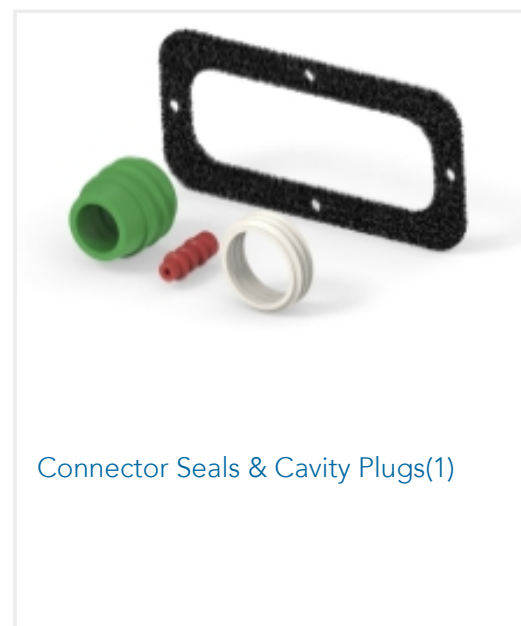
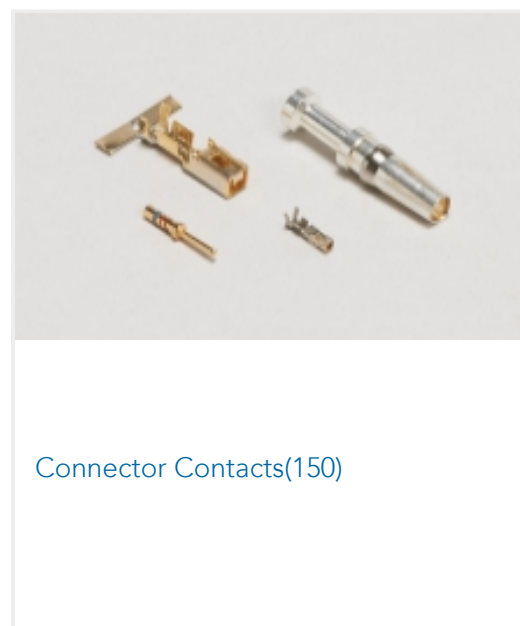

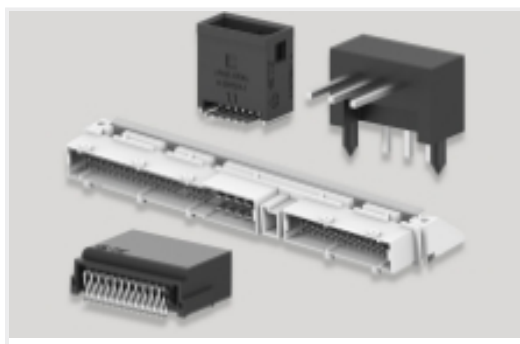

PCB Headers & Receptacles(56)



Power Contacts(146)



Rectangular Power Connectors(115)

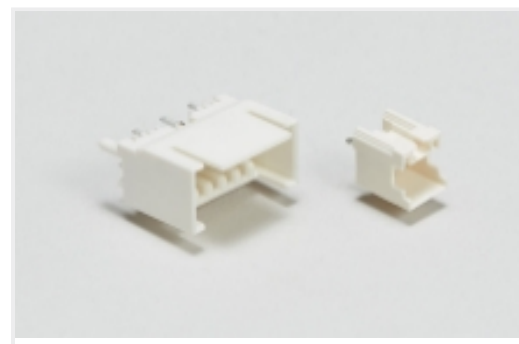

Wire-to-Board Headers & Receptacles (56)

## Customers Also Bought



TE Part #794275-1  
06P UMNL INTERFACE SEAL

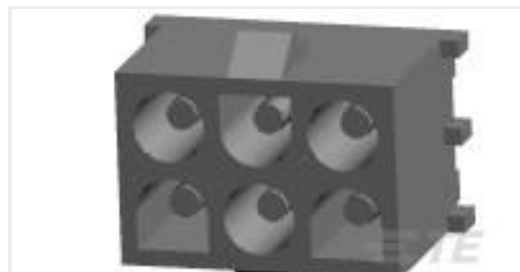

TE Part #350431-1  
06P UMNL PIN HDR ASSY V2 NAT



TE Part #1-480706-2  
09P UMNL PLUG HSG RED

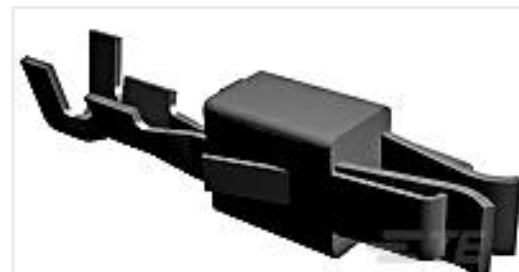

TE Part #927771-3  
JPT REC 2.8 Contact SRC Sn



TE Part #1-480708-2  
12P UMNL PLUG HSG RED



TE Part #350537-1  
UMNL SOK 20-14 .0126 PTPBR



TE Part #350712-1  
09P UMNL PIN HDR ASSY 94VO

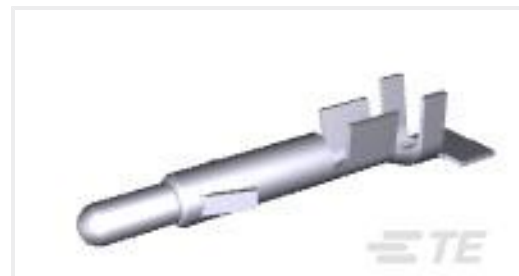

TE Part #926883-1  
UNIVERSAL M-N-L PIN

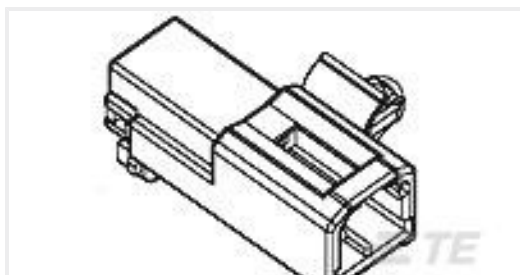

TE Part #178602-1  
070 MULTILOC CAP HSG PANEL LOC



TE Part #344089-1  
2W RECP. ANTI-BACKOUT

## Documents

### Product Drawings

[3 M/M LANCED SOCKET](#)

English

### CAD Files

[3D PDF](#)

3D

### Customer View Model

[ENG\\_CVM\\_CVM\\_153211-1\\_W.2d\\_dxf.zip](#)



English

**Customer View Model**

[ENG\\_CVM\\_CVM\\_153211-1\\_W.3d\\_igs.zip](#)

English

**Customer View Model**

[ENG\\_CVM\\_CVM\\_153211-1\\_W.3d\\_stp.zip](#)

English

By downloading the CAD file I accept and agree to the [Terms and Conditions](#) of use.

**Product Specifications**

[Application Specification](#)

English