

Single Row

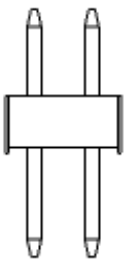

Double Row

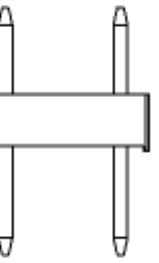

Jump Middle Row

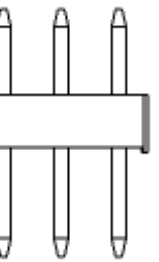

Triple Row

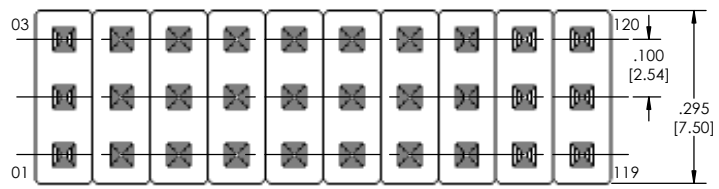
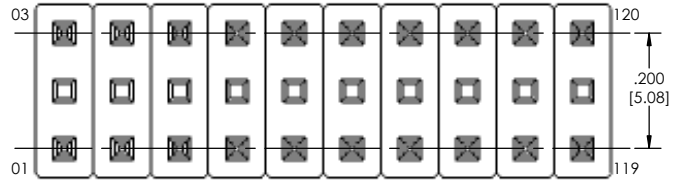
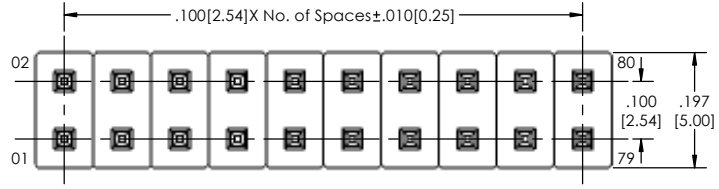
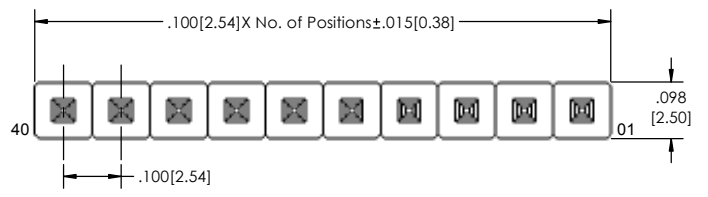

APPLICATION

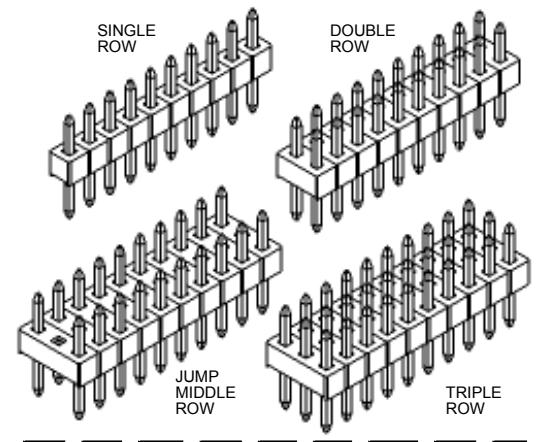
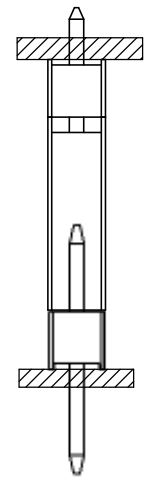

TSHS-1 **XX** - **X** - **XX** - **X** - **XX** - **XX** - **XXX** - **X** - **LF**
(A) (B) (C) (D) (E) (F) (G) (H) (I)

- A. Pins Per Row - 1 through 40
- B. Row Specification
 - S= Single Row
 - D= Double Row
 - J= Jump Middle Row
 - T= Triple Row
- C. Pin Options - See Pin Options below
- D. Post Height
 - A= .230 [5.84]
 - B= .318 [8.08]
- E. Plating Options - See Plating Options below
- F. Lock Tight "LT" (Optional)
 - LT= Board locking feature.
 - Leave blank if not needed.
- G. Polarized Position (Optional)
 - Leave blank if not needed
 - If required, specify position to be empty
 - e.g. .012 for pin 12
- H. Every Other Pin (Optional)
 - Leave blank if not needed
- I. Lead Free

Mates With:
BCSS SMBC
BSSH SSHQ
BSSHC SSHQR
BSSQ SSHR
BSSQC SSHS
BSSQM SSHSM
LBCSS
LSMBC
LSWSS

Plating options	
G	-10µ Gold on Contact Area/ Flash on Tail
T	-Matte Tin all Over
GT	-10µ Gold on Contact Area/ Matte Tin on Tail
H	-30µ Gold on Contact Area/ Matte Tin on Tail
F	-Gold Flash over Entire Pin
FT	-Gold Flash on Contact Area/ Matte Tin on Tail

Specifications:
Current Rating: 3.0 Ampere
Insulation Resistance: 1000M Ohms Min.
Dielectric Withstanding: 600V AC
Contact Resistance: 20M Ohms Max.
Operation Temperature: -40°C to +105°C
Max. Process Temperature
Peak: 260°C up to 20 secs.
Process: 230°C up to 60 secs.
Wave: 260°C up to 6 secs.
Manual Solder: 350°C up to 5 secs.

Materials:
Contact Material: Phosphor Bronze
Insulator Material: Nylon 6T
Plating: Au or SN over 50µ" (1.27) Ni

Pin Options			
Length	Tail with .230 Post	Tail with .318 Post	
.430 [10.92mm]	.100 [2.54mm]	N/A	06
.445 [11.30mm]	.115 [2.92mm]	N/A	08
.456 [11.58mm]	.126 [3.20mm]	N/A	10
.480 [12.19mm]	.150 [3.81mm]	N/A	11
.530 [13.46mm]	.200 [5.08mm]	.112 [2.84mm]	14
.630 [16.00mm]	.300 [7.62mm]	.212 [5.38mm]	16
.730 [18.54mm]	.400 [10.16mm]	.312 [7.92mm]	20
.830 [21.08mm]	.500 [12.70mm]	.412 [10.46mm]	22
.930 [23.62mm]	.600 [15.24mm]	.512 [13.00mm]	24
1.030 [26.16mm]	.700 [17.78mm]	.612 [15.54mm]	26
1.130 [28.70mm]	.800 [20.32mm]	.712 [18.08mm]	28
1.230 [31.24mm]	.900 [22.86mm]	.812 [20.62mm]	30
1.330 [33.78mm]	1.000 [25.40mm]	.912 [23.16mm]	32
1.430 [36.32mm]	1.100 [27.94mm]	1.012 [25.70mm]	34
1.530 [38.86mm]	1.200 [30.48mm]	1.112 [28.25mm]	36

Tails may be clipped to achieve specific dimensions.
Products cut to specific sizes are uncancelable/ nonreturnable.
Parts are subject to change without notice.



PROPRIETARY AND CONFIDENTIAL
THE INFORMATION CONTAINED IN THIS DRAWING IS THE SOLE PROPERTY OF Major League Electronics. ANY REPRODUCTION IN PART OR AS A WHOLE WITHOUT THE WRITTEN PERMISSION OF Major League Electronics IS PROHIBITED.

UNLESS OTHERWISE SPECIFIED:		COMMENTS:	
DRAWN	EOW	NAME	DATE
CHECKED	GWE		01/06/14
ENG APPR.			
MFG APPR.			
NEXT ASSY USED ON		FINISH	
APPLICATION		DO NOT SCALE DRAWING	

4233 Earnings Way
New Albany, IN 47150
Phone: 812.944.7244 Fax: 812.944.7268
E-Mail: ml@majorleagueelectronics.com

TITLE: TSHS-1 SERIES
SIZE DWG. NO. **C** REV **A**
SCALE 6:1 SHEET 1 OF 1