



RAYCHEM

TE Internal #: 804495-000

Rectangular Connector Housings, Wire-to-Wire, Aluminum, Plug, Pin / Socket, Wire & Cable, Panel Mount, -85 – 257 °F [-65 – 150 °C]

[View on TE.com >](#)

Connectors > Rectangular Connectors > Rectangular Connector Housings

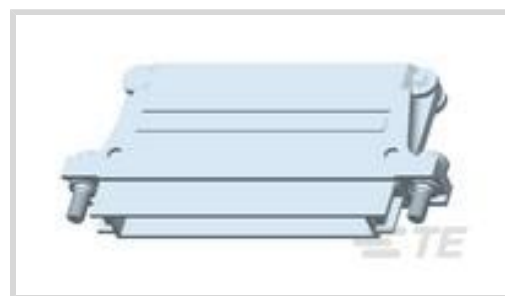

Connector System: **Wire-to-Wire**

Housing Material: **Aluminum**

Connector & Housing Type: **Plug**

Contact Type: **Pin, Socket**

Connector & Contact Terminates To: **Wire & Cable**

Features

Product Type Features

Connector System	Wire-to-Wire
Connector & Housing Type	Plug
Connector & Contact Terminates To	Wire & Cable

Contact Features

Contact Current Rating (Max)	1.5 A
Contact Type	Pin, Socket

Mechanical Attachment

Connector Mounting Type	Panel Mount
-------------------------	-------------

Housing Features

Housing Material	Aluminum
------------------	----------

Usage Conditions

Operating Temperature Range	-65 – 150 °C[-85 – 257 °F]
-----------------------------	----------------------------

Product Compliance

[For compliance documentation, visit the product page on TE.com>](#)

EU RoHS Directive 2011/65/EU	Not Compliant
EU ELV Directive 2000/53/EC	Not Compliant
China RoHS 2 Directive MIIT Order No 32, 2016	Restricted Materials Above Threshold



EU REACH Regulation (EC) No. 1907/2006

Current ECHA Candidate List: JUNE 2024
(241)

Candidate List Declared Against: JAN 2024
(240)

SVHC > Threshold:

Cd (3.7% in Shell and hardware)

Article Safe Usage Statements:

Use personal protective equipment as required. Do not eat, drink or smoke when using this product. Recycle if possible and dispose of the article by following all applicable governmental regulations relevant to your geographic location.

Halogen Content

Not Yet Reviewed for halogen content

Solder Process Capability

Not applicable for solder process capability

Product Compliance Disclaimer

This information is provided based on reasonable inquiry of our suppliers and represents our current actual knowledge based on the information they provided. This information is subject to change. The part numbers that TE has identified as EU RoHS compliant have a maximum concentration of 0.1% by weight in homogenous materials for lead, hexavalent chromium, mercury, PBB, PBDE, DBP, BBP, DEHP, DIBP, and 0.01% for cadmium, or qualify for an exemption to these limits as defined in the Annexes of Directive 2011/65/EU (RoHS2). Finished electrical and electronic equipment products will be CE marked as required by Directive 2011/65/EU. Components may not be CE marked. Additionally, the part numbers that TE has identified as EU ELV compliant have a maximum concentration of 0.1% by weight in homogenous materials for lead, hexavalent chromium, and mercury, and 0.01% for cadmium, or qualify for an exemption to these limits as defined in the Annexes of Directive 2000/53/EC (ELV). Regarding the REACH Regulation, the information TE provides on SVHC in articles for this part number is based on the latest European Chemicals Agency (ECHA) 'Guidance on requirements for substances in articles' posted at this URL: <https://echa.europa.eu/guidance-documents/guidance-on-reach>

Customers Also Bought

TE Part #699232-000
MTCB1X-XXX-106

TE Part #699226-000
MTCB1X-106-XXX

TE Part #364283-000
MTCC1P-010-010-01

TE Part #699219-000
MTCB2X-XXX-205

TE Part #699220-000
MTCB2X-XXX-206

TE Part #489007-000
MTCC1R-COAX-01S-01

TE Part #699301-000
MTCX1X-100-100

TE Part #830147-000
MTCC1P-COAX-01S-01

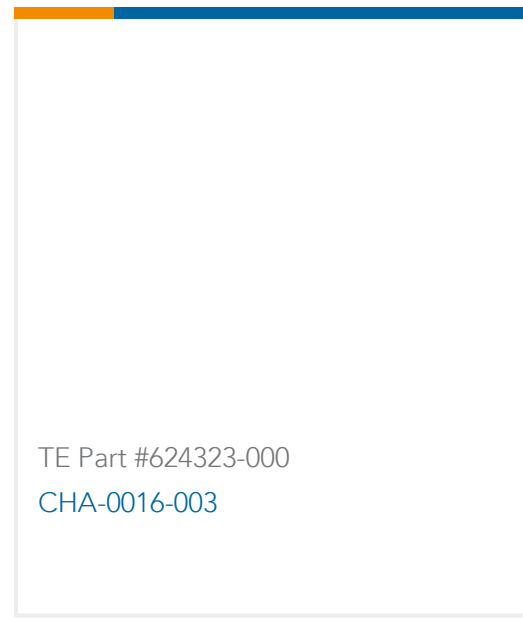
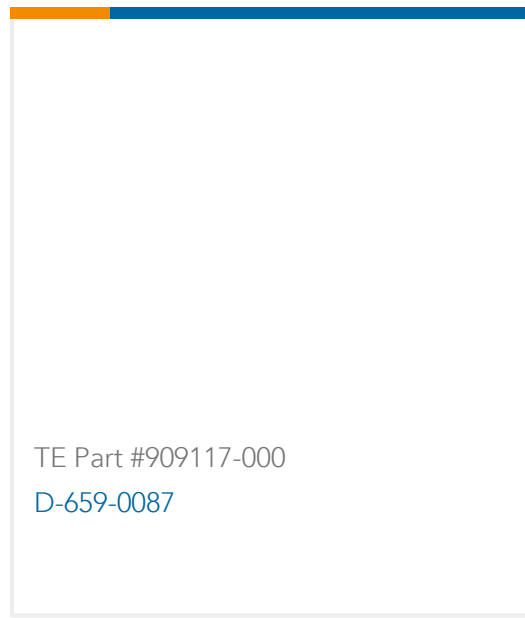

Documents

Product Drawings

[MTCC2P-020-020-01](#)

English

CAD Files

[3D PDF](#)

3D

Customer View Model

[ENG_CVM_CVM_804495-000_O_c-804495-000-o.2d_dxf.zip](#)

English

Customer View Model

[ENG_CVM_CVM_804495-000_O_c-804495-000-o.3d_igs.zip](#)

English

Customer View Model

[ENG_CVM_CVM_804495-000_O_c-804495-000-o.3d_stp.zip](#)

English

By downloading the CAD file I accept and agree to the [Terms and Conditions](#) of use.

Product Specifications

[MTC Connectors with Fixed Contacts](#)

English