

| REVISIONS | | | | |
|-----------|-----|------------------|-------------|-------------|
| REV | ECO | DESCRIPTION | DATE | BY APPR |
| B1 | - | RELEASED DRAWING | JAN-18-2014 | ARROW TOMMY |

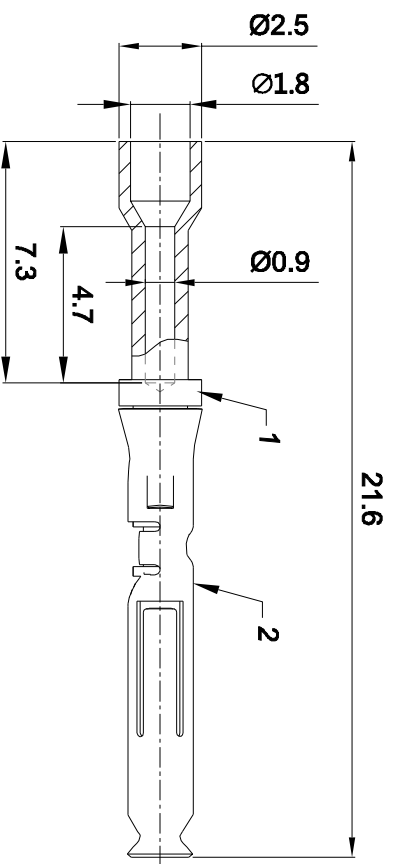

- NOTES : (UNLESS OTHERWISE SPECIFIED)
- MATERIAL :
 - CONTACT BODY : COPPER ALLOY.
 - POSITIONING CLIP : STAINLESS STEEL.
 - SPECIFICATIONS :
 - CURRENT RATING : 7.5A(MAX).
 - TERMINATION TYPE : CRIMPING.
 - CRIMP WIRE RANGE : 26~24AWG.
 - SUITABLE SOCKET TYPE : MP24W23XX.
 - ROHS COMPLIANT.
 - ALL DIMENSION ARE FOR REFERENCE USE ONLY.

| P/N | CONTACT PLATING(MATING AREA) |
|------------|--------------------------------|
| MS24W23F | GOLD FLASH PLATING OVER NICKEL |
| MS24W23G10 | 10µ" GOLD PLATING OVER NICKEL. |
| MS24W23G15 | 15µ" GOLD PLATING OVER NICKEL. |
| MS24W23G30 | 30µ" GOLD PLATING OVER NICKEL. |

| QUANTITY | PART NUMBER | DESCRIPTION | ITER |
|-----------------------|-------------|-------------|------|
| MATERIALS LIST | | | |

| | | | |
|---|--|---|----------------|
| UNLESS OTHERWISE SPECIFIED 1) ALL DIMENSIONS ARE IN MILLIMETERS. 2) TOLERANCES ARE AS SHOWN: 1 PL, DEC 20 20 3 PL, DEC 20 20 3) Note reference = | SIGNATURES DRAWN: ARROW CHECKED: JMH/TZH ENGINEER: APPROVAL: | DATE JMH/TZH | SCALE NONE |
| PROCESS SPECIFICATIONS: NEXT ASST. | CUSTOMER: Eco-Mate Socket Contact Machine, 26-24AWG, Size 20 | THIS DRAWING IS SUPPLIED FOR SPECIFICATIONS AND PERFORMANCE DATA ONLY. THE DRAWING IS NOT TO BE USED FOR REPRODUCTION OR REPRODUCTION IN ANY MANNER. ALL MANUFACTURING VARIATIONS ARE ACCEPTED. | REVISION B1 |

Amphenol
Sine Systems - www.amphenol-sine.com
44724 Monkey Drive
Clinton Township, MI 48038