

GROOVE		ACCOMMODATES	
SYMBOLS ON CRIMPING GROOVE	SPOT COLOR CODING ON SIDE OF NEST DIE	CONNECTORS	CONDUCTORS COMM. - U.L.
0	RED	YAEV18,	22-18
0 0	BLUE	YAEV14, YAEV14-T5, YAEV14-T2,	18-14
NONE	YELLOW	YAEV10, YAEV10-T7, YAEV10-T11, YAEV10-T26, YAEV10-T3, YAEV10-T2, YAEV10-T4,	12-10

GROOVE	"G" DIM BARREL	INSPECTION GAGE
22-18	.085/.099	PG348-1
18-14	.116/.130	PG347-1
12-10	.128/.142	PG346-1

REV.	DATE	DESCRIPTION	ECO	BY	C'H'K.
A	01/19/2012 00:00:00 AM	REDARWN INTO PROE	26507	MG	JG

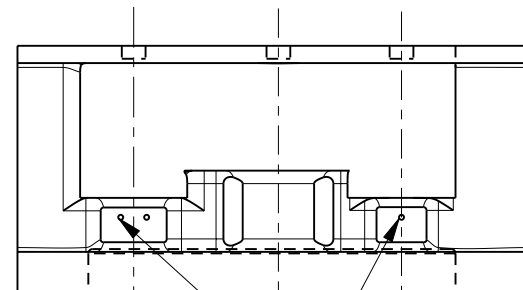

VIEW U-U
SYMBOLS ARE IMPRESSED ON NYLON OF INSULUGS. (AS SHOWN)

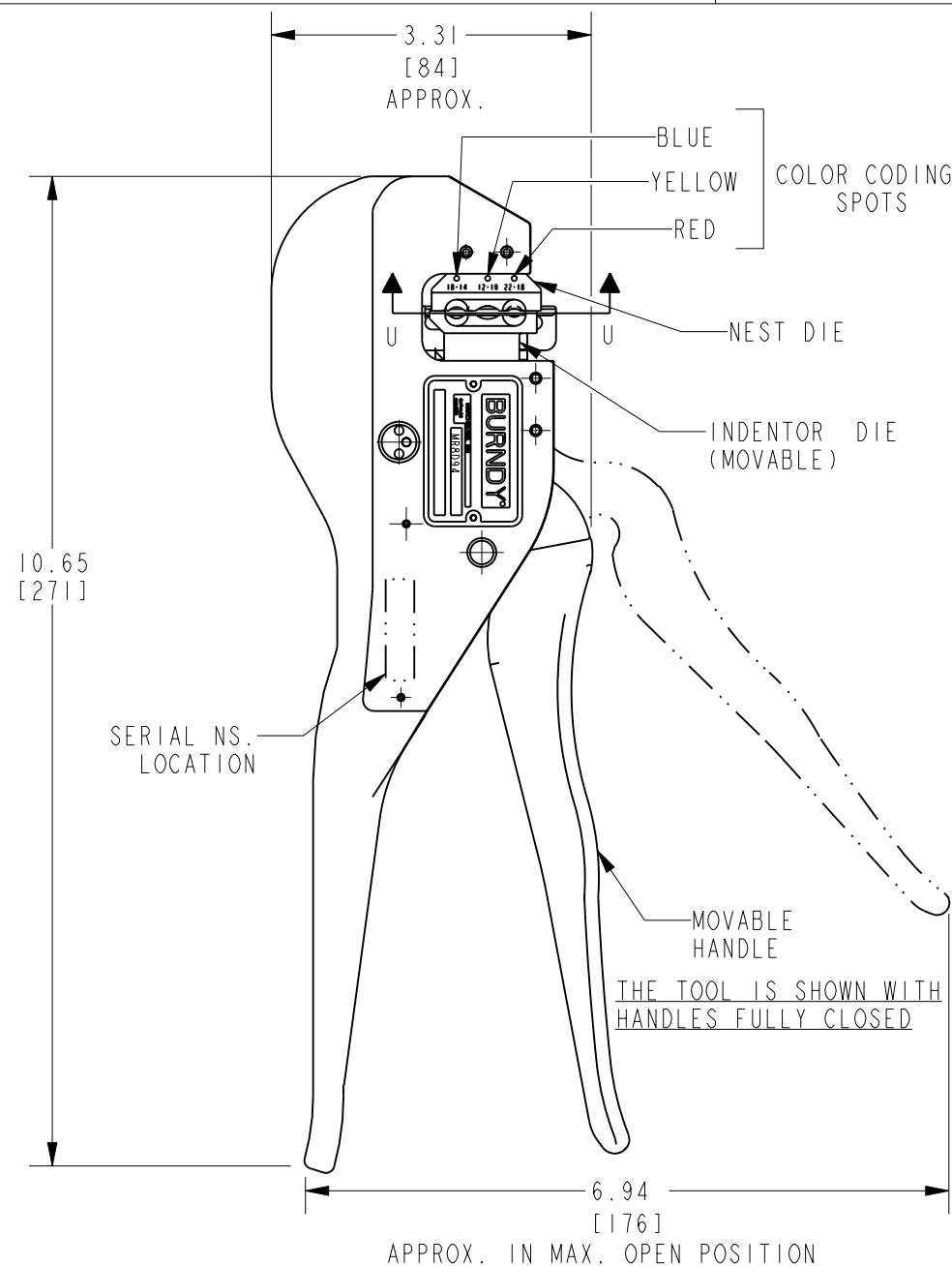

VIEW SHOWING HYTOOL WITH HANDLES FULLY OPENED

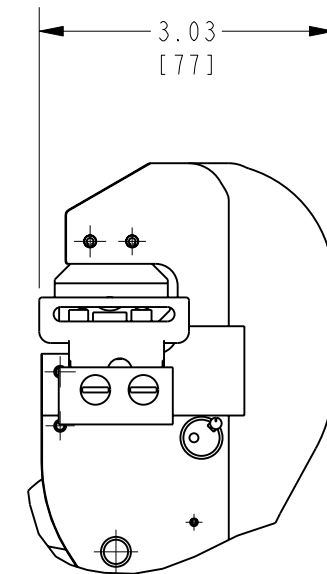
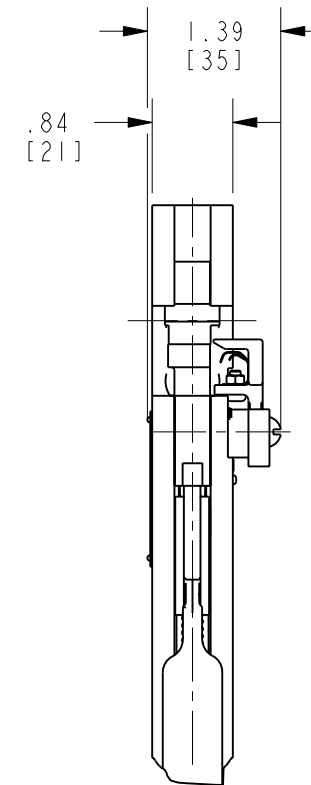

NOTES:

- MATERIAL:
CAST ALUMINUM BODY, OTHER PARTS ALLOY STEEL.
- DIMENSIONS IN BRACKETS [] DENOTES METRIC UNITS [SI UNITS] AND ARE ROUNDED TO THE NEAREST WHOLE NUMBER. UNLESS OTHERWISE SPECIFIED THESE UNITS SHALL BE USED FOR REFERENCE ONLY.
- WITH NO CONNECTOR IN TOOL, A FORCE OF 15 TO 25 LBS APPLIED ONE INCH FROM ENDS OF HANDLES IS NECESSARY TO RELEASE RATCHET.
- THE INTERNAL RATCHET MECHANISM PERMITS HYTOOL TO BE OPENED ONLY AFTER INDENTATION IS COMPLETED.

TO ORDER BURNDY® PRODUCTS CALL		HYTOOL	
UNITED STATES: 1-800-346-4175 (LONDONDERRY, NH)		ITEM NO: 911750	CAT. NO: MR8D94
CANADA: 1-800-361-6975 (QUEBEC) 1-800-387-6487 (ALL OTHER PROVINCES)		DRAWN BY: M GOWRISANKAR 01/19/12	CHECKER: --
FOR PRODUCT INFO: http://www.burndy.com		DSN APPVL: --	MFG APPVL: --
		QA APPVL: --	MKT APPVL: --
		PROD FAM: --	SCALE: 1:1
		PROJECT #: --	DRAWING NO
		DOCUMENT TYPE: Sales	REV
		REL LEVEL: Released	
		SIZE B	SD076756-01
			SHEET 1 OF 1
			A

REV: PE0200