

## MPC1040LR45C

Aliases (UPIA1040LR45C0)

Not for New Design

KEMET, MPC, Metal Composite, 20%, 450 nH, 4539

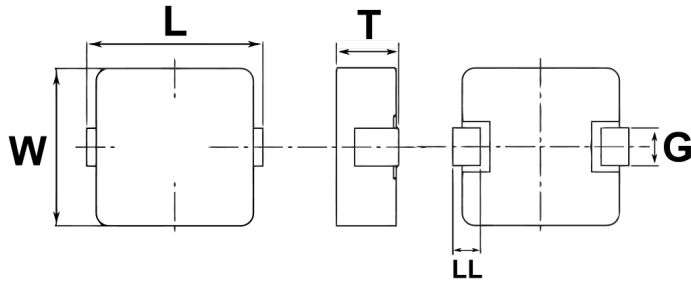

Click [here](#) for the 3D model.

### Dimensions

Chip Size	4539
L	11.5mm MAX
W	10mm +/-0.3mm
T	4mm MAX
G	3.5mm +/-0.5mm

### Packaging Specifications

Packaging	T&R, 330mm
Packaging Quantity	500

### General Information

Series	MPC
Style	SMD Molded
Core	Metal Composite
Description	Shielded, Surface Mount Inductor
Features	High Speed, Large Current DC/DC Converter
RoHS	Yes

### Specifications

Inductance	450 nH
Inductance Tolerance	20%
Temperature Range	-40/+125°C
Rated Temperature	120°C
Shielded	true
Current	27 Amps (Isat, 20% Drop In Inductance), 25 Amps (Irms, 40C Rise By Self Heating)
DC Resistance	1.1 mOhms

Statements of suitability for certain applications are based on our knowledge of typical operating conditions for such applications, but are not intended to constitute - and we specifically disclaim - any warranty concerning suitability for a specific customer application or use. This information is intended for use only by customers who have the requisite experience and capability to determine the correct products for their application. Any technical advice inferred from this information or otherwise provided by us with reference to the use of our products is given gratis, and we assume no obligation or liability for the advice given or results obtained.