

Part No.	MBP34R1350C100A
Date	2017.03.21

Written	Checked	Approved
Y.S.J	J.Y.KIM	

1. Electrical Specifications.

ITEM	Specifications
Center Frequency	1350 MHz
Pass-Bandwidth(BW)	$f_c \pm 50$ MHz (1300 ~ 1400 MHz)
Insertion Loss in BW	1.5 dB max.
Ripple in BW	0.7 dB max.
V.S.W.R in BW	1.7 max.
In/Out Impedance	50 Ω
Maximum Power	2 W max.
Operation Temperature	-40°C ~ +85°C
Attenuation	25dB Min. @ Fc \pm 150MHz
	40 dB min . @ 900 MHz
	30 dB min .@ 1900 MHz
	TBD @ 1850 ~ 6000 MHz

2. Dimensions.

Top View

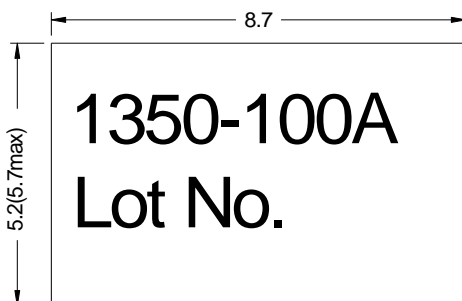

Bottom View

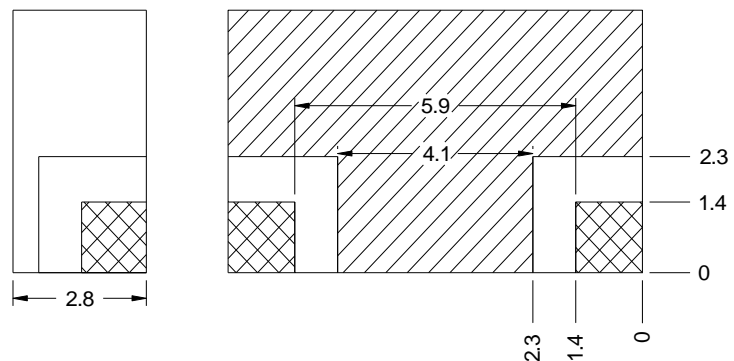

Tolerance Unless
Otherwise Specified: ± 0.2

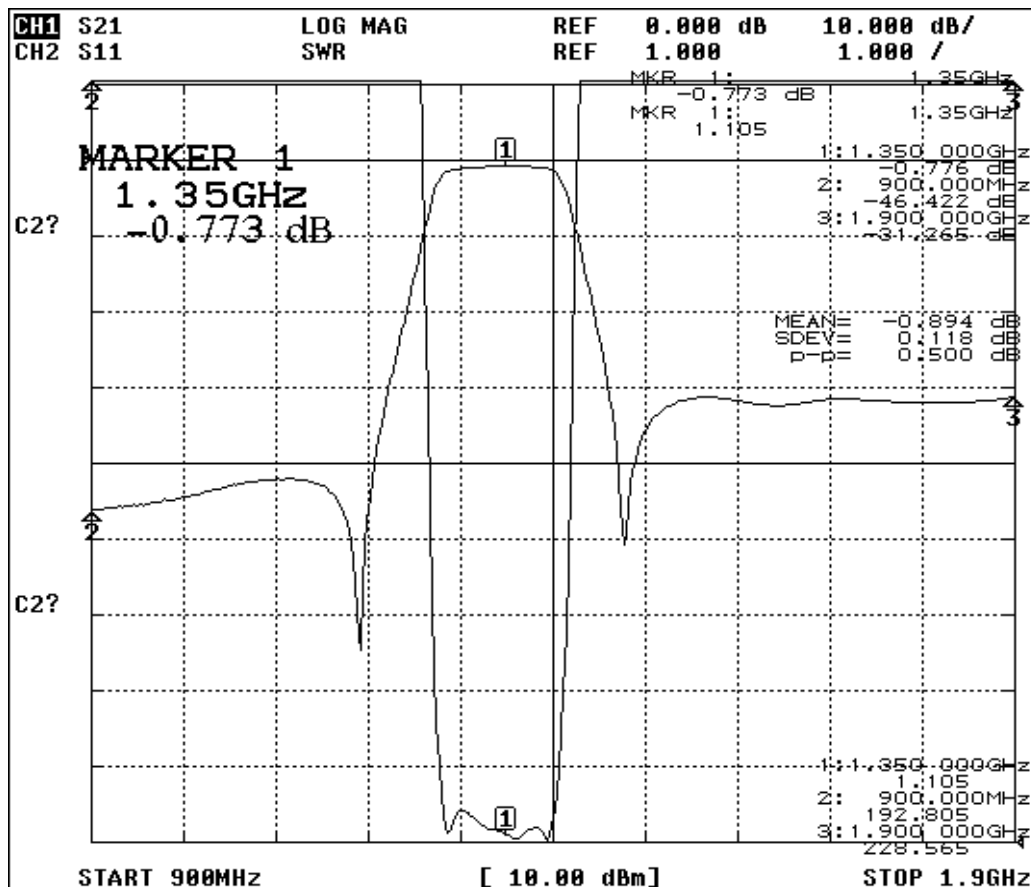
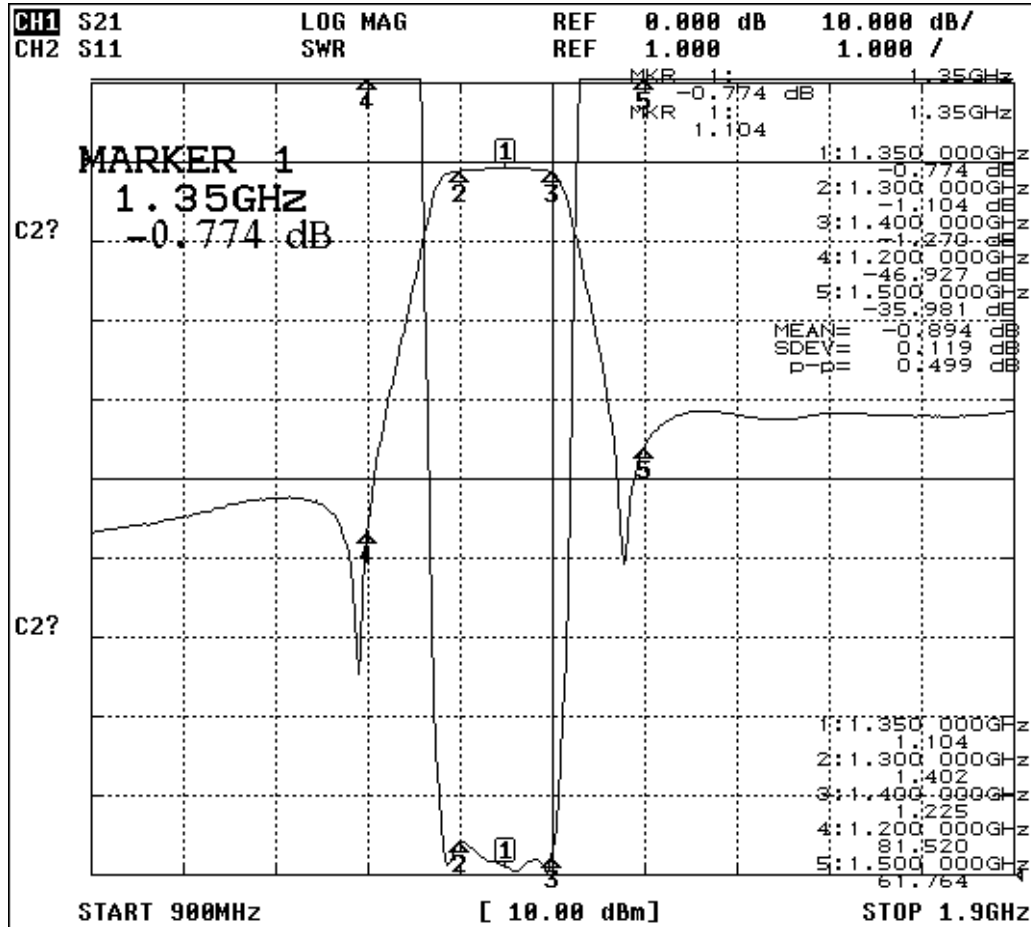

- In/Out Put
- GND

3.GRAPH

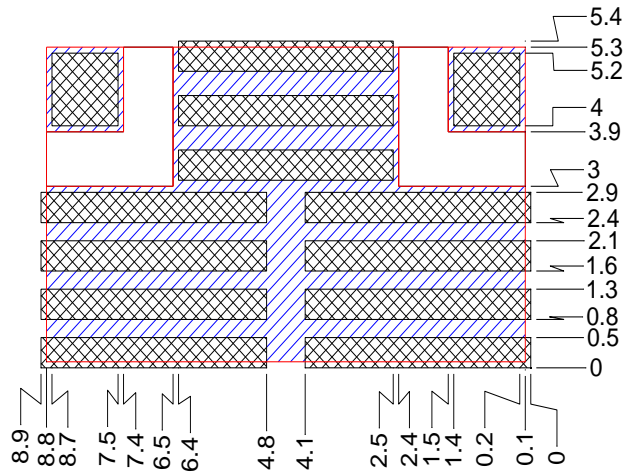

4. FOOTPRINT



-  Filter outline
 -  Exposed conductor
 -  Solder resist over dielectric
- Dimension unit : mm

5. PACKAGING

SPQ: 1,000pcs

