

Datamate Connectors

Male Vertical PC Tail

- ❖ Customer defined contact configurations.
- ❖ Jackscrews are assembled where specified.
- ❖ Special contacts are assembled where specified.
- ❖ For loose special contacts see pages 43 and 47.
- ❖ Fully shrouded contacts.
- ❖ Polarised mouldings.
- ❖ Mates with connectors shown on pages 41 and 42.



NON-SYMMETRICAL CONTACT CONFIGURATION

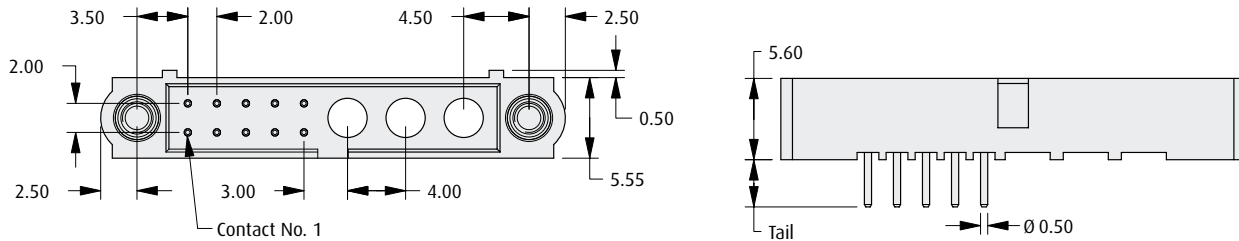

EXAMPLE OF PART NUMBER **M80-5TX10XXXX-00-000-03-XXX**

SYMMETRICAL CONTACT CONFIGURATION

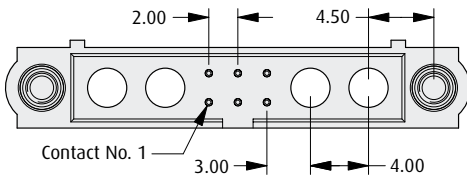

EXAMPLE OF PART NUMBER **M80-5TX06XXXX-02-XXX-02-XXX**

SPECIAL CONTACTS ONLY

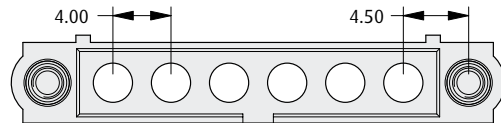

EXAMPLE OF PART NUMBER **M80-5000000XX-06-XXX-00-000**

WITH JACKSCREWS

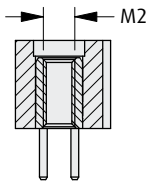

TAIL LENGTH	SERIES CODE
3mm	M80-5T1XXXXM1
4.5mm	M80-5T2XXXXM1

NO JACKSCREWS

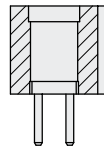

TAIL LENGTH	SERIES CODE
3mm	M80-5T1XXXX00
4.5mm	M80-5T2XXXX00

WITH BOARD-MOUNT JACKSCREWS

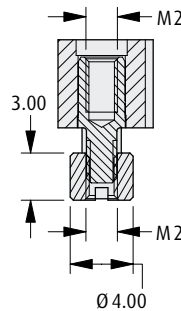

TAIL LENGTH	STUD LENGTH	SERIES CODE
3mm	3.5mm	M80-5T1XXXXM2
3mm	5.0mm	M80-5T1XXXXM3
4.5mm	3.5mm	M80-5T2XXXXM2
4.5mm	5.0mm	M80-5T2XXXXM3

All dimensions in mm.

www.harwin.com

