

DASH NO.	M CODE	MADE FROM
----------	--------	-----------

GSD

M39012/26-0101

REVISIONS	
ISSUE	CHANGES
0	ER 33572 KH 12/06/91
1	CN 34075 A MJB 08/07/92
2	CN 34762 D KH 06/29/93

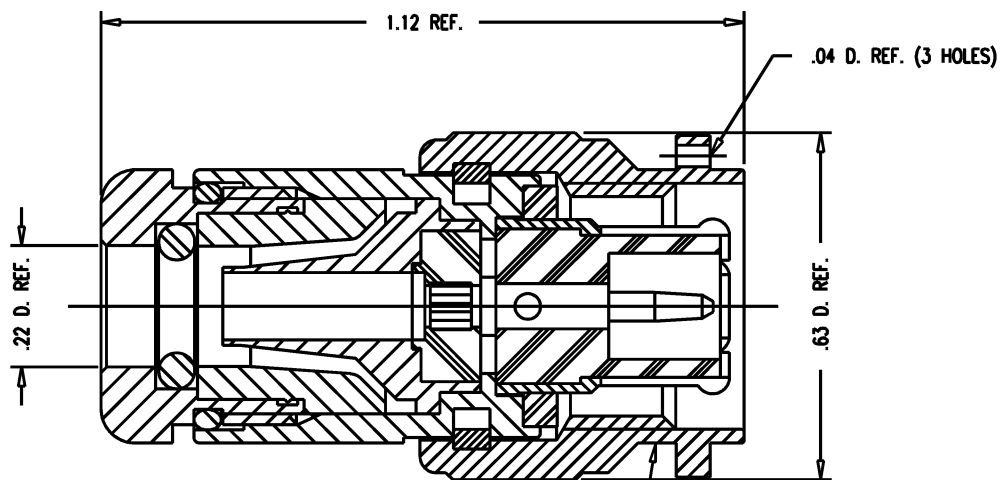

STAMP: 91836 M39012/26-0101
125-67-5 XX XX
DATE CODE

NOTES:

- FOR USE WITH M17/028-RG058, /084-RG223, /128-RG400 & /060-RG142 CABLE.
- FOR CABLING INSTRUCTIONS SEE 3-526
- INTERFACE PER MIL-STD-348, FIG. 313-1.
- MATERIALS:
INSULATORS: TEFLON, ASTM-D-1457
GASKET & O-RINGS: SIL. RUB., Z2-R-765
C-RING: PHOS. BRONZE, QQ-B-750
OUTER CONTACT: BER. COP., ASTM-B-196
ALL OTHER PARTS: BRASS, QQ-B-626
- FINISHES:
CENTER CONTACT: HARD GOLD PLT. PER MIL-G-45204
ALL OTHER METAL PARTS: SILVER PLT. PER QQ-S-365
- ELECTRICAL CHARACTERISTICS:
NOMINAL IMPEDANCE: 50 OHMS
VOLTAGE RATING: 500 VRMS
FREQUENCY RANGE: DC TO 11 GHz

125-67-5 JCA0865

SCALE	4:1	
APPROX SURFACE AREA		
WAS:	E-16101	
USED ON		
REF:		
PLUG, TNC, W/P TAPER GRIP		
DRAWN	JCA	DATE 09/11/90
DESIGN	MJB	DATE 09/12/90
APPR.		DATE

KINGS
ELECTRONICS CO., INC.
TUCKAHOE, NEW YORK 10707

M39012/26-0101

GSD