

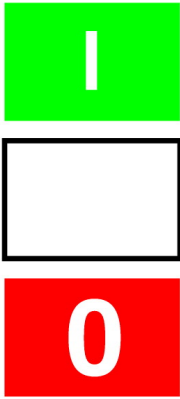



Double actuator pushbutton, 1N/O+1N/C, + LED 85-264VAC, screw connection

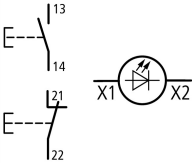

Part no. M22-DDL-GR-X1/X0/K11/230-W
Article no. 216509
Catalog No. M22-DDLGR-X1X0K11QWQ

Delivery programme

| | | |
|---|----|--|
| Product range | | RMQ-Titan (drilling dimensions 22.5 mm) |
| Basic function | | Double actuators |
| Single unit/Complete unit | | Complete unit |
| Design | | Actuators and indicator lights non-flush momentary |
| Connection type | | Screw connection |
| Description | | White lens LED element 85 - 264 V AC |
| Colour | | Green, red |
| Button plate | | green, red |
| button plate | | green, red |
| Button plate | |  |
| | | inscribed |
| Degree of Protection | | IP66 |
| Front ring | | Bezel: titanium |
| Connection to SmartWire-DT | | no |
| Contacts | | |
| N/C = Normally closed | | 1 NC  |
| N/O = Normally open | | 1 N/O |
| Notes | |  = safety function, by positive opening to IEC/EN 60947-5-1 |
| Actuator travel and actuation force as per DIN EN 60947-5-1, K.5.4.1 | | |
| | mm | 4.8 |
| Maximum travel | mm | 5.7 |
| Minimum force for positive opening | N | 15 |
| Contact sequence | |  |
| Front dimensions | | 29,7 x 54,7 |

Technical data

| | | |
|----------------|--|--------------|
| General | | |
| Standards | | IEC/EN 60947 |

| | | | |
|-----------------------------|--------------|---------------|--|
| | | | VDE 0660 |
| Lifespan, mechanical | Operations | $\times 10^6$ | > 1 |
| Operating frequency | Operations/h | |  1800 |
| Actuating force | n | |  5 |
| Climatic proofing | | | Damp heat, constant, to IEC 60068-2-78 Damp heat, cyclic, to IEC 60068-2-30 |
| Ambient temperature | | | |
| Open | °C | | -25 - +70 |
| Mounting position | | | As required |
| Mechanical shock resistance | g | | 30 Shock duration 11 ms Sinusoidal according to IEC 60068-2-27 |

Contacts

| | | | |
|---|----------------|----|---|
| Rated conditional short-circuit current | I _q | kA | 1 |
|---|----------------|----|---|

Design verification as per IEC/EN 61439

| | | | |
|--|-------------------|----|--|
| Technical data for design verification | | | |
| Rated operational current for specified heat dissipation | I _n | A | 6 |
| Heat dissipation per pole, current-dependent | P _{vid} | W | 0.11 |
| Equipment heat dissipation, current-dependent | P _{vid} | W | 0 |
| Static heat dissipation, non-current-dependent | P _{vs} | W | 1 |
| Heat dissipation capacity | P _{diss} | W | 0 |
| Operating ambient temperature min. | | °C | -25 |
| Operating ambient temperature max. | | °C | 70 |
| IEC/EN 61439 design verification | | | |
| 10.2 Strength of materials and parts | | | |
| 10.2.2 Corrosion resistance | | | Meets the product standard's requirements. |
| 10.2.3 Verification of thermal stability of enclosures | | | |
| 10.2.3.1 Verification of resistance of insulating materials to normal heat | | | Meets the product standard's requirements. |
| 10.2.3.2 Verification of resistance of insulating materials to abnormal heat and fire due to internal electric effects | | | Meets the product standard's requirements. |
| 10.2.3.3 Verification of resistance of insulating materials to abnormal heat and fire due to internal electric effects | | | Meets the product standard's requirements. |
| 10.2.4 Resistance to ultra-violet (UV) radiation | | | Please enquire |
| 10.2.5 Lifting | | | Does not apply, since the entire switchgear needs to be evaluated. |
| 10.2.6 Mechanical impact | | | Does not apply, since the entire switchgear needs to be evaluated. |
| 10.2.7 Inscriptions | | | Meets the product standard's requirements. |
| 10.3 Degree of protection of ASSEMBLIES | | | Does not apply, since the entire switchgear needs to be evaluated. |
| 10.4 Clearances and creepage distances | | | Meets the product standard's requirements. |
| 10.5 Protection against electric shock | | | Does not apply, since the entire switchgear needs to be evaluated. |
| 10.6 Incorporation of switching devices and components | | | Does not apply, since the entire switchgear needs to be evaluated. |
| 10.7 Internal electrical circuits and connections | | | Is the panel builder's responsibility. |
| 10.8 Connections for external conductors | | | Is the panel builder's responsibility. |
| 10.9 Insulation properties | | | |
| 10.9.2 Power-frequency electric strength | | | Is the panel builder's responsibility. |
| 10.9.3 Impulse withstand voltage | | | Is the panel builder's responsibility. |
| 10.9.4 Testing of enclosures made of insulating material | | | Is the panel builder's responsibility. |
| 10.10 Temperature rise | | | The panel builder is responsible for the temperature rise calculation. Eaton will provide heat dissipation data for the devices. |
| 10.11 Short-circuit rating | | | Is the panel builder's responsibility. The specifications for the switchgear must be observed. |
| 10.12 Electromagnetic compatibility | | | Is the panel builder's responsibility. The specifications for the switchgear must be observed. |
| 10.13 Mechanical function | | | The device meets the requirements, provided the information in the instruction leaflet (IL) is observed. |

Technical data ETIM 6.0

Low-voltage industrial components (EG000017) / Push button, complete (EC001028)

| | | | |
|---|--|----|------------------|
| Number of command positions | | | 2 |
| Colour button | | | Red-green |
| Construction type lens | | | Round |
| Hole diameter | | mm | 22 |
| Width opening | | mm | 22 |
| Height meter opening | | mm | 0 |
| Degree of protection (IP) | | | IP66 |
| Type of button | | | Flat |
| Suitable for illumination | | | Yes |
| Switching function latching | | | No |
| Spring-return | | | Yes |
| Supply voltage lamp | | V | 230 |
| Number of contacts as normally open contact | | | 1 |
| Number of contacts as normally closed contact | | | 1 |
| Number of contacts as change-over contact | | | 0 |
| Type of electric connection | | | Screw connection |
| With front ring | | | Yes |
| Material front ring | | | Plastic |
| Colour front ring | | | Chrome |

Approvals

| | | | |
|--|--|--|--|
| | | | IEC/EN 60947-5; UL 508; CSA-C22.2 No. 14-05; CSA-C22.2 No. 94-91; CE marking |
| | | | E29184 |
| | | | NKCR |
| | | | 012528 |
| | | | 3211-03 |
| | | | UL listed, CSA certified |
| | | | UL/CSA Type 3R, 4X, 12, 13 |

Dimensions

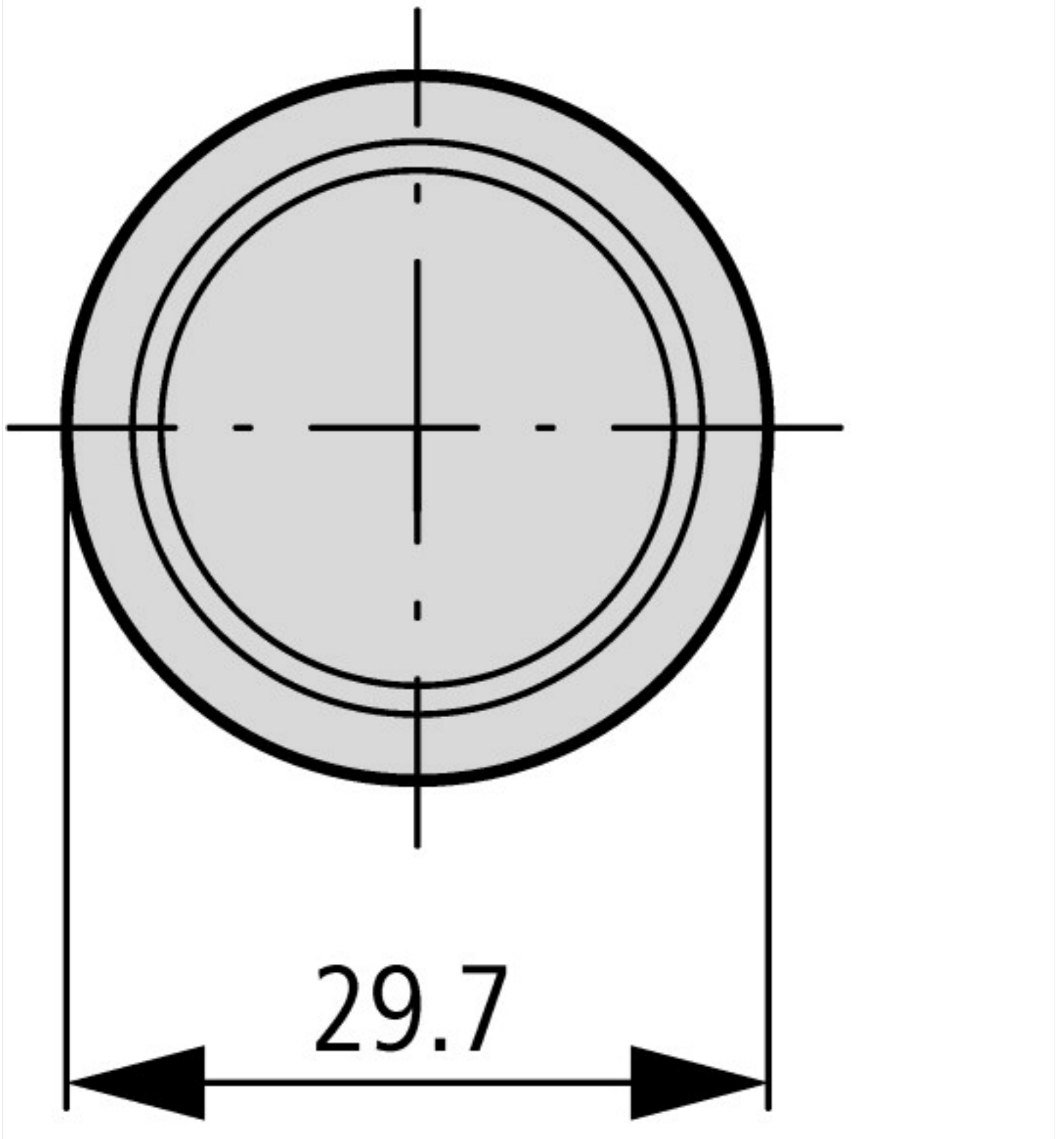

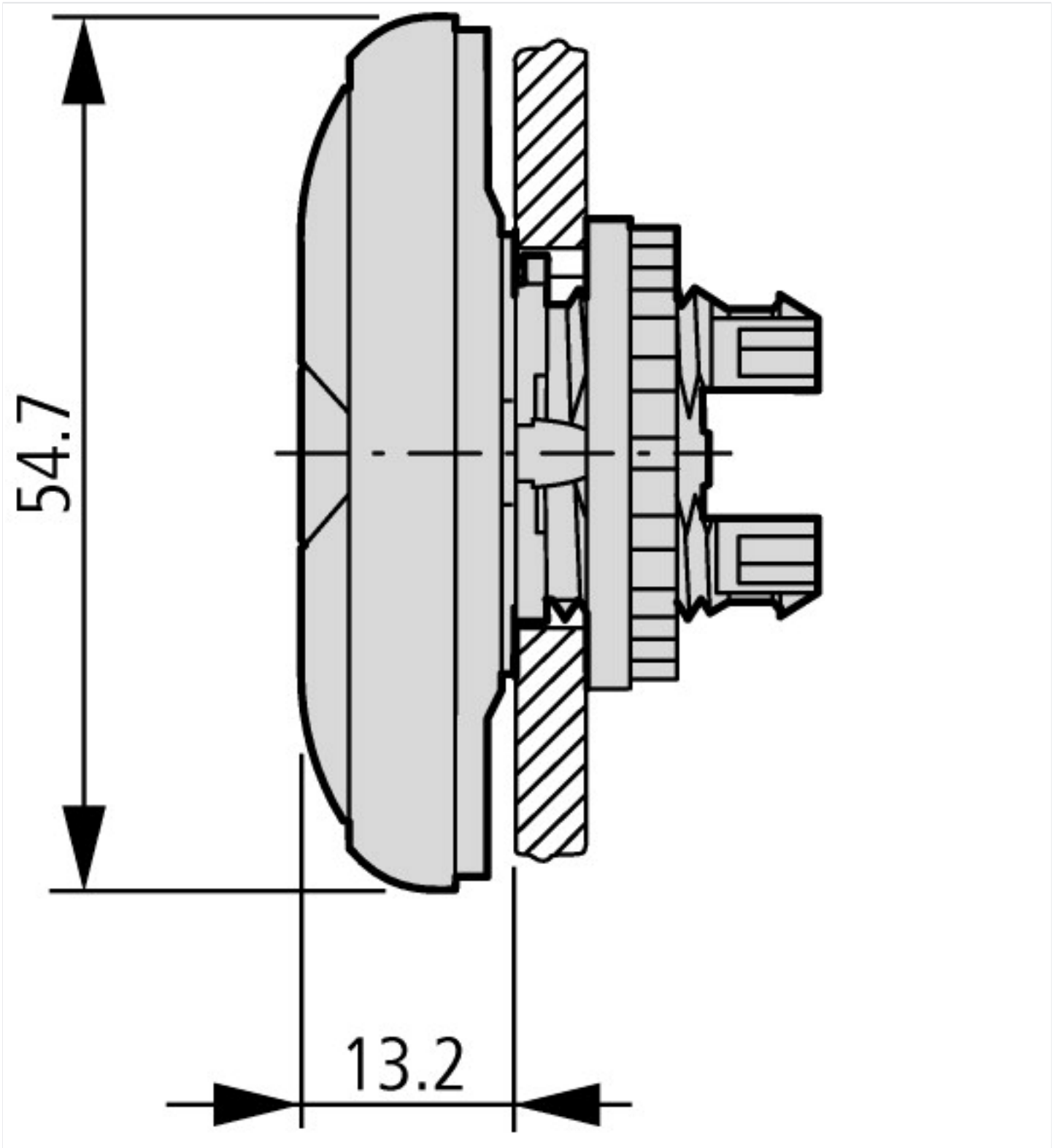

Additional product information (links)

IL04716002Z (AWA1160-1745) RMQ-Titan System

IL04716002Z (AWA1160-1745) RMQ-Titan System

ftp://ftp.moeller.net/DOCUMENTATION/AWA_INSTRUCTIONS/IL04716002Z2015_02.pdf