

THIS DOCUMENT IS SUBJECT TO CHANGE WITHOUT NOTICE. IT IS CONFIDENTIAL AND A PROPERTY OF Amphenol LTW. DISCLOSURE TO THIRD PARTY HAS TO BE AUTHORIZED BY Amphenol LTW.

| REV. | ECN NO. | DATE | SIGN | DESCRIPTION |
|------|---------|------------|---------------|------------------|
| A | | 2020/09/09 | Vincent Huang | New Release |
| B | C201465 | 2020/09/18 | Vincent Huang | $\triangle B$ X3 |
| C | C210542 | 2021/04/12 | Ruru | $\triangle C$ X1 |

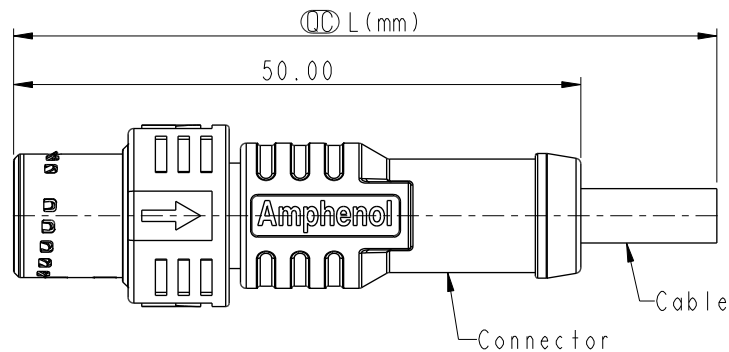
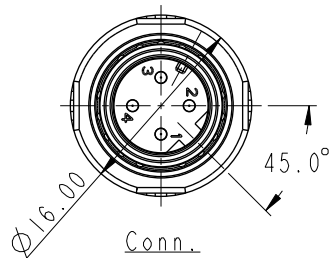

MI2D- XX BMMM-PL8D XX

XX: No. of Pin

XX: 01~99Meters
 01: 01Meter
 02: 02Meters
 :
 99: 99Meters

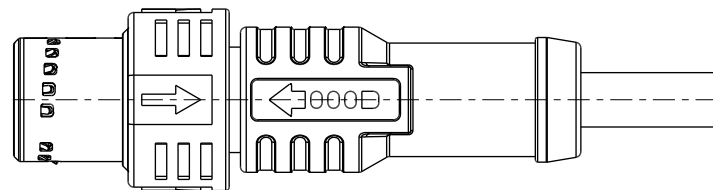
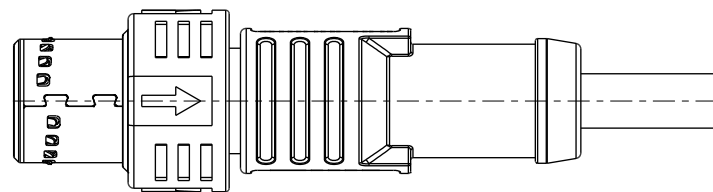

Note: $\triangle B$ $\triangle C$

- * RoHS Compliant
- * \odot Important dimension
- * Waterproof rate: IPX8, mated 1m/24h
- * Connector
- Housing: Thermoplastic, Black
- Pin: Copper alloy, Gold plated
- Shield: Metal
- Slider: Thermoplastic, Black
- Outer mold: Thermoplastic, Black
- * Cable: UL2517, 22#*4, OD=4.8mm, PVC Jacket, Black
- * Cable length tolerance: 1M: +50/-0 mm
- 1M < L ≤ 3M: +100/-0 mm
- 3M < L ≤ 5M: +150/-0 mm
- 5M < L ≤ 10M: ±100 mm
- 10M < L ≤ 20M: ±200 mm
- 20M < L ≤ 30M: ±300 mm
- 30M < L ≤ 99M: ±500 mm

| Pin Out | Wire | Wire |
|---------|-------|------|
| 5 | -- | |
| 4 | Black | 黑 |
| 3 | Blue | 藍 |
| 2 | White | 白 |
| 1 | Brown | 棕 |
| Pin # | Wire | |

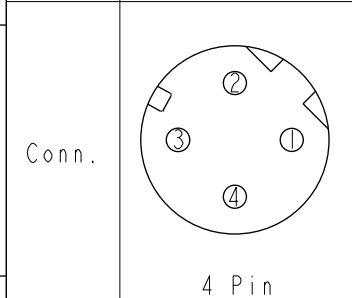

Pin Assignments Front View $\triangle B$

| | | |
|-----------|---------|----------|
| UNIT:mm | \odot | ∇ |
| TOLERANCE | ±0.5 mm | |

| | | | |
|---|----------------|---------------------------|--|
| TITLE N SEN, MI2 D, PUSH PULL CABLE W/O SR, M, M, MOLDING | | | |
| SCALE 2:1 | SIZE A4 | SHEET 1 OF 1 | |
| REV. C | WC-REV. A.1 | \odot : Inspection item | |

Amphenol LTW
 安費諾亮泰企業股份有限公司

| | | |
|------------------------------|---------------------------|--------------------|
| ITEM NO | DRAWN BY Vincent Huang | DATE 2020/09/09 |
| DWG NO MI2D-XXBMMM-PL8DXX | CHECKED BY Aric Ko | DATE 2020/09/09 |
| CUSTOMER ALTW | APPROVED BY Max Yang | DATE 2020/09/09 |