



American Opto Plus LED Corp.

L944-UV265-2-20

4.4 x 4.4 x 1.5mm Ultraviolet SMD LED

FEATURE

- Deep Ultraviolet LED
- All metal design Cu substrate/ Al reflector
- Viewing angle: 120 degree
- Low thermal resistance

OUTLINE DIMENSION

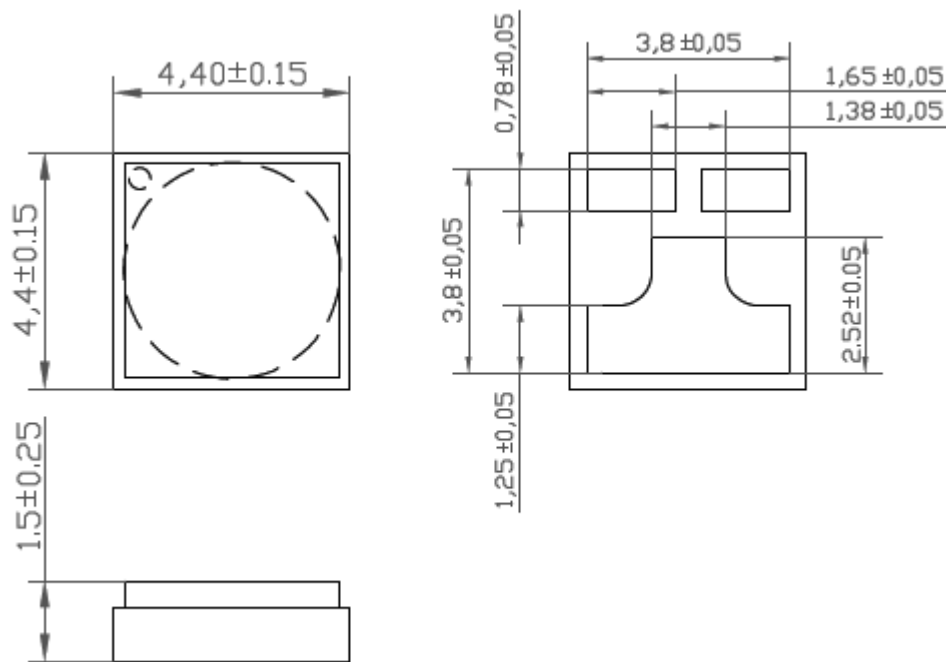

Notes: All dimensions are in millimeters unless otherwise noted

PAD CONFIGURATION

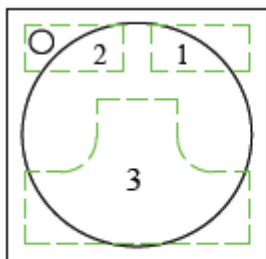

TOP

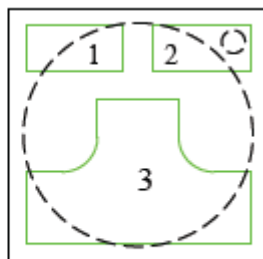

BOTTOM

PAD	Function
1	Cathode
2	Anode
3	Thermal



American Opto Plus LED Corp.

L944-UV265-2-20

4.4 x 4.4 x 1.5mm Ultraviolet SMD LED

ABSOLUTE MAXIMUM RATINGS

(Ta=25°C)

	Symbol	Rating	Unit
Power Dissipation	Pd	0.2	W
Forward Current	I _F	20	mA
Thermal Resistance, Junction-Case	R _{th, J-C1}	15	°C/W
Operating temperature Range	T _{opr}	-40~+60	°C
Storage temperature Range	T _{stg}	-40~+100	°C
Soldering Condition	T _{slid}	260°C for 5 sec	--

Notes: The thermal resistance value is measured with MCPCB

OPTICAL-ELECTRICAL CHARACTERISTICS

(Ta=25°C)

	Symbol	Test condition	Min.	Typ.	Max.	Unit
Peak Wavelength	λ _p	I _F =20mA	265	--	275	nm
Radiant Flux	Φ _e		1.0	1.2	--	mW
Forward Voltage	V _F		--	7	10	V
Spectral Half width	Δλ		--	15	--	nm

Notes:

1. Forward voltage measurement allowance is ±0.2V
2. Radiant flux measurement allowance is ±10%
3. Wavelength measurement allowance is ±3nm



American Opto Plus LED Corp.

L944-UV265-2-20

4.4 x 4.4 x 1.5mm Ultraviolet SMD LED

TYPICAL ELECTRICAL-OPTICAL CHARACTERISTIC CURVES

Forward Current vs. Forward Voltage

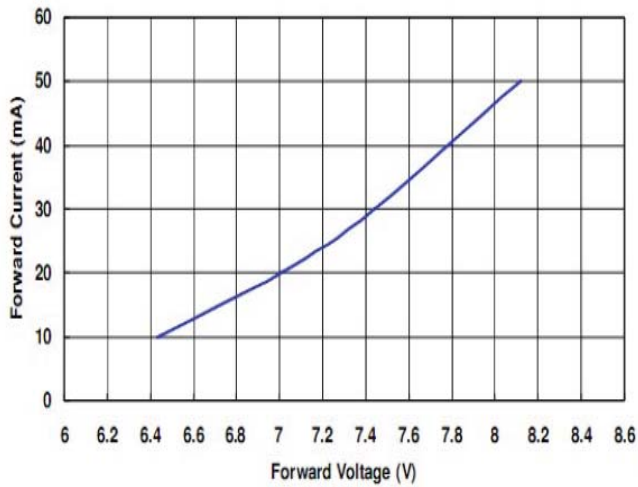

Relative Intensity vs. Forward Current

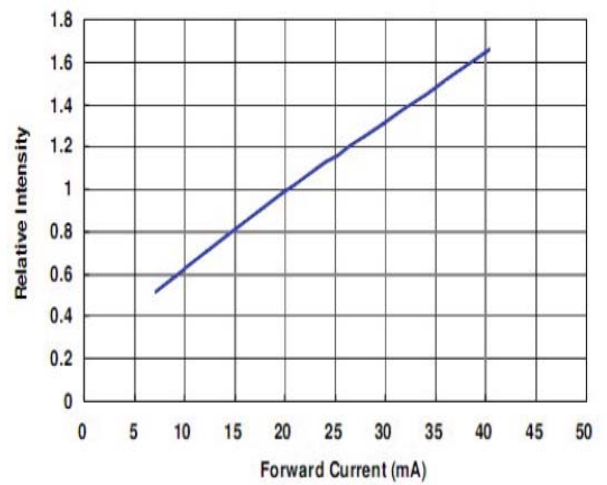

Spectral Power Distribution

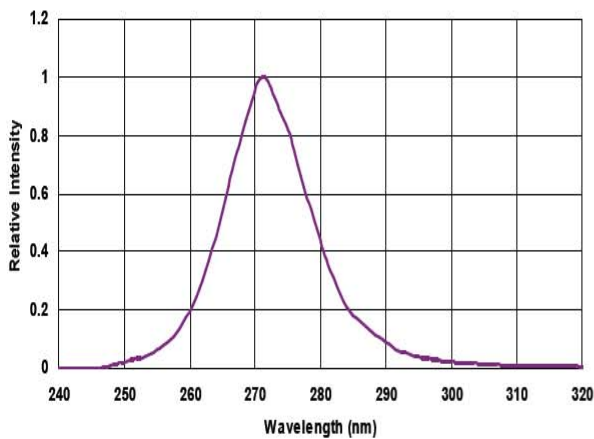

Typical Radiation Pattern

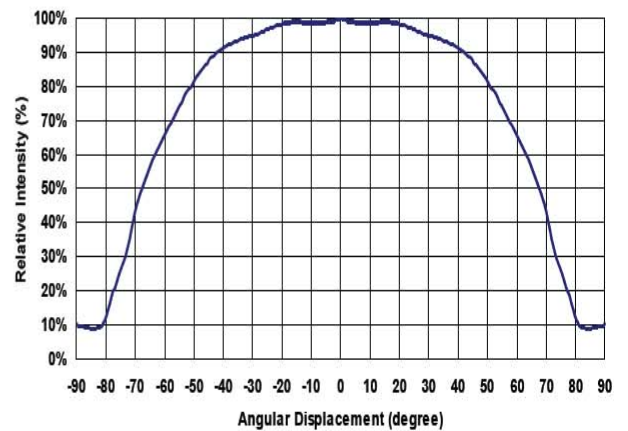



American Opto Plus LED Corp.

L944-UV265-2-20

4.4 x 4.4 x 1.5mm Ultraviolet SMD LED

RECOMMENDED SOLDERING PAD PATTERN

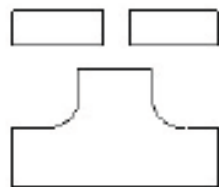
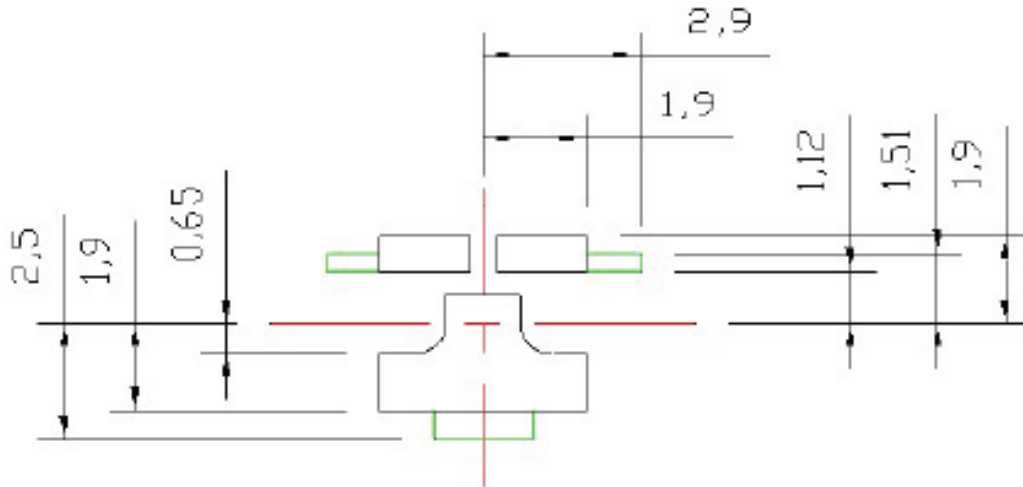

**SOLDER
MASK**

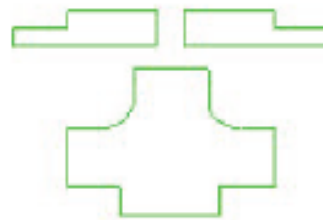

**COPPER
LAYER**



American Opto Plus LED Corp.

L944-UV265-2-20

4.4 x 4.4 x 1.5mm Ultraviolet SMD LED

SOLDERING CONDITIONS

- Recommended soldering profile

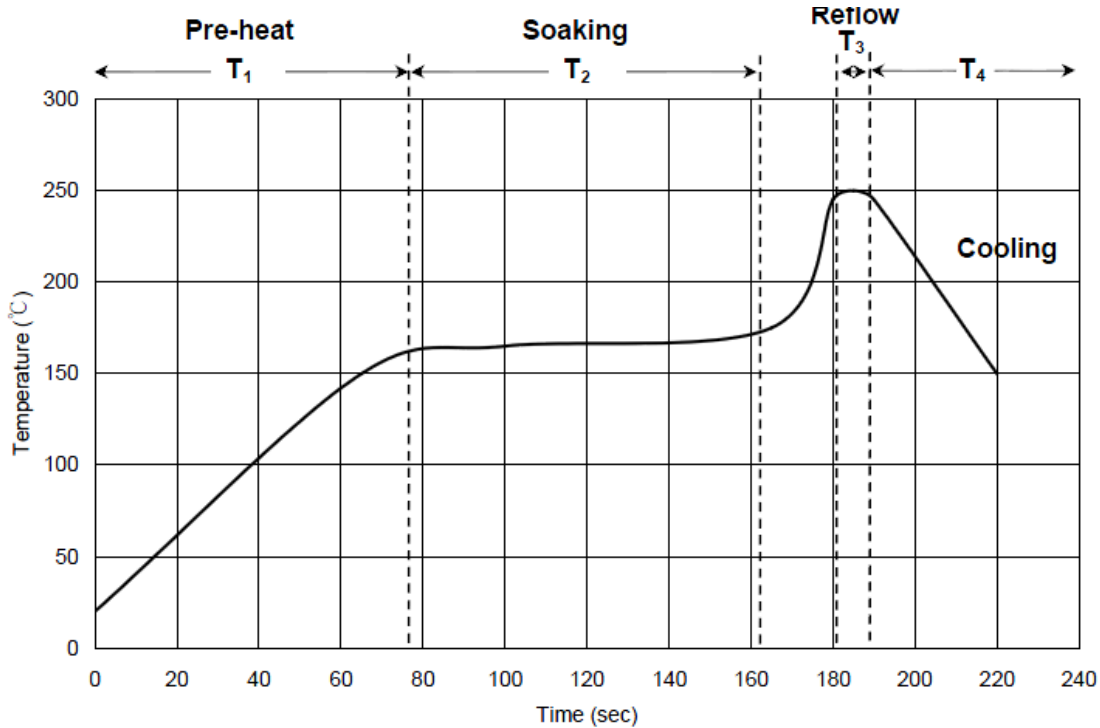

T1	Ramp up rate	1.0 ~ 3.0 °C/sec
	Pre-heat time	50~80 sec
T2	Soaking temperature	155~185°C
	Dwell time during soaking	60~120 sec
T3	Reflow temperature	240~250°C
	Reflow time	10 sec Max
	Ramp up rate during reflow	1.2~2.3 °C/sec
T4	Cooling	1.0~6.0 °C/sec

Notes:

- Recommend using Sn96Ag3Cu0.5 lead free solder
- Use alcohol-based cleaning solvents such as isopropyl alcohol to clean LED if necessary



American Opto Plus LED Corp.

L944-UV265-2-20

4.4 x 4.4 x 1.5mm Ultraviolet SMD LED

TAPE DIMENSION

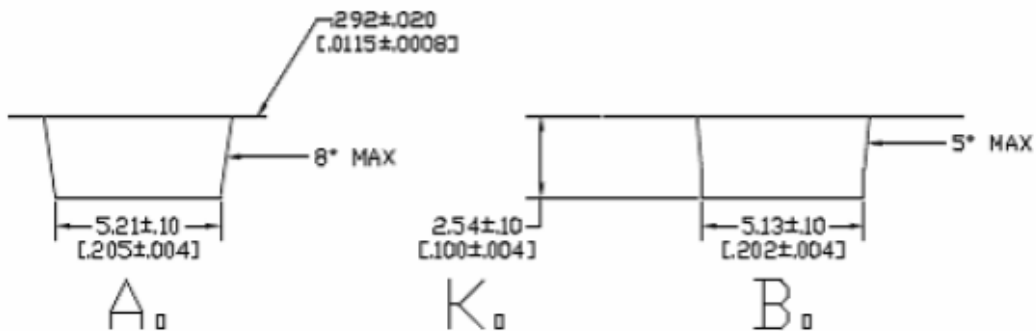
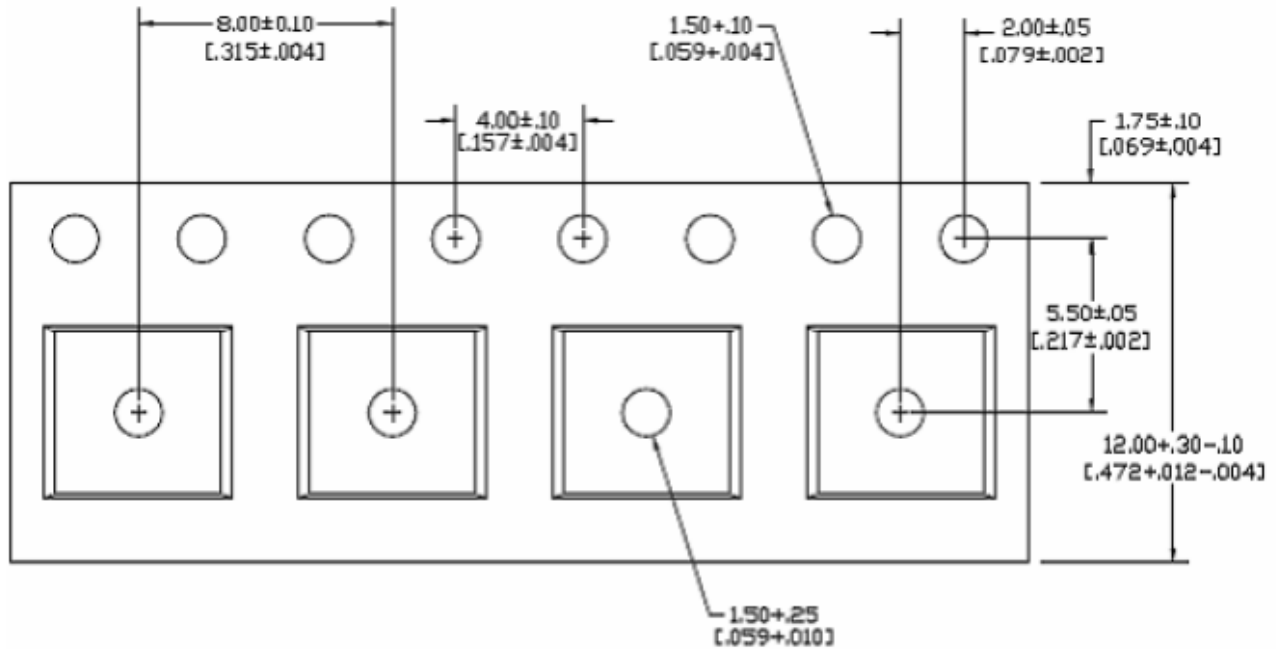

Notes:

1. All dimensions are in millimeter [inches] unless otherwise noted
2. Moisture proof bag
3. 1 Reel/ bag
4. Quantity: 800(max)/ Reel



American Opto Plus LED Corp.

L944-UV265-2-20

4.4 x 4.4 x 1.5mm Ultraviolet SMD LED

REEL DIMENSION

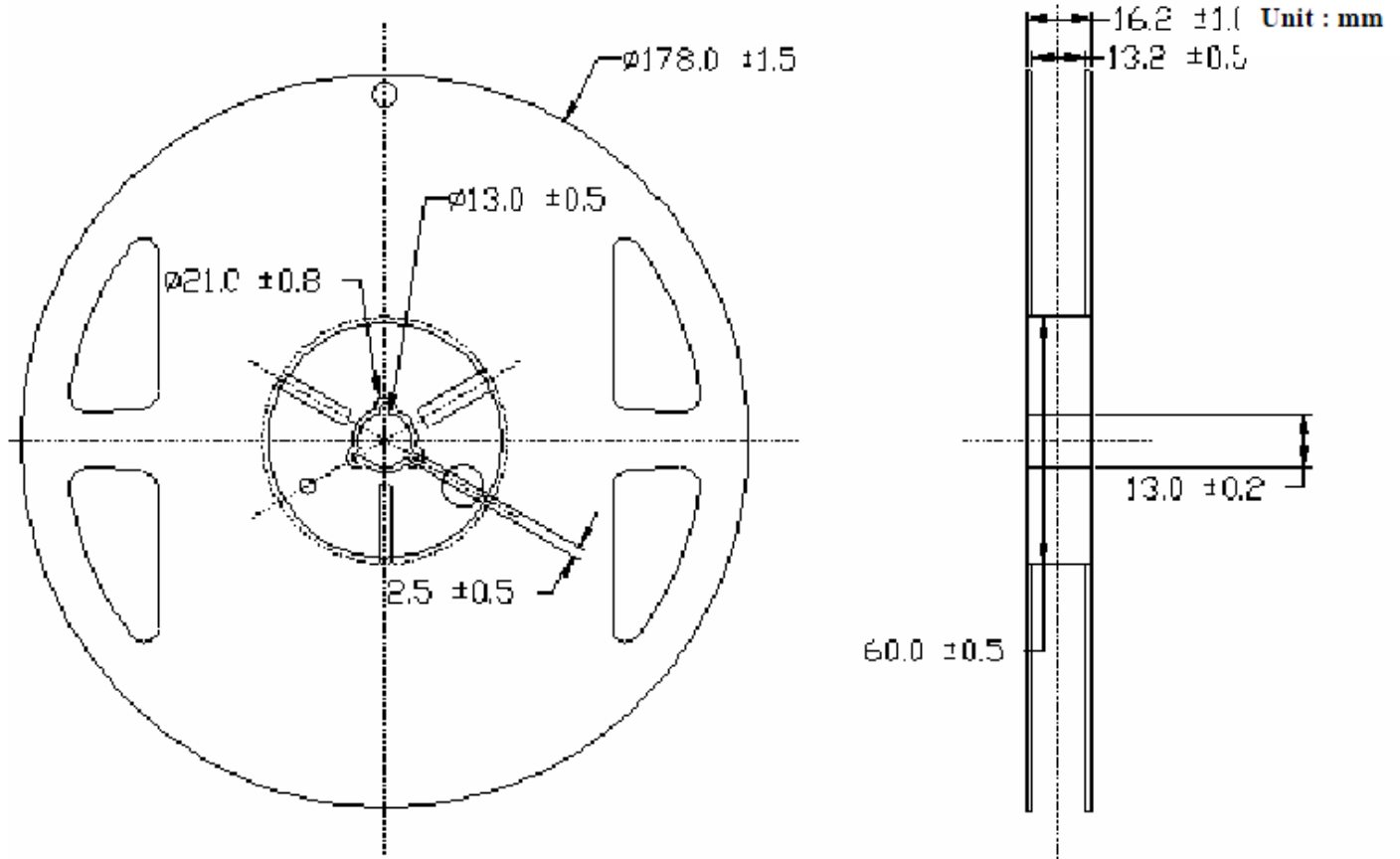

Box Type	Dimension(mm)	Reel/Box	120°Lens Type(pcs)
Small box(S)	230 x 85 x 265	5	4000
Middle box(M)	470 x 265 x 270	30	24000
Large box(L)	470 x 435 x 270	50	40000