

This document is the property of Amphenol Corporation and is delivered on the express condition that it is not to be disclosed, reproduced or used, in whole or in part, for manufacture or sale by anyone other than Amphenol Corporation without its prior consent, & that no right is granted to disclose or to use any information in this document.

Customer drawing

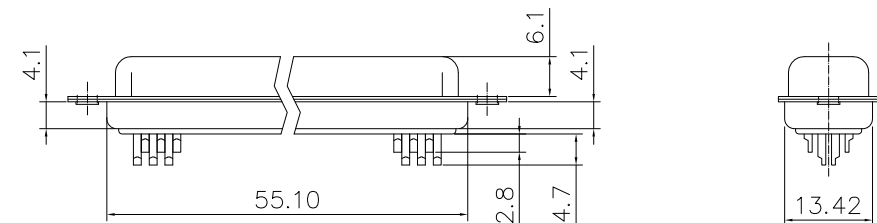
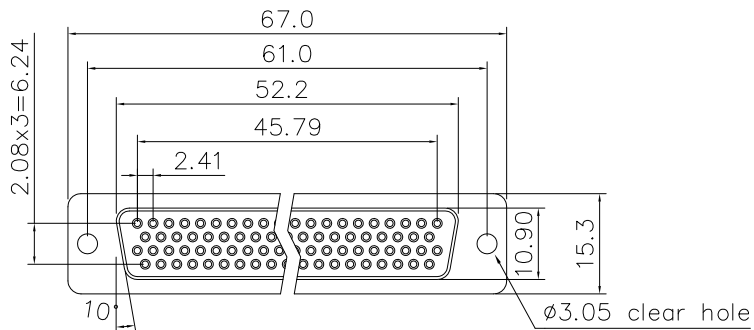
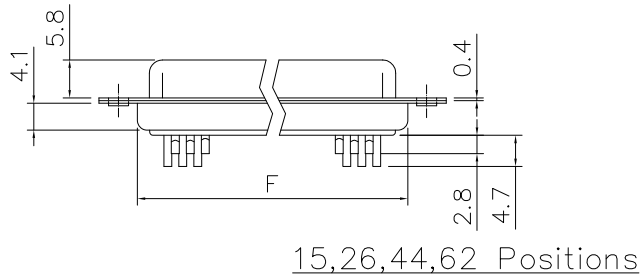
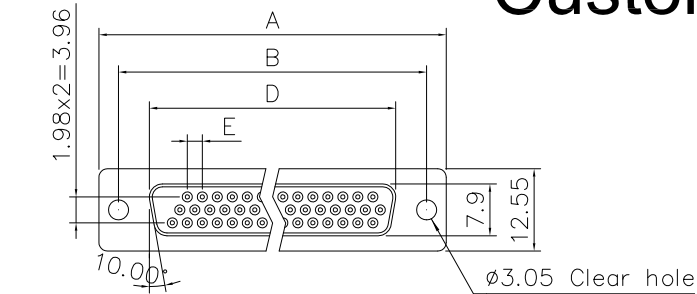

Dimensions

78 Positions

| Positions | A | B | D | E | F |
|-----------|-------|-------|-------|------|-------|
| 15 | 30.81 | 24.99 | 16.33 | 2.29 | 19.20 |
| 26 | 39.20 | 33.30 | 24.70 | 2.29 | 27.70 |
| 44 | 53.05 | 47.04 | 38.40 | 2.29 | 41.10 |
| 62 | 69.40 | 63.50 | 54.80 | 2.41 | 57.30 |

| REVISIONS | | | | |
|-----------|------|------------------------------|----------|----------|
| SYM | ECN | DESCRIPTION | DATE | APPROVED |
| 1 | HK-- | Initial Release | 06/18/08 | IP |
| 2 | HK-- | Add wire gauge | 12/02/10 | IP |
| 3 | HK-- | Change dim. 30.84 to 30.81mm | 08/27/13 | IP |

D-SUB TECHNICAL DATA

SHELL : Steel, 100u" Tin Over 50u" min nickel over 50u" min Copper
 BODY : Glass-Filled Thermoplastic PBT,UL94V-0 rated
 CONTACTS : Copper alloy
 Gold flash over 50u" nickel on mating area
 100u" tin over 50u" nickel on solder area

ELECTRICAL : Voltage rating 250 VAC/RMS
 Current Rating :3 AMP
 Withstanding Voltage >1000 VAC/RMS
 Insulation resistance >1000 M Ohms
 Contact resistance 20 mOhms max

Wire gauge : 24~28AWG

MARKING : Amphenol...(Series No.)
 Commercial reference
 Manufacturing date

PRODUCT CODE

L 77 HD X XX S

L: RoHS Compliance

HD: high density

Shell Size :E,A,B,C,D

Contact type:
S: socket

Configuration:
15,26,44,62,78

| UNLESS OTHERWISE SPECIFIED TOLERANCES | | APPROVAL | | DATE |
|---------------------------------------|--------|---------------------|---------|----------|
| U.S. | METRIC | DRAWN | Checked | |
| .X +/- | 0.50 | Felix Liu | | 08/27/13 |
| .XX +/- | 0.30 | | | |
| .XXX +/- | 0.20 | Tony Tang | | 08/27/13 |
| FRACTIONS +/- | | CHECKED | | |
| ANGLES +/- | 5° | | | |
| FOR MATERIALS AND FINISHES SEE NOTES | | DRAWING FILE : | | |
| REMOVE SHARP EDGES | | ANGLE OF PROJECTION | | |
| DIMENSIONS | | | | |
| U.S. | INCHES | | | |
| METRIC | MM | | | |

| | | | |
|-------------------------------------|-------------|----------------------------|--|
| Amphenol | | Amphenol East Asia Limited | |
| TITLE Solder cup type, HD Series | | | |
| SIZE | DRAWING NO. | REV. | |
| A4 | C L77HDXXXS | 3 | |
| SCALE | NONE | SHEET 1 OF 1 | |