

A5	CC1	B5	CC2
A9	VBUS	B9	VBUS
A12	GND	B12	GND
PIN	SIGNAL NAME	PIN	SIGNAL NAME

Pinout

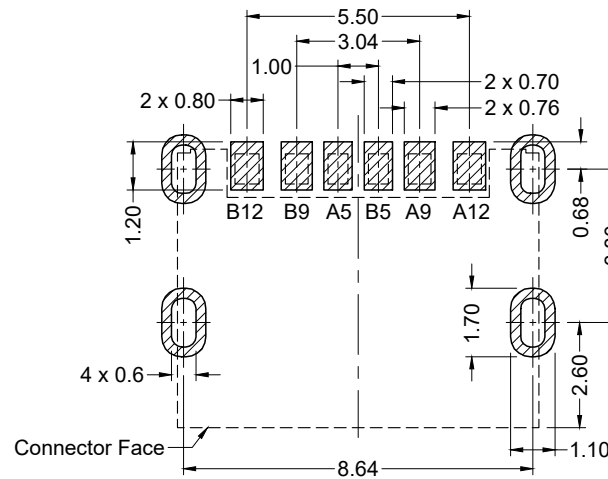
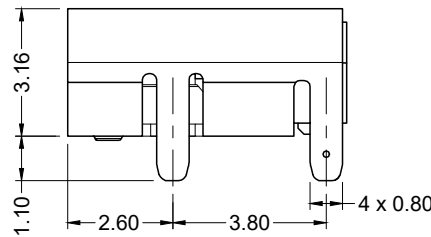

Recommended PCB Layout
(Top View)

Materials and Finish

Housing: High Temp Thermoplastic
UL 94V-0 Rated, Black Color
Shield: Stainless Steel, Nickel Plated
Contact Material:
Copper Alloy
Contact plating:
Gold Flash on Contact Area,
Tin Plated on Solder Tails,
All over Nickel Underplate

Electrical Characteristics

Rated Current:
2.5A (Collectively) for VBUS.
2.5A (Collectively) for GND.
1.25A for CCs.
Rated Voltage: 20V
Insulation Resistance:
100 Megohms Min. at 250V DC
Contact Resistance:
40 milliohms Max.
Dielectric Withstanding Voltage:
100V AC RMS for 1 Minute

Mechanical Characteristics

Insertion Force: 5N - 20N
Withdrawal Force: 6N - 20N
Durability: 8000 Mating Cycles Min.
Operating Temperature:
-25°C to +85°C

Tolerances
X.X ± 0.30
X.XX ± 0.25
Unless Stated
Otherwise



REV.	DATE	DESCRIPTION	REV. BY	CHK. BY	DRAWN BY	DATE
A0.1	08/19/20	New Drawing	G. Serrato	D. Shehan	G. Serrato	08/19/20
A1	05/11/21	Release Drawing	C. Kelleher	N/A		

KUSBX-SMT-CS-6-BTR

Right Angle USB Type C Receptacle

6 pin, SMT, High Temp

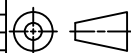

UNITS
mm