

DASH NO.	M CODE	MADE FROM
----------	--------	-----------

GSD

KU-89-29-M06

REVISIONS

ISSUE	CHANGES
1	CN 26769 C MZB 06/21/89

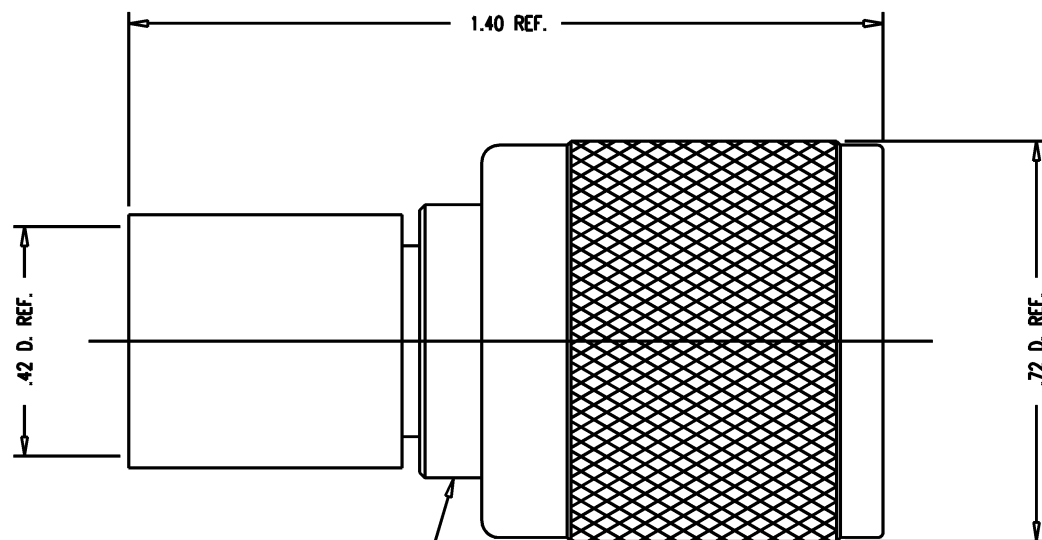

STAMP: KINGS KU-89-29-M06

NOTES:

- FOR USE WITH RG-8, 11, 149 & 213/U CABLE.
- FOR CRIMPING USE DIE SIZE KTH-2003.
- MATERIALS:**
K-GRIP SLEEVE-COMMERCIAL BRONZE, ALLOY 220
ALL OTHER METAL PARTS-BRASS, ASTM-B16
- FINISHES:**
ALL METAL PARTS-KINGS TARNISH RESISTANT FINISH (TR-5)

KAM1261

SCALE 4:1

APPROX SURFACE AREA

USED ON

REF:

BODY ASSY, UHF

DRAWN KH DATE 07/10/91

DESIGN MJB DATE 07/10/91

APPR. DATE

KINGS
ELECTRONICS CO., INC.
TUCKAHOE, NEW YORK 10707

KU-89-29-M06

GSD