

Keylock switch 2 positions

K14-136.22200



<https://eao.com/p/K14-136.22200>

Your product:



K14-136.22200

Keylock switch 2 positions

FRONT

Front dimension:	Ø 35 mm
Front bezel colour:	Nature
Front bezel material:	Aluminium

MOUNTING

Mounting cut-out:	Ø 30.5 mm
--------------------------	-----------

ELECTRICAL CHARACTERISTICS

Standards:	According to EN/IEC 61058-1
Electrical lifetime:	50 000 cycles of operation
Electrostatic discharge (ESD):	15 kV
Contacts:	2 NC / 2 NO
Rated Operational Voltage U_e:	250 VAC/DC according to EN IEC 61058-1
Protection class:	II
Thermal current I_{th}:	5 A
Electric strength:	3000 VAC, 50 Hz, 1 min. between all terminals and earth, according to EN/IEC 61058-1
Switching voltage and switching current:	250 VAC, 5 A (ohmic) 250 VAC, 2 A (inductive, cos(phi) = 0.7) 220 VDC, 0.1 A (inductive, L:R = 30 ms) 110 VDC, 0.2 A (inductive, L:R = 30 ms) 60 VDC, 0.7 A (inductive, L:R = 30 ms) 24 VDC, 2 A (inductive, L:R = 30 ms)

MECHANICAL CHARACTERISTIC

Wire cross section:	Max. wire diameter 2 wires à 1.2 mm
----------------------------	-------------------------------------

Max. wire cross-section of stranded cable 1 x 1 mm²

Switching angle:	90° right
Switching positions:	2 positions
Operating Travel:	ca. 90°
Tightening torque:	Fixing nut max. 0.25 Nm
Switching action:	Rest (a) - Maintained (a)
Operating force:	5 N ... 8 N
Contact material:	Gold-plated silver
Mechanical lifetime:	1 Mio. cycles of operation
Terminal:	Soldering terminal
Switching system:	Snap-action switching element
Weight:	0.044 kg

AMBIENT CONDITION

Vibration resistance:	Max. 100 m / s ² from 10 Hz ... 500 Hz, (sinusoidal EN IEC 60068-2-6)
IP front protection:	IP65, according to DIN EN 60529
Shock resistance:	Max. 150 m / s ² , pulse width 11 ms, 3-axis, (semi-sinusoidal as per EN IEC 60068-2-27)
Operating temperature:	- 25 °C ... + 55 °C
Climate resistance:	Standard condition, as per DIN EN 60068-2-78 Standard cyclic, as per DIN IEC 60068-2-30
Storage temperature:	- 40 °C ... + 85 °C

CERTIFICATE

Conformities:	CE, UKCA, 2011 / 65 / EC (RoHS), 2014 / 35 / EU (LVD)
Approbations:	CB (IEC 61058-1), CQC, CSA, DNV, ENEC (EN 61058-1), UL

OTHER

max. number of switching elements:	1
Housing material:	Plastic
Short Description:	Keylock switch 2 positions, Rest (a) - Maintained (a), 250 V AC @ 5 A, 2 NC / 2 NO, Soldering terminal, Aluminium
Hints:	Lock numbers 1001, lock type KABA
Wiring diagrams:	

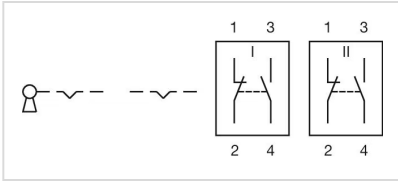

Mounting cut-outs:

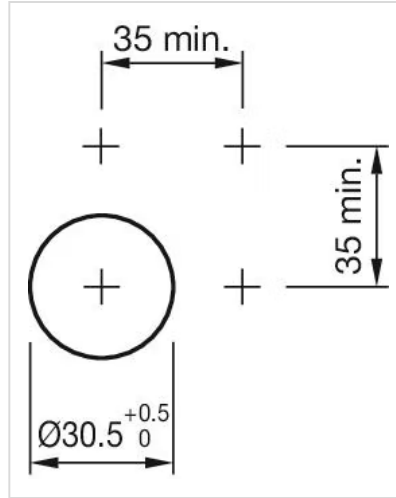

Dimension drawings:

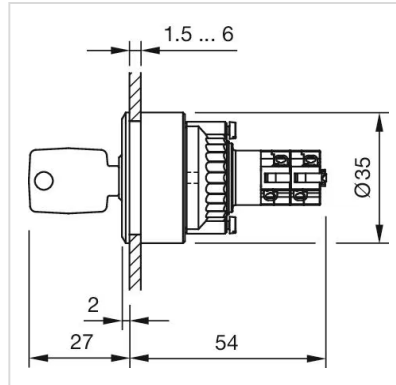

Switching positions:

