

# Indicator

K14-  
040.120101



<https://eao.com/p/K14-040.120101>

Your product:

---



## K14-040.120101 Indicator

### MOUNTING

**Mounting cut-out:** Ø 22.3 mm

### OPERATING-/INDICATION PART

**Lens shape:** flush

**Lens optics:** transparent

**Illumination colour:** Red

**Lens illumination:** illuminative

**Lens colour:** Red

**Lens material:** Plastic

### ELECTRICAL CHARACTERISTICS

**Thermal current I<sub>th</sub>:** 5 A

**Electric strength:** 3000 VAC, 50 Hz, 1 min. between all terminals and earth, according to EN/IEC 61058-1

**Rated Operational Voltage U<sub>e</sub>:** 250 VAC/DC according to EN IEC 61058-1

**Electrical lifetime:** 50 000 cycles of operation

**Standards:** According to EN/IEC 61058-1

**Protection class:** II

**Operating voltage:** 24 V AC/DC

**Switching voltage and switching current:**  
250 VAC, 5 A (ohmic)  
250 VAC, 3 A (Soldering terminal)  
250 VAC, 2 A (inductive, cos(phi) = 0.7)  
220 VDC, 0.1 A (inductive, L:R = 30 ms)  
110 VDC, 0.2 A (inductive, L:R = 30 ms)  
60 VDC, 0.7 A (inductive, L:R = 30 ms)  
24 VDC, 2 A (inductive, L:R = 30 ms)

**Operation current:** 2,5/5 mA  $\pm$ 15 %

## MECHANICAL CHARACTERISTIC

**Terminal:** Soldering terminal

**Contact material:** Gold-plated silver

**Weight:** 0.021 kg

**Tightening torque:** Fixing nut max. 0.25 Nm

## AMBIENT CONDITION

**Storage temperature:** - 40 °C ... + 85 °C

**Climate resistance:** Standard condition, as per DIN EN 60068-2-78  
Standard cyclic, as per DIN IEC 60068-2-30

**Operating temperature:** - 25 °C ... + 55 °C, mounted as a block, make sure the heat can escape freely

**IP front protection:** IP67, according to DIN EN 60529

**Shock resistance:** Max. 150 m / s<sup>2</sup>, pulse width 11 ms, 3-axis, (semi-sinusoidal as per EN IEC 60068-2-27)

**Vibration resistance:** Max. 100 m / s<sup>2</sup> from 10 Hz ... 500 Hz, (sinusoidal EN IEC 60068-2-6)

## CERTIFICATE

**Approbations:** CB (IEC 61058-1), CQC, CSA, DNV, ENEC (EN 61058-1), UL

**Conformities:** CE, UKCA, 2011 / 65 / EC (RoHS), 2014 / 35 / EU (LVD)

## OTHER

**Short Description:** Indicator, 24 V AC/DC, Soldering terminal, Red, Red

**Housing material:** Plastic

**Housing colour:** Black

**Wiring diagrams:**



**Mounting cut-outs:**

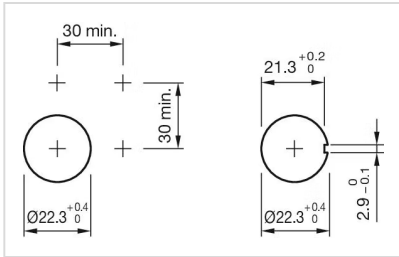

**Dimension drawings:**

