

LTR	REVISION	DATE	APPD
A	060818-GP01: REMOVED P/N'S, ADDED P/N (XIW) & UPDATED TEST TABLE	06-08-18	GP

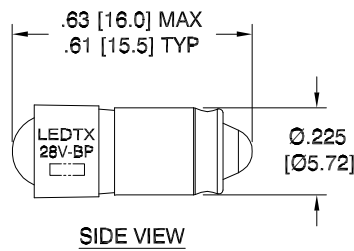
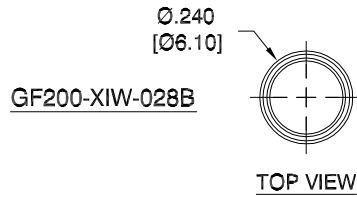
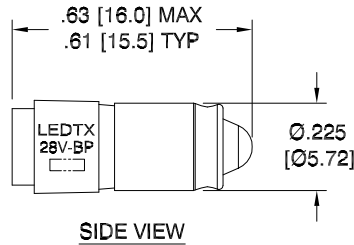
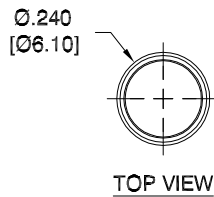

NOTES:

1. ALL DIMENSIONS ARE IN INCHES (MILLIMETERS).
2. SLEEVE MATERIAL: RYNITE FR530
3. BASE MATERIAL: BRASS WITH NICKEL-PLATED
4. OPERATING TEMPERATURE: ~-30°C to ~+50°C

REVISION NOTIFICATION	
<input type="checkbox"/>	DLC
<input type="checkbox"/>	UL/ETL
<input type="checkbox"/>	MADE IN USA
<input type="checkbox"/>	CUSTOMER _____
<input type="checkbox"/>	OTHER
REDLINE CHECKLIST	
<input type="checkbox"/>	REDLINE(YES)
<input type="checkbox"/>	DATE: _____
<input type="checkbox"/>	INITIATED BY: _____
<input type="checkbox"/>	ECR REQUIRED YES <input type="checkbox"/> NO <input type="checkbox"/>
<input type="checkbox"/>	WORK ORDER# _____

ELECTRICAL-OPTICAL CHARACTERISTICS (Ta = 25°C)

GF200-0CW-028B	COOL WHITE	24/28Vdc(@28Vdc)	0.42 W	0.015 A	0.160cd	8000K	100°	BipolarDC(+/-)
GF200-0PB-028B	SUPER BLUE	24/28Vdc(@28Vdc)	0.42 W	0.020 A	0.125cd	462	95°	BipolarDC(+/-)
GF200-0UR-028B	ULTRA RED	24/28Vdc(@28Vdc)	0.42 W	0.020 A	0.085cd	650	120°	BipolarDC(+/-)
GF200-0UY-028B	SUPER YELLOW	24/28Vdc(@28Vdc)	0.42 W	0.020 A	0.075cd	595	110°	BipolarDC(+/-)
GF200-XIW-028B	WARM WHITE	24/28Vdc(@28Vdc)	0.42 W	0.015 A	0.600cd	3000K	105°	BipolarDC(+/-)
LEDTRONICS PART NO.	COLOR EMITTED	INPUT VOLTAGE, V	POWER (W)	CURRENT (A)	MAXIMUM CANDELA	λP nm COLOR TEMP. (K)	VIEWING ANGLE (FULL BEAM WIDTH @ 50% INTENSITY)	CONTACT POLARITY

LED[®]
LEDTRONICS, TM INC.
23105 KASHIWA COURT
TORRANCE, CA 90505

-PROPRIETARY-
This document contains Proprietary information of LEDTRONICS, INC. It may not be copied, used or disclosed for any purpose without the prior express written consent of LEDTRONICS, INC.

.XXX ± .010 TOLERANCE PER ANSI-Y14.5
.XX ± .025 (UNLESS OTHERWISE STATED)
ANGLES ± 0°,30'
FRACT. ± 1/32

TITLE							
GF200-XXX-028B							
DWG NO		SCALE		SHEET		DATE	
GF200-28V-BP		2:1		1 OF 1		08-27-07	
CODE IDENT NO.	DWG BY	CHK BY	QA	EE	MFG LD	R&D	KS
8Z410	08-27-07		06-12-18		06-12-18		06-11-18