

THIS COPY IS PROVIDED ON A RESTRICTED BASIS AND IS NOT TO BE USED IN ANY WAY DETRIMENTAL TO THE INTERESTS OF PANDUIT CORP.

NOTES:

1. MATERIAL:
-BODY - HIGH COPPER CONTENT ALLOY
-HARDWARE - SILICON BRONZE
2. PARTS ARE cULus LISTED TO UL467/CSA22.22 No. 41 AS GROUNDING AND BONDING EQUIPMENT.
3. CONNECTORS ACCOMODATE TWO EQUAL DIAMETER CONDUCTORS IN THE RANGE SPECIFIED.
4. ACCOMODATES BAR THICKNESS OF 0.250 [6.35] MAX.
5. RATED FOR DIRECT BURIAL
6. SEE PACKAGING LABEL FOR TIGHTENING TORQUE SPECIFICATIONS.
7. DIMENSIONS IN PARENTHESIS ARE MILLIMETERS.
8. SEE www.PANDUIT.COM FOR PACKAGE QUANTITIES.

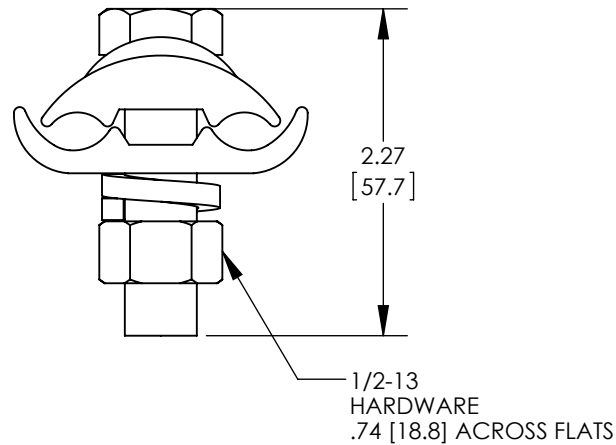
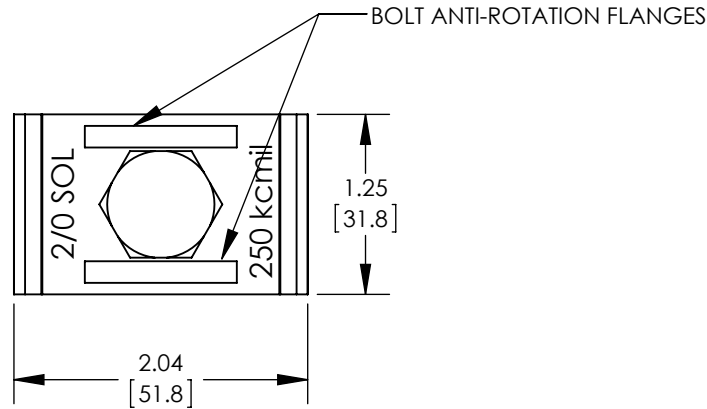

PANDUIT PART NUMBER	COPPER CONDUCTOR RANGE
GBC2250-12	2/0 SOL - 250 kcmil



DB RATED

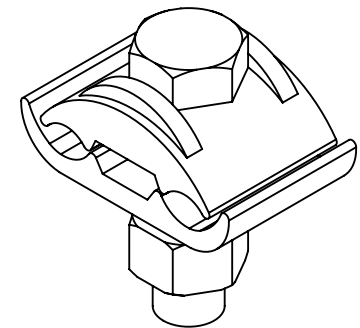

REV	DATE	BY	CHK	APR	DESCRIPTION	ECN
01	1/16	JHNU	BKR	RGB	REVISED NOTE 2: REMOVED 13	13J051AL-DC
00	10/15	JHNU	BKR	RGB	DRAWING RELEASED	13J051AL-DC

TITLE		GROUND BAR CLAMP CUSTOMER DRAWING	
ITEM REVISION NAME	13J051AL/00		
DATASET FILE NAME	13J051AL-DC/00.SLDDRW		
UNLESS OTHERWISE SPECIFIED, DIMENSIONAL TOLERANCES ARE: IN [mm]		MATERIAL	
.X ±	.XXX ±	SEE NOTES	
.XX ± .05 [1.3]	ANGLES ±	DRAWING NUMBER	
THIRD ANGLE PROJECTION		13J051AL-DC	
DRAWN BY	DATE	CHK	SCALE
JHNU	4/15	BKR	N/A
SHEET 1 OF 1			SIZE
			A