



Heyco® Rubber Grommets

For Panels from .063" (1,6 mm) to .125" (3,2 mm) Thick

MOUNTING HOLE DIAMETER		PART NO.	DESCRIPTION	MATERIAL	PART DIMENSIONS					
in.	mm.				A Inside Diameter	B Head Diameter		C Overall Height		
		Black			in.	mm.	in.	mm.	in.	mm.
For .063" (1,6 mm) Thick Panels (continued)										
1.750	44,5	G1369	RG 1750-48-2	SBR	1.50	38,1	2.13	54,0	.44	11,1
2.375	60,3	G1409	RG 2.375-40-2	Nitrile	1.25	31,8	2.75	69,9		
2.500	63,5	G1418	RG 2.5-40-2	Nitrile	1.25	31,8	2.88	73,0		
		G1422	RG 2.5-68-2	SBR	2.13	54,0				
For .078" (2,0 mm) Thick Panels										
1.000	25,4	G1253	RG 1000-22-3	SBR	.69	17,5	1.31	33,4	.38	9,5
For .094" (2,4 mm) Thick Panels										
.281	7,1	G1010	RG 281-6-3	SBR	.19	4,8	.44	11,1	.22	5,6
.312	7,9	G1014	RG 312-6-3	SBR	.19	4,8	.50	12,7	.28	7,1
.375	9,5	G1033	RG 375-4-3	SBR	.13	3,2	.50	12,7	.31	8,0
		G1038	RG 375-8-3	SBR	.25	6,4	.50	12,7	.25	6,4
		G1039	RG 375-8-3A	SBR	.25	6,4	.56	14,3	.28	7,1
.437	11,1	G1062	RG 437-10-3	SBR	.31	8,0	.63	15,9	.31	8,0
.750	19,1	G1178	RG 750-16-3	SBR	.50	12,7	.88	22,2	.34	8,7
		G1179	RG 750-16-3A	SBR	.50	12,7	.97	24,6	.28	7,1
1.125	28,6	G1281	RG 1125-28-3	SBR	.88	22,2	1.50	38,1	.34	8,7
2.000	50,8	G1387	RG 2000-48-3	SBR	1.50	38,1	2.38	60,3	.38	9,5
For .110" (2,8 mm) Thick Panels										
.630	16,0	G1140	RG 630-16-3	SBR	.50	12,7	.81	20,6	.30	7,6
For .125" (3,2 mm) Thick Panels										
.312	7,9	G1020	RG 312-6-4	SBR	.19	4,8	.44	11,8	.25	6,4
.406	10,3	G1047	RG 406-9-4	SBR	.28	7,1	.63	15,9	.38	9,5
.437	11,1	G1056	RG 437-8-4	SBR	.25	6,4	.63	15,9	.25	6,4
.500	12,7	G1092	RG 500-12-4	SBR	.38	9,5	.63	15,9	.31	8,0
		G1093	RG 500-12-4A	SBR	.38	9,5	.63	15,9	.41	10,3
.562	14,3	G1114	RG 562-10-4	SBR	.31	8,0	.81	20,7	.38	9,5
.625	15,9	G1127	RG 625-6-4	Nitrile	.19	4,8	.88	22,2	.25	6,4
		G1132	RG 625-12-4	SBR	.38	9,5	.88	22,2	.38	9,5
.687	17,5	G1152	RG 687-14-4	SBR	.44	11,1	.94	23,8	.38	9,5
.812	20,6	G1188	RG 812-12-4	SBR	.38	9,5	1.06	27,0		
		G1193	RG 812-16-4	SBR	.50	12,7	1.06	27,0		
		G1198	RG 812-18-4	SBR	.56	14,3	1.06	27,0		
.875	22,2	G1218	RG 875-20-4	SBR	.63	15,9	1.13	28,6	.31	8,0
1.000	25,4	G1244	RG 1000-12-4	SBR	.38	9,5	1.25	31,8		
		G1247	RG 1000-16-4	SBR	.50	12,7	1.25	31,8		
		G1255	RG 1000-22-4	SBR	.69	17,5	1.31	33,4		
1.250	31,8	G1259	RG 1000-24-4	EPDM	.75	19,1	1.19	30,2		
		G1260	RG 1000-24-4A	SBR	.75	19,1	1.25	31,8	.38	9,5
1.250	31,8	G1291	RG 1250-16-4	SBR	.50	12,7	1.50	38,1	.31	8,0
		G1299	RG 1250-24-4	SBR	.75	19,1	1.63	41,3		
		G1304	RG 1250-28-4	SBR	.88	22,2	1.63	41,3		

Standard color black.

- **Used to protect through holes.** Help eliminate sharp edges so your wires are protected and add aesthetic value to your application.
- 113 sizes available that will accommodate mounting holes ranging from .250" (6,4 mm) to holes as large as 2.375" (60,3 mm) diameter and panel thicknesses from .063" (1,6 mm) to .188" (4,8 mm).
- Rubber grommets are constructed of SBR (unless otherwise noted) with an operating temperature range of -40°F (-40°C) to 221°F (105°C).
- SBR grommets have good water resistant characteristics and are suitable for most moderate chemicals and wet or dry organic acids.
- Provide vibration dampening.

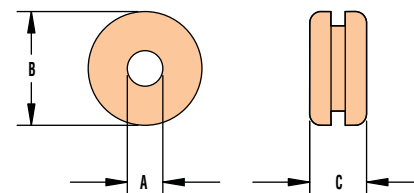

Material	SBR, Nitrile or EPDM
Temperature Range	-40°F (-40°C) to 221°F (105°C)

Quick Specs