

AUTOMOTIVE RELAY FOR EV/PHV ON-BOARD CHARGER

1 POLE – 40A

FTR-K5 Series

RoHS Compliant

■ FEATURES

- 1 pole 40A, 1a contact
- 32A 250VAC switching which corresponds 6.6kW standard charger
- 40A continuous power supply
- Vibration resistance and shock resistance meet automotive relay specification standards
- Operable at up to +105°C ambient temperature
- High insulation
 - Between coil and contact creepage distance 8.8mm
(Conform to IEC61810-1 277V enhanced insulation)
 - Between coil and contact withstand voltage 5000 VAC
- Selectable from flux free and plastic sealed
- Plastic parts: UL flammability 94V-0
- Through hole



■ APPLICATIONS

EV/PHV on-board charger (standard charger AC line), Standard charger, Vehicle to Home (V2H), Package air conditioner (PAC)

■ PART NUMBERS

[Example] FTR-K5 A A 005 Y
 (a) (b) (c) (d) (e)

(a)	Relay type	FTR-K5	: FTR-K5 series
(b)	Contact configuration	A	: 1a (1 form A)
(c)	Power consumption / Enclosure	A K	: 900mW / Plastic sealed : 900mW / Flux free
(d)	Coil voltage	Coil code	: Refer to COIL DATA
(e)	Contact material	Y :	: Silver alloy

Note: The designation name is stamped on the top of the relay case as follows:

Example: Ordering part number; FTR-K5AA005Y

Stamped on relay case: K5AA005Y

FTR-K5 Series

■ SPECIFICATIONS

Item		Specifications		Remarks / Conditions	
		Plastic sealed	Flux free		
Contact Data	Configuration	1a (1 form A)			
	Material	Silver alloy			
	Construction	Single contact			
	Contact rating	32A 250VAC		Resistive	
	Drop voltage (Initial)	Max. 0.32V		At 32A	
	Resistance	Max. 10mΩ		At 32A	
	Max. carrying current	40A (at 105°C, cable size 8mm ²)		At nominal voltage	
	Min. switching load*	1A, 6VDC			
Coil	Rated power consumption	900mW		At 20°C	
	Operate power consumption	440mW		At 20°C	
	Operating temperature range	-40°C to 105°C		No frost	
Time	Operate	Max. 20ms (without bounce)		At 20°C, nominal voltage	
	Release	Max. 10ms (without bounce, without diode)		At 20°C, nominal voltage	
Life	Mechanical	1,000,000 operations			
	Electrical	25,000 operations		Making 5A, carrying 32A, breaking 5A, 250VAC, resistive	
		200,000 operations		Inrush 60A, 250VAC, interrupt 10mA, at 250VAC	
		1,000 operations	30,000 operations	Making 32A, breaking 32A, 250VAC, resistive	
Insulation	Insulation resistance	Min. 1,000 MΩ		500 VDC	
	Dielectric withstanding voltage	Open contacts	1,000VAC (50/60Hz), 1 minute		
		Coil-contact	5,000VAC (50/60Hz), 1 minute		
Others	Vibration resistance	Misoperation	5~200 Hz, 45 m/s ² constant acceleration		Sense time 1ms, contact ON/OFF
		Endurance	5~200 Hz, 45 m/s ² constant acceleration		Up/down 4 hours, left/right/front/back each 2 hours, contact ON/OFF
	Shock resistance	Misoperation	100 m/s ² (11 ms)		Sense time 1ms, contact ON/OFF
		Endurance	1000 m/s ² (6 ms)		Contact ON/OFF total 36 times
	Dimensions / weight		18.0 x 30.5 x 29.7 mm / Approx. 39g		

Note: Electrical characteristics mentioned above are the values at JIS standard condition (temperature 15 to 35°C, relative humidity 25 to 75%, atmospheric pressure 86k to 106kPa) unless otherwise specified.

Note: Care shall be taken on the heat generated on PC board when maximum carrying current exceed 10A.

*: Minimum switching loads mentioned above are reference values. Please perform the confirmation test with actual load before production since reference values may vary according to switching frequencies, environmental conditions and expected reliability levels.

FTR-K5 Series

COIL DATA

Coil Code	Rated Coil Voltage (VDC)	Coil Resistance $\pm 10\%$ (Ω)	Must Operate Voltage* (VDC)	Must Release Voltage* (VDC)	Nominal Power (mW)
005	5	28	3.5	0.25	Approx. 900
006	6	40	4.2	0.3	
012	12	160	8.4	0.6	
024	24	640	16.8	1.2	

Note: All values in the table are valid at 20°C and zero contact current unless otherwise specified.

Note: Please use at rated coil voltage. Please refer to characteristic data and set up adequate voltage in case of use at over voltage.

*: Specified operate values are valid for pulse wave voltage.

DIMENSIONS

Dimensions

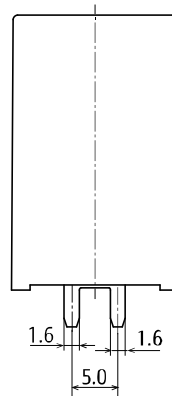
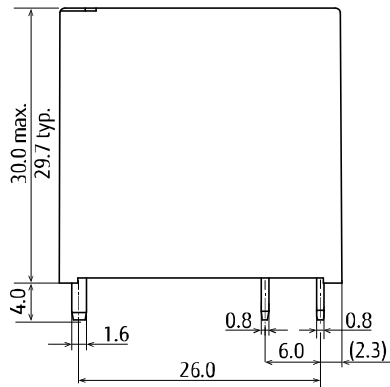
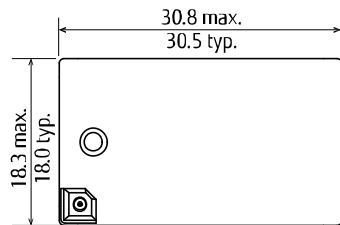

Schematics (BOTTOM VIEW)

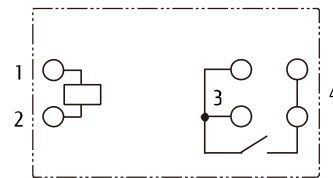

Two terminals of #3 shall be connected on the board and soldered respectively to guarantee carrying current performance. Ditto for #4.

PC Board Mounting Hole Layout (BOTTOM VIEW)

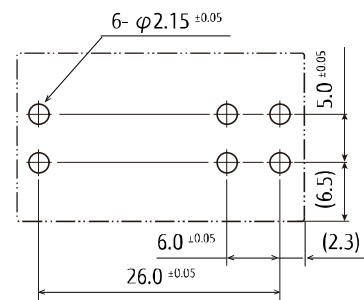

- Dimensions of the terminals do not include thickness of pre-solder.
- Dimensions do not include tolerances.

() : Reference
Unit: mm

FTR-K5 Series

COIL DATA (Characteristic data is not guaranteed value but measured values of samples from production line.)

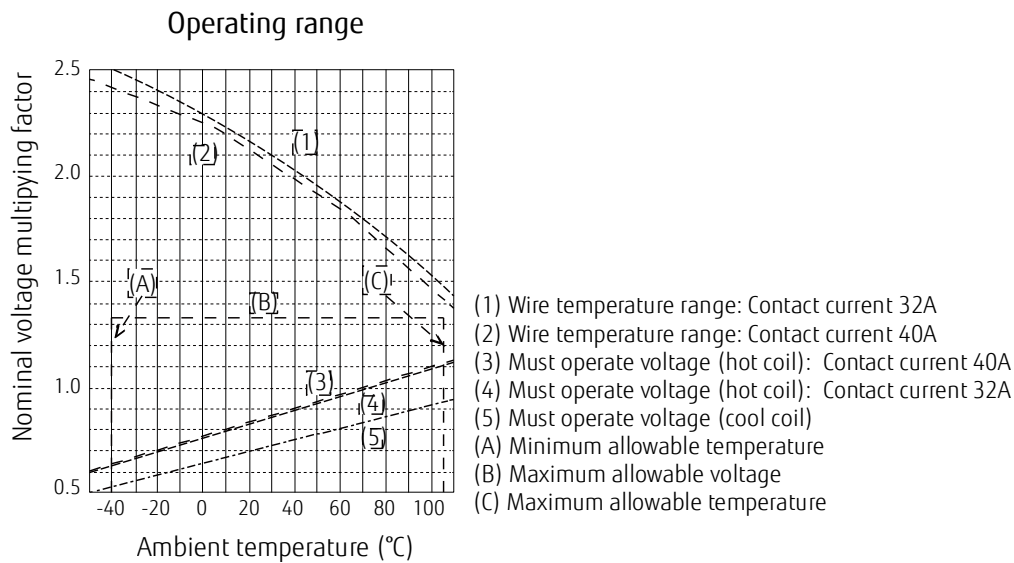

Cautions

- * All values mentioned in this datasheet are provided under ideal conditions. Please perform the confirmation test before actual use.
- * Reflow soldering is prohibited.
- * Do not use relays in the atmosphere with sulfide gas, chloride gas or nitric oxide. Contact resistance may increase.
- * Do not use silicon or silicon-containing product or materials near relays. It may cause contact failure.

General Information

1. RoHS Compliance

- All relays produced by Fujitsu Components are compliant with RoHS directive 2011/65/EU, including commission delegated directive 2015/863.

2. Recommended Lead Free Solder Condition

- Lead free solder plating on relay terminals is Sn-3.0Ag-0.5Cu, unless otherwise specified. This material has been verified to be compatible with PbSn assembly process.
- Recommended solder for assembly: Sn-3.0Ag-0.5Cu.

Flow Solder Condition

Pre-heating: Maximum 120°C with 90 sec.
Soldering: Dip within 5 sec. at 255°C ± 5°C solder bath
Relay must be cooled by air immediately after soldering.

Solder by Soldering Iron

Soldering Iron: 30 – 60W
Temperature: Maximum 340 – 360°C
Duration: Maximum 3 sec.

We highly recommend that you confirm your actual solder conditions

3. Moisture Sensitivity

- Moisture Sensitivity Level standard is not applicable to electromechanical relays, unless otherwise indicated.

4. Tin Whiskers

- Dipped SnAgCu solder is known as presenting a low risk to tin whisker development. No considerable length whisker was found by our in house test.

FTR-K5 Series

Fujitsu Components International Headquarter Offices

Japan

FUJITSU COMPONENT LIMITED
Shinagawa Seaside Park Tower
12-4, Higashi-shinagawa 4-chome,
Shinagawa-ku, Tokyo, 140-0002, Japan
Tel: (81-3) 3450-1682
Fax: (81-3) 3474-2385
Email: fcl-contact@cs.jp.fujitsu.com
www.fcl.fujitsu.com/

Asia Pacific

FUJITSU COMPONENTS ASIA, LTD.
102E Pasir Panjang Road
#01-01 Citilink Warehouse Complex,
Singapore 118529
Tel: (65) 6375-8560
Fax: (65) 6273-3021
Email: fcal@sg.fujitsu.com
www.fujitsu.com/sg/products/devices/components/

Korea

FUJITSU COMPONENTS KOREA LIMITED
Alpha Tower #403, 645 Sampoong-dong,
Bundang-gu, Seongnam-si, Gyeonggi-do,
13524 Korea
Tel: (82) 31-708-7108
Fax: (82) 31-709-7108
Email: fcal@sg.fujitsu.com
www.fujitsu.com/sg/products/devices/components/

North and South America

FUJITSU COMPONENTS AMERICA, INC.
2290 North First Street, Suite 212
San Jose, CA 95131 USA
Tel: (1-408) 745-4900
Fax: (1-408) 745-4970
Email: components@us.fujitsu.com
https://us.fujitsu.com/components/

China

FUJITSU ELECTRONIC COMPONENTS (SHANGHAI) CO., LTD.
Unit 4306, InterContinental Center
100 Yu Tong Road, Shanghai 200070, China
Tel: (86-21) 3253 0998
Fax: (86-21) 3253 0997
Email: fcsh@cn.fujitsu.com
www.fujitsu.com/cn/products/devices/components/

Europe

FUJITSU COMPONENTS EUROPE B.V.
Diamantlaan 25
2132 WV Hoofddorp
Netherlands
Tel: (31-23) 5560910
Fax: (31-23) 5560950
Email: info@fceu.fujitsu.com
www.fujitsu.com/uk/components

Hong Kong

FUJITSU COMPONENTS HONG KONG CO., LTD.
Unit 2313, Seapower Tower, Concordia Plaza,
No.1 Science Museum Road, TST, Kowloon,
Hong Kong
Tel: (852) 2881-8495
Tex: (852) 2894-9512
Email: fcal@sg.fujitsu.com
www.fujitsu.com/sg/products/devices/components/

©2021 Fujitsu Component Limited. All rights reserved. All trademarks or registered trademarks are the property of their respective owners.

The contents, data and information in this datasheet are provided by Fujitsu Component Limited as a service only to its user and only for general information purpose.

The use of the contents, data and information provided in this datasheet is at the users' own risk.

Fujitsu has assembled this datasheet with care and will endeavor to keep the contents, data and information correct, accurate, comprehensive, complete and up to data.

Fujitsu Component Limited and affiliated companies do however not accept any responsibility or liability on their behalf, nor on behalf of its employees, for any loss or damage, direct, indirect or consequential, with respect to this datasheet, its contents, data, and information and related graphics and the correctness, reliability, accuracy, comprehensiveness, usefulness, availability and completeness thereof.

Nor do Fujitsu Component Limited and affiliated companies accept on their behalf, nor on behalf of its employees, any responsibility or liability for any representation or warrant of any kind, express or implied, including warranties of any kind for merchantability or fitness for particular use, with respect to these datasheets, its contents, data, information and related graphics and the correctness, reliability, accuracy, comprehensiveness, usefulness, availability and completeness thereof. June 22, 2021