

Book-style EMC/RFI Filter for Inverters and Power Drive Systems

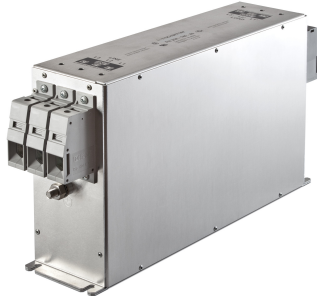

- Industry standard EMC solution for three-phase PDS filtering
- Slim space-saving book-style housing
- Solid safety connector blocks or optional wire output connections
- Excellent attenuation performance
- HV versions for up to 690 VAC
- HVIT versions for IT distribution networks
- P/L versions with low leakage current



Performance indicators

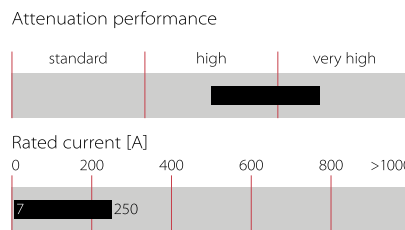

Approvals & Compliances



UL/CSA: FN 258 up to 180 A (ex. -180-07)

Features and benefits

FN 258 range of filters provides state-of-the-art EMI attenuation based on an innovative multi-stage filter topology. They help to ensure compliance with Class A or even Class B limits

The slim book-style shape allows a convenient and space-saving installation next to inverters and motor drives

With 480 VAC rating and filter modules from 7 to 250 A, FN 258 are ready for the most diverse applications worldwide

FN 258 HV filters up to 130 A are designed for 690 VAC distribution networks

FN 258 HVIT filters up to 130 A meet the special requirements for the application in industrial 690 VAC IT distribution networks

FN 258 L and FN 258 P filters help to fulfill tough requirements in respect of leakage current limitation and provide an excellent solution to overcome problems with nuisance tripping of sensitive earth leakage detectors

Technical specifications

Maximum continuous operating voltage

3x 520/300 VAC (FN 258, FN 258 L, FN 258 P)
3x 760/440 VAC (FN 258 HV, FN 258 HVIT)

Rated currents

7 to 250 A @50°C (480 V filters)

Operating frequency

DC to 60 Hz

High potential test voltage

P -> E 2650 VDC for 2 sec (FN 258)
P -> P 2100 VDC for 2 sec (FN 258)
P -> E 2000 VAC for 2 sec (FN 258L)
P -> P 2100 VDC for 2 sec (FN 258L)
P -> E 3000 VDC for 2 sec (FN 258P)
P -> P 2100 VDC for 2 sec (FN 258P)
P -> E 3200 VDC for 2 sec (FN 258HV and FN 258HVIT)
P -> P 3270 VDC for 2 sec (FN 258HV and FN 258HVIT)

Protection category

IP 20

Overload capability

4x rated current at switch on,
1.5x rated current for 1 minute, once per hour

Temperature range (operation and storage)

-25°C to +100°C (25/100/21)

Flammability corresponding to

UL 94 V-2 or better

Design corresponding to

UL 1283, CSA 22.2 No. 8 1986, IEC/EN 60939

MTBF @ 50°C/400 V (Mil-HB-217F)

220,000 hours

Typical applications

Three-phase variable speed drives and power drive systems (PDS)

IT power distribution networks (FN 258 HVIT)

Applications comprising energy conversion devices (inverters, converters)

Process automation equipment

Three-phase power supplies and UPS

Applications with low-leakage current requirements (FN 258 L and FN 258 P)

Typical electrical schematic

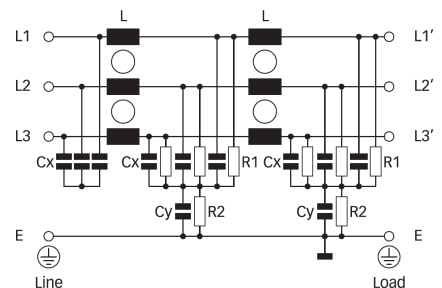

Note: HVIT versions without discharge resistor to ground.

Filter selection table

Filter*	Rated current @ 50°C (40°C) [A]	Typical drive power rating** [kW]	Leakage current*** @ 520/760 VAC/50 Hz [mA]	Power loss @ 25°C/50 Hz [W]	Input connections	Output connections	Weight [kg]
FN 258-7-..	7 (7.7)	4	2.0	9	-29	-07	1.0
FN 258-16-..	16 (17.5)	7.5	2.1	20	-29	-07	1.4
FN 258-30-..	30 (33)	15	2.9	21	-33	-07	1.7
FN 258-42-..	42 (46)	22	3.0	30	-33	-07	2.5
FN 258-55-..	55 (60)	30	3.0	30	-34	-07	2.9
FN 258-75-34	75 (82)	37	3.0	24	-34	-34	3.9
FN 258-100-35	100 (110)	55	3.0	51	-35	-35	5.5
FN 258-130-35	130 (143)	75	3.5	50	-35	-35	6.9
FN 258-180-..	180 (197)	90	3.5	73	-40	-07	11.0
FN 258-250-..	250 (275)	132	3.4	79	-40	-07	12.0
FN 258 HV-7-29	7 (7.7)	5.5	1.6	9	-29	-29	1.0
FN 258 HV-16-29	16 (17.5)	11	2.3	20	-29	-29	1.5
FN 258 HV-30-33	30 (33)	22	2.3	21	-33	-33	1.8
FN 258 HV-42-33	42 (46)	30	2.6	30	-33	-33	2.6
FN 258 HV-55-34	55 (60)	45	2.6	30	-34	-34	3.0
FN 258 HV-75-34	75 (82)	55	2.6	24	-34	-34	4.3
FN 258 HV-100-35	100 (110)	90	2.6	51	-35	-35	5.6
FN 258 HV-130-35	130 (143)	110	2.9	50	-35	-35	7.1
FN 258 HVIT-7-29	7 (7.7)	5.5	0.1	9	-29	-29	1.0
FN 258 HVIT-16-29	16 (17.5)	11	0.1	20	-29	-29	1.5
FN 258 HVIT-30-33	30 (33)	22	0.1	21	-33	-33	1.8
FN 258 HVIT-42-33	42 (46)	30	0.1	30	-33	-33	2.6
FN 258 HVIT-55-34	55 (60)	45	2.6	30	-34	-34	3.0
FN 258 HVIT-75-34	75 (82)	55	2.6	24	-34	-34	4.3
FN 258 HVIT-100-35	100 (110)	90	2.6	51	-35	-35	5.6
FN 258 HVIT-130-35	130 (143)	110	2.9	50	-35	-35	7.1
FN 258 L-7-..	7 (7.7)	4	0.1	9	-29	-07	1.0
FN 258 L-16-..	16 (17.5)	7.5	0.1	20	-29	-07	1.4
FN 258 L-30-..	30 (33)	15	0.1	21	-33	-07	1.7
FN 258 L-42-..	42 (46)	22	0.1	30	-33	-07	2.5
FN 258 L-55-..	55 (60)	30	0.1	30	-34	-07	2.9
FN 258 L-75-34	75 (82)	37	0.1	24	-34	-34	3.9
FN 258 L-100-35	100 (110)	55	0.1	51	-35	-35	5.5
FN 258 L-130-35	130 (143)	75	0.1	50	-35	-35	6.9
FN 258 L-180-..	180 (197)	90	0.1	73	-40	-07	11.0
FN 258 L-250-07	250 (275)	132	0.1	79	-40	-07	12.0
FN 258 P-7-..	7 (7.7)	4	0.4	9	-29	-07	1.0
FN 258 P-16-..	16 (17.5)	7.5	0.4	20	-29	-07	1.4
FN 258 P-30-..	30 (33)	15	0.4	21	-33	-07	1.7
FN 258 P-42-..	42 (46)	22	0.4	30	-33	-07	2.5
FN 258 P-55-..	55 (60)	30	0.4	30	-34	-07	2.9
FN 258 P-75-34	75 (82)	37	0.4	24	-34	-34	3.9
FN 258 P-100-35	100 (110)	55	0.4	51	-35	-35	5.5
FN 258 P-130-35	130 (143)	75	0.4	50	-35	-35	6.9
FN 258 P-180-..	180 (197)	90	0.4	73	-40	-07	11.0
FN 258 P-250-07	250 (275)	132	0.4	79	-40	-07	12.0

*To compile a complete part number, please replace the .. with the required output connection style.

**Calculated at rated current, 440 VAC (FN 258)/690 VAC (FN 258 HV) and $\cos \phi=0.8$. The exact value depends upon the efficiency of the drive, the motor and the entire application.

*** Standardized calculated leakage current acc. IEC60939 under normal operating conditions (FN 258 at 520 VAC and FN 258 HV at 760 VAC).

Typical filter attenuation

Per CISPR 17; A=50 Ω/50 Ω sym; B=50 Ω/50 Ω asym; C=0.1 Ω/100 Ω sym; D=100 Ω/0.1 Ω sym

7 to 30 A types

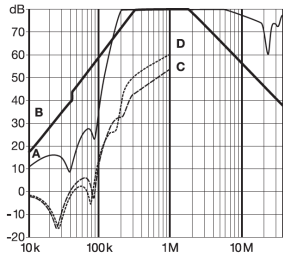

42 to 100 A types

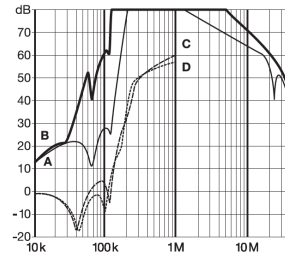

130 A types

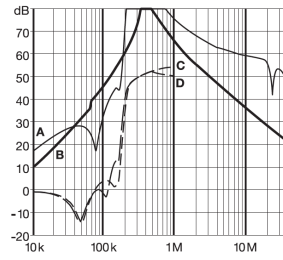

180 and 250 A types

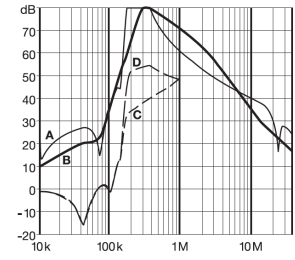

Note: typical attenuation performance of FN 258 standard filters. The behavior of FN 258 HV, FN 258 HVIT, FN 258 P and FN 258 L may be slightly different.

Mechanical data

7 to 55 A types (-07)

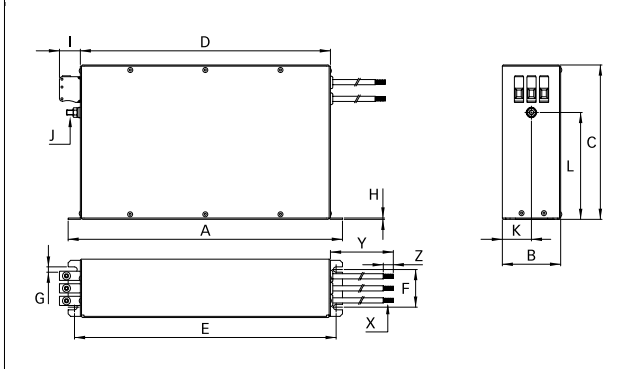

7 to 130 A types (-29, -33, -34, -35)

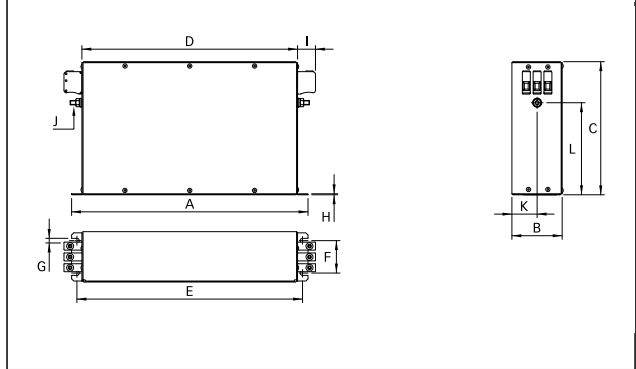

180 and 250 A types (-07)

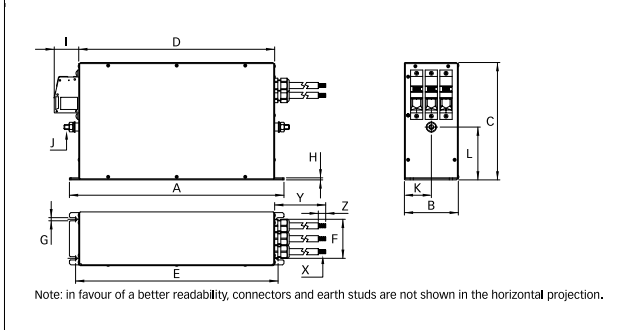

180 and 250 A types (-40)

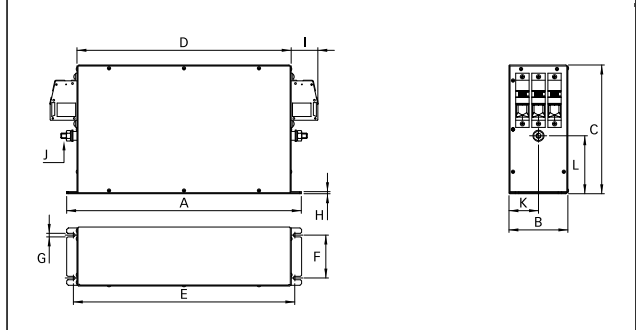





Note: in favour of a better readability, connectors and earth studs are not shown in the horizontal projection.

Dimensions

	7 A	16 A	30 A	42 A	55 A	75 A	100 A	130 A	180 A	250 A
A	255	305	335	329	329	329	379	439	438	478
B	50	55	60	70	80	80	90	110	110	110
C	126	142	150	185	185	220	220	240	240	240
D	225	275	305	300	300	300	350	400	400	440
E	240	290	320	314	314	314	364	414	413	453
F	25	30	35	45	55	55	65	80	80	80
G	6.5	6.5	6.5	6.5	6.5	6.5	6.5	6.5	6.5	6.5
H	1	1	1	1.5	1.5	1.5	1.5	3	4	4
I	10.9	10.9	25	25	39	39	45	45	51	51
J	M5	M5	M5	M6	M6	M6	M10	M10	M10	M10
K	25	27.5	30	35	40	40	45	55	55	55
L	85	100	110	130	105	140	130	140	110	110
X*	AWG 16	AWG 14	AWG 10	AWG 8	AWG 6				50 mm ²	70 mm ²
Y*	300 ±10	300 ±10	400 ±10	500 ±10	500 ±10				500 ±10	500 ±10
Z*	9	9	9	12	12				15	15

* Filters with output wire connections (-07) only.
 All dimensions in mm; 1 inch = 25.4 mm
 Tolerances according: ISO 2768-m/EN 22768-m

Filter input/output connector cross sections

	-29	-33	-34	-35	-40
Solid wire	 6 mm ²	 16 mm ²	 35 mm ²	 50 mm ²	 95 mm ²
Flex wire	4 mm ²	10 mm ²	25 mm ²	50 mm ²	95 mm ²
AWG type wire	AWG 10	AWG 6	AWG 2	AWG 1/0	AWG 4/0
Recommended torque	0.6-0.8 Nm	1.5-1.8 Nm	4.0-4.5 Nm	7-8 Nm	17-20 Nm

Please visit www.schaffner.com to find more details on filter connectors.



Switzerland**Schaffner Group**

Industrie Nord
 Nordstrasse 11e
 4542 Luterbach
 T +41 32 681 66 26
info@schaffner.com

To find your local partner within Schaffner's global network: www.schaffner.com

© 2018 Schaffner Group

The content of this document has been carefully checked and understood. However, neither Schaffner nor its subsidiaries assume any liability whatsoever for any errors or inaccuracies of this document and the consequences thereof. Published specifications are subject to change without notice. Product suitability for any area of application must ultimately be determined by the customer. In all cases, products must never be operated outside their published specifications. Schaffner does not guarantee the availability of all published products. This disclaimer shall be governed by substantive Swiss law and resulting disputes shall be settled by the courts at the place of business of Schaffner Holding AG. Latest publications and a complete disclaimer can be downloaded from the Schaffner website. All trademarks recognized.

China**Schaffner EMC Ltd. Shanghai**

T20-3 C, No 565 Chuangye Road,
 Pudong district
 201201 Shanghai
 T +86 21 3813 9500
cschina@schaffner.com
www.schaffner.com.cn

Finland**Schaffner Oy**

Sauvonrinne 19 H
 08500 Lohja
 T +358 10 567 2855
finlandsales@schaffner.com

France**Schaffner EMC S.A.S.**

16-20 Rue Louis Rameau
 95875 Bezons
 T +33 1 34 34 30 60
 F +33 1 39 47 02 28
francesales@schaffner.com

Germany**Schaffner Deutschland GmbH**

Schoemperlenstrasse 12B
 76185 Karlsruhe
 T +49 721 56910
 F +49 721 569110
germanysales@schaffner.com

India**Schaffner India Pvt. Ltd**

REGUS WORLD TRADE CENTRE
 WTC, 22nd Floor Unit No 2238, Brigade Gateway
 Campus, 26/1, Dr. Rajkumar Road Malleshwaram
 (W)
 560055 Bangalore
 T +91 80 67935355
indiasales@schaffner.com

Italy**Schaffner EMC S.r.l.**

Via Ticino, 30
 20900 Monza (MB)
 T +39 039 21 41 070
italysales@schaffner.com

Japan**Schaffner EMC K.K.**

Taiju-Seimei Sangenjaya Bldg.
 1-32-12, Kamiyama, Setagaya-ku
 154-0011 Tokyo
 T +81 3 5712 3650
 F +81 3 5712 3651
japansales@schaffner.com
www.schaffner.jp

Singapore**Schaffner EMC Pte Ltd.**

#05-09, Kg Ubi Ind. Estate
 408705 Singapore
 T +65 6377 3283
 F +65 6377 3281
singaporesales@schaffner.com

Spain**Schaffner EMC España**

Calle Caléndula 93, Miniparc III, Edificio E
 El Soto de Moraleja, Alcobendas
 28109 Madrid
 T +34 917 912 900
 F +34 917 912 901
spainsales@schaffner.com

Sweden**Schaffner EMC AB**

Östermalmstorg 1
 114 42 Stockholm
 T +46 8 5050 2425
swedensales@schaffner.com
www.schaffner.com

Switzerland**Schaffner EMV AG**

Industrie Nord
 Nordstrasse 11e
 4542 Luterbach
 T +41 32 681 66 26
switzerlandsales@schaffner.com

Taiwan R.O.C.**Schaffner EMV Ltd.**

20 Floor-2, No 97, Section 1, XinTai 5th Road
 22175 XiZhi District New Taipei City 22175
 T +886 2 2697 5500
 F +886 2 2697 5533
taiwansales@schaffner.com
www.schaffner.com.tw

Thailand**Schaffner EMC Co. Ltd.**

Northern Region Industrial Estate
 67 Moo 4 Tambon Ban Klang
 Amphur Muang P.O. Box 14
 51000 Lamphun
 T +66 53 58 11 04
 F +66 53 58 10 19
thailandsales@schaffner.com

United Kingdom**Schaffner Ltd.**

1, Oakmede Place
 Binfield
 RG42 4JF Berkshire
 T +44 118 9770070
 F +44 118 9792969
uksales@schaffner.com

USA**Schaffner EMC Inc.**

52 Mayfield Avenue
 Edison, New Jersey
 T +1 732 225 9533
 F +1 732 225 4789
usasales@schaffner.com
www.schaffnerusa.com

Schaffner North America

6722 Thirlane Road
 24019 Roanoke, Virginia
 T +1 276 228 7943
 F +1 276 228 7953

Schaffner North America

823 Fairview Road
 24382 Wytheville, Virginia
 T +1 276 228 7943
 F +1 276 228 7258