

Front View

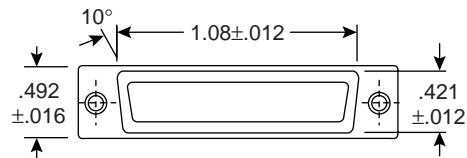

Back View

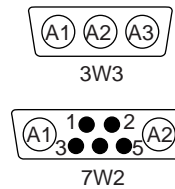
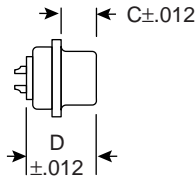

Plug Layouts

### Dimensions (In.)

#### Specifications:

- Type: D-subminiature, mixed contact
- Insulator material: thermoplastic glass filled UL 94V-0
- Shell material: tin plated steel
- Shell size: 15
- Temperature range: -67°F ~ +311°F (-55°C ~ +155°C)
- Insulation resistance: 500MΩ (contact~contact)
- Volume resistivity: 10<sup>16</sup>Ω/cm (ASTM-D 257)
- Dielectric strength: 50KV/mm

Mouser Stock No.	Type	Dimensions (In.)			
		A	B	C	D
152-FM3W3P	Plug	1.02	.378	.236	.484
152-FM3W3S	Socket	.969	.307	.244	.492
152-FM7W2P	Plug	1.02	.378	.236	.484
152-FM7W2S	Socket	.969	.307	.244	.492