

SIDE VIEW

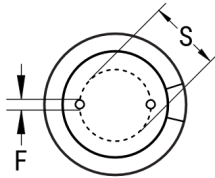

TERMINAL END VIEW



Click [here](#) for the 3D model.

### Dimensions

D	10mm +/-0.5mm
L	15mm +2mm
S	5mm +/-0.5mm
LL Negative	15mm MIN
LL Positive	20mm MIN
F	0.6mm NOM

### Packaging Specifications

Packaging Bulk, Bag

### General Information

Series	ESW
Dielectric	Aluminum Electrolytic
Style	Radial
Description	LowZ Single Ended Aluminum Electrolytic
Features	Low Z
RoHS	Yes
Lead	Wire Leads
AEC-Q200	No

### Specifications

Capacitance	47 uF
Capacitance Tolerance	20%
Voltage DC	100 VDC, 125 VDC (Surge)
Temperature Range	-40/+105°C
Rated Temperature	105°C
Life	5000 Hrs
Dissipation Factor	8%
Ripple Current	420 mAmps (100kHz 105C)
Leakage Current	47 uA (2min 20°C)
Impedance Ratio at -25C	2
Impedance Ratio at -40C	3