

SIDE VIEW

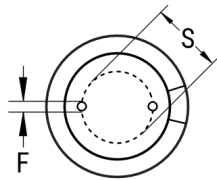

TERMINAL END VIEW



Click [here](#) for the 3D model.

### Dimensions

D	16mm +/-0.5mm
L	25mm +2.0mm
S	7.5mm +/-0.5mm
LL Negative	15mm MIN
LL Positive	20mm MIN
F	0.8mm NOM

### Packaging Specifications

Packaging	Bulk, Bag
-----------	-----------

### General Information

Series	ESE
Dielectric	Aluminum Electrolytic
Description	Single Ended, Aluminum Electrolytic
RoHS	Yes
Lead	Wire Leads
AEC-Q200	No

### Specifications

Capacitance	2,200 uF
Capacitance Tolerance	20%
Voltage DC	35 VDC, 44 VDC (Surge)
Temperature Range	-40/+105°C
Rated Temperature	105°C
Life	1000 Hrs
Dissipation Factor	14% 120Hz 20C
Ripple Current	1230 mAmps (120Hz 105C)
Leakage Current	770 uA (2min 20°C)
Impedance Ratio at -25C	3
Impedance Ratio at -40C	3