

# EKI-2525PA

# EKI-2528PAI

**5-port Industrial PoE Switch with 24/48 V<sub>DC</sub> Power Input**

**8-port Industrial PoE Switch with 24/48 V<sub>DC</sub> Power Input and Wide Temperature**



EKI-2525PA

EKI-2528PAI



## Features

- Provides 5/8 Fast Ethernet ports with 4 PoE ports with injector function
- Supports 10/100 Mbps Auto Negotiation
- Provides broadcast storm protection
- Supports Ethernet ESD protection
- Provides power line EFT protection
- Provides slim size, DIN-rail/Wall mount with IP30 metal mechanism
- Supports Redundant 24/48 V<sub>DC</sub> power input and P-Fail Relay
- Supports operating temperatures from -10 to 60°C (EKI-2525PA)
- Supports wide operating temperature -40 ~ 75°C (EKI-2528PAI)

## Introduction

The EKI-2525PA and EKI-2528PAI are a 5/8-port unmanaged PoE (Power-over-Ethernet) Industrial Ethernet switches that supports 4 PoE ports which are classified as power source equipment (PSE). These PoE devices make centralized power supply possible and provide up to 15.4 watts of power per port. Advantech EKI PoE devices can be used to power IEEE 802.3af compliant powered devices (PD) through Ethernet cable and eliminate the need for additional power wiring. Advantech EKI PoE devices come equipped with all the standard features of the EKI family. Furthermore, they offer a 24/48 V<sub>DC</sub> redundant power input design and is secured with a double protection mechanism; Power Polarity Reverse Protect and an Overload Current Resettable Fuse. Advantech EKI PoE devices come with compact metal housing that rates IP30 to help against from dusty industrial environments.

## Specifications

### Communications

- **Standard** IEEE 802.3, 802.3u, 802.3x, 802.3af
- **LAN** 10/100Base-T (X)
- **Transmission Distance** Up to 100 m
- **Transmission Speed** Up to 100 Mbps

### Interface

- **Connectors** PoE Ports: 4 (Ports 1 ~ 4)  
Ethernet ports: 1 (Port 5 ~ Port 8), EKI-2525PA  
Ethernet ports: 4 (Port 5 ~ Port 8), EKI-2528PAI  
6-pin removable screw terminal (power & relay)
- **LED Indicators** P1, P2, P-Fail  
10/100TX: Link/Activity, Duplex/Collision

### Power

- **Power Consumption** EKI-2525PA: 62.5 W (Full load PoE)  
EKI-2528PAI: 65 W (Full load PoE)
- **Power Input** 24/48 V<sub>DC</sub>, redundant dual inputs
- **Power Output** 15.4 W at 48 V (per PoE port)
- **Fault Output** 1 Relay Output

### Mechanism

- **Dimensions (W x H x D)** 48.6 x 140 x 95 mm (1.91" x 5.51" x 3.74")
- **Enclosure** IP30, Metal shell with solid mounting kits
- **Mounting** DIN-rail, Wall

### Protection

- **Reverse Polarity** Present
- **Overload current** Present

### Environment

- **Operating Temperature** -10 ~ 60°C (14 ~ 140°F) (EKI-2525PA)  
Wide temp. model -40 ~ 75°C (-40 ~ 167°F) (EKI-2528PAI)
- **Storage Temperature** -40 ~ 85°C (-40 ~ 185°F)
- **Operating Humidity** 5 ~ 95% (non-condensing)
- **Storage Humidity** 0 ~ 95% (non-condensing)
- **MTBF** 440,132 hours

### Certification

- **Safety** UL508
- **EMI** FCC Part 15 Subpart B Class A, EN 55022 Class A
- **EMS** EN 61000-4-2  
EN 61000-4-3  
EN 61000-4-4  
EN 61000-4-5  
EN 61000-4-6  
EN 61000-4-8
- **Shock** IEC 60068-2-27
- **Freefall** IEC 60068-2-32
- **Vibration** IEC 60068-2-6

## Dimensions

Unit: mm [inch]

### EKI-2525PA

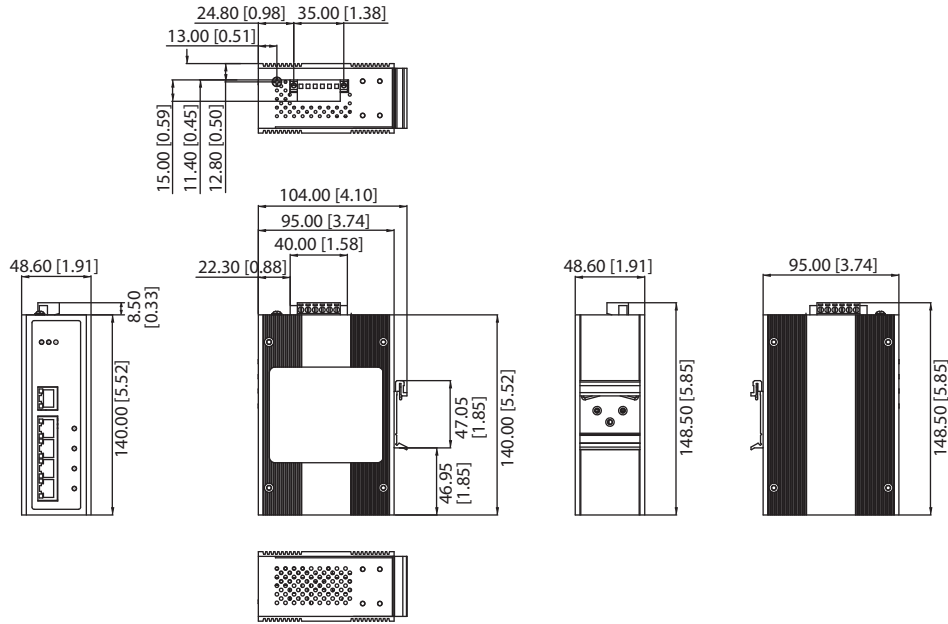

**Panel Cut-out Dimensions: 104 x 140 x 48.6 mm (4.1" x 5.52" x 1.91")**

### EKI-2528PAI

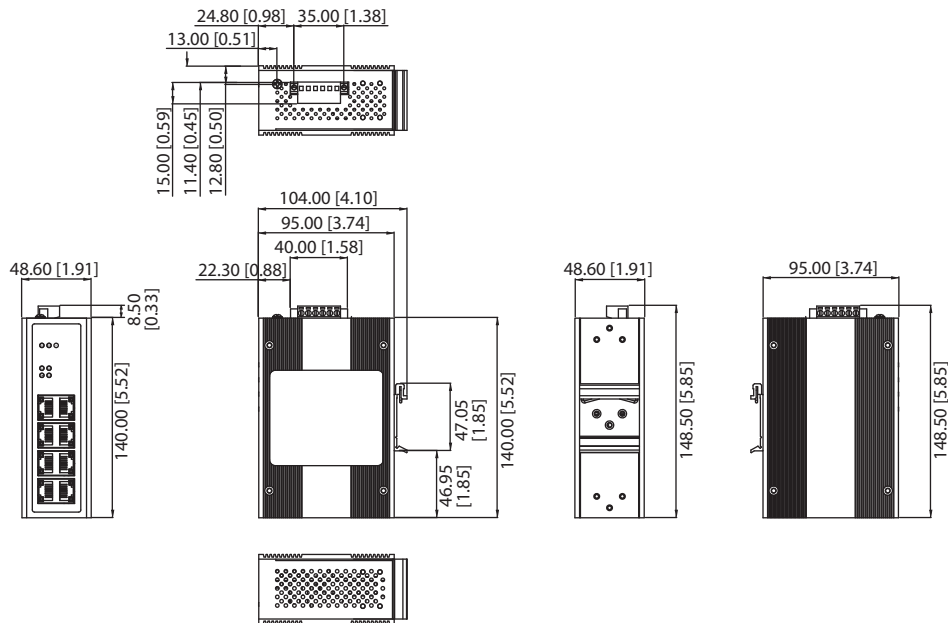

**Panel Cut-out Dimensions: 104 x 140 x 48.6 mm (4.1" x 5.52" x 1.91")**

## Ordering Information

- **EKI-2525PA** 5-port Switch with 4 port-PoE and 24/48 V<sub>DC</sub> Power Input
- **EKI-2528PAI** 8-port Switch with 4 port-PoE and 24/48 V<sub>DC</sub> Power Input (Wide Temp)