

Tous droits strictement réservés. Reproduction ou communication à des tiers interdite sous quelque forme que ce soit sans autorisation écrite du propriétaire. Propriété de FCI. Droits de reproduction FCI.

All rights strictly reserved. Reproduction or issue to third parties in any form whatever is not permitted without written authority from the proprietor. Property of FCI. Copyright FCI.

1 | 2

TABLE 2 CONTACTS

[XXX]B	CLIP PLATING	SHELL PLATING	PCB HOLE
001B	30u" GOLD OVER 50u" NICKEL	200u" TIN/LEAD OVER 100u" NICKEL	ø.026±.003
002B	30u" GOLD OVER 50u" NICKEL	10u" GOLD OVER 100u" NICKEL	ø.026±.003
011B	10u" GOLD OVER 50u" NICKEL	200u" TIN/LEAD OVER 100u" NICKEL	ø.026±.003
014B	100u" TIN/LEAD OVER 50u" NICKEL	200u" TIN/LEAD OVER 100u" NICKEL	ø.026±.003

3 |

TABLE 1

PART NUMBER DIP-[]-[XXX]B	DIMENSION				
	'A'	'B'	'C'	'D'	'E'
306	.200	2	.300	.195	.100
308	.300	3			
314	.600	6			
316	.700	7			
318	.800	8			
320	.900	9			
322	1.000	10			
324	1.100	11			
328	1.300	13			
624	1.100	11	.600	.420	.140
628	1.300	13			
632	1.500	15			
640	1.900	19			
648	2.300	23			

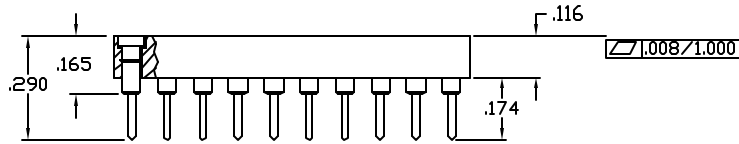
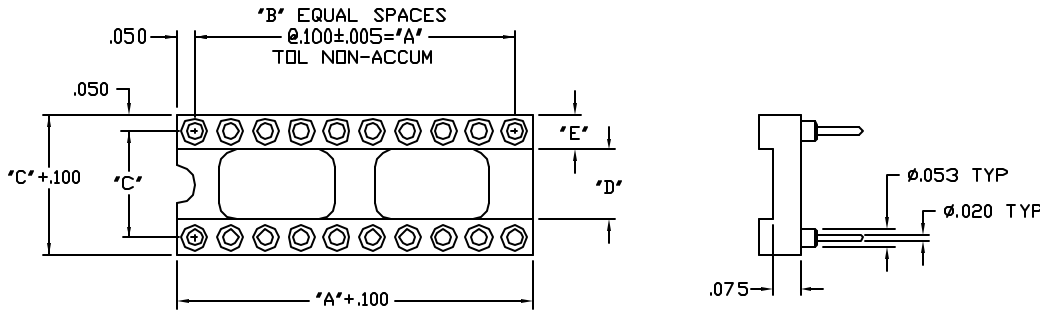

(DIP-320-[XXX]B SHOWN)

NOTES:

- PRODUCT NUMBERING CODE:
DIP-NNN-[XXX]B
 TOTAL NO. OF POSITIONS.
ROW TO ROW SPACING.
- INSULATOR MATERIAL:
POLYESTER MATERIAL (PBT) 30% GLASS REINFORCED,
RATED UL 94V-0, COLOR BLACK.
- CONTACT MATERIAL:
OUTER SHELL: BRASS ALLOY 360, 1/2 HARD PER QQ-B-626.
INNER CONTACT: BERYLLIUM COPPER, ALLOY 172 PER QQ-C-533.
- CONTACT PLATING:
GOLD PER MIL-G-45204, TYPE 1
GRADE C, NICKEL PER QQ-N-290.
TIN/LEAD PER MIL-P-81728, TYPE 1
- THESE P/N'S ARE OBSOLETE:
DIP-308-002B
DIP-324-002B
DIP-328-002B

PART NUMBER (SEE TABLES)
DIP-[]-[XXX]B

mat'l. code		tolerances unless otherwise specified		CUSTOMER COPY	www.fciconnect.com DIP SOCKETS .100 C/L
ltr	ecr no	dr	date	projection	
A	V00857	DLW	4/5/00		product family DIP size dwg no 58708
B	D10009	TB	7/5/01		
C	V05-0424	TAB	5/10/05	2:1	code 213
					sheet 1 of 1
sheet index	revision sheet	C	1		

cage code
22526

1 | 2

ACAD

3 |

4