

MAS-CON FEMALE THROUGH HIGH POWER, Series 156, 3,96mm

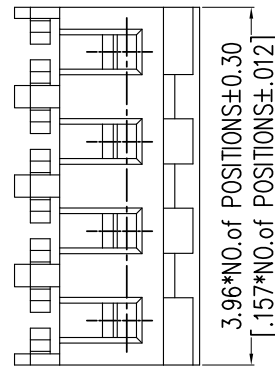
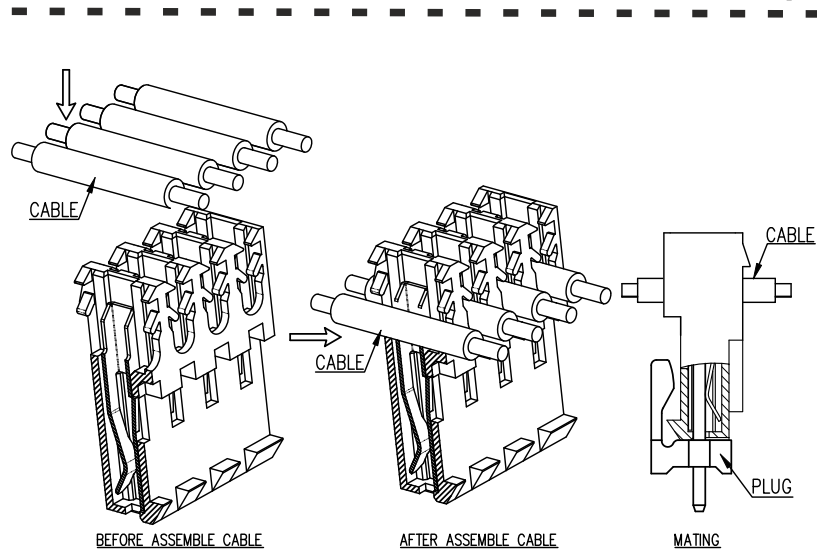
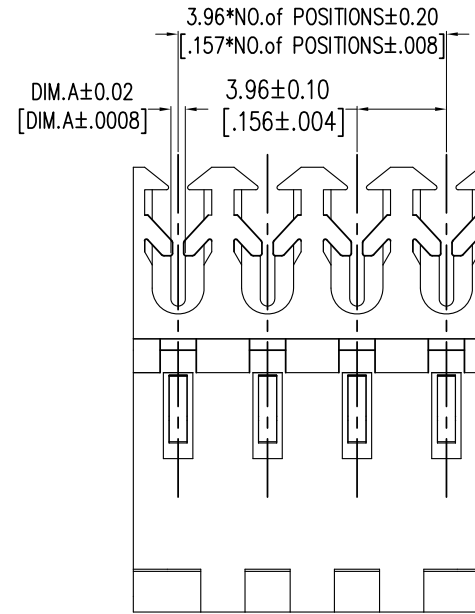
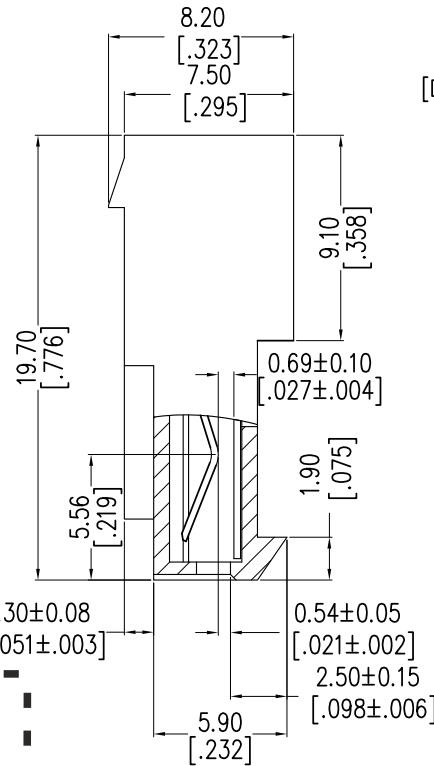
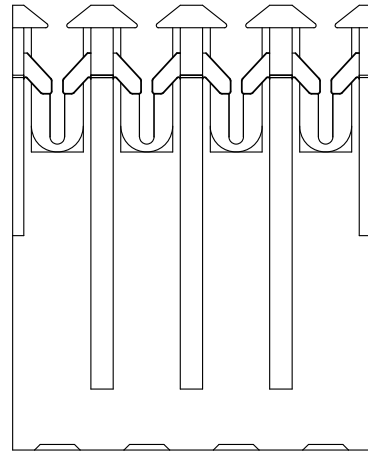

NOTES:
 Current Rating: 12,5 AMP
 Voltage Rating: 300V AC
 Contact Resistance: 10mΩ max.
 Withstand Voltage: 2200V AC/DC/Minute
 Insulation Resistance: 5000MΩ min.
 Operation Temperature: -55°C to +105°C

Contact Material: Copper Alloy
 Contact Plating: Sn over Ni (Au on request)
 Insulator Material: PA66 UL94 V-2

OPERATION	
X.X	±0.40
X.XX	±0.25
X.XXX	±0.15
Angle	± 3°
DIM	TOL

ORDERING INFORMATION				
Part No.	Wire Size	DIM A	AWG color	Current Rating
CTH156F18-02- D E	18 AWG	0,85	nature	12,5 A
CTH156F18-03- D E	18 AWG	0,85	nature	12,5 A
CTH156F18-04- D E	18 AWG	0,85	nature	12,5 A
CTH156F18-05- D E	18 AWG	0,85	nature	12,5 A
CTH156F18-06- C E	18 AWG	0,85	nature	12,5 A
CTH156F18-07- C E	18 AWG	0,85	nature	12,5 A
CTH156F18-08- C E	18 AWG	0,85	nature	12,5 A
CTH156F18-09- C E	18 AWG	0,85	nature	12,5 A
CTH156F18-10- C E	18 AWG	0,85	nature	12,5 A
CTH156F18-11- C E	18 AWG	0,85	nature	12,5 A
CTH156F18-12- C E	18 AWG	0,85	nature	12,5 A
CTH156F18-13- C E	18 AWG	0,85	nature	12,5 A
CTH156F18-14- C E	18 AWG	0,85	nature	12,5 A
CTH156F18-15- C E	18 AWG	0,85	nature	12,5 A
CTH156F18-16- C E	18 AWG	0,85	nature	12,5 A
CTH156F18-17- C E	18 AWG	0,85	nature	12,5 A
CTH156F18-18- C E	18 AWG	0,85	nature	12,5 A
CTH156F18-19- C E	18 AWG	0,85	nature	12,5 A
CTH156F18-20- C E	18 AWG	0,85	nature	12,5 A
CTH156F18-21- C E	18 AWG	0,85	nature	12,5 A
CTH156F18-22- C E	18 AWG	0,85	nature	12,5 A
CTH156F18-23- C E	18 AWG	0,85	nature	12,5 A
CTH156F18-24- C E	18 AWG	0,85	nature	12,5 A

REV	DATE	NOTE	NAME
3	05.11.2020	revised	JAL
2	21.01.2020	comp. revised	LAD
1	26.11.2019	issued	LAD