

Material:

Base: Nylon 46 UL 94V-0, Color Nature

Contact: Copper alloy with Tin plated

Tab: Copper alloy with Tin plated

**ORDERING CODE**

CI15 \*\* M 1 H R0  
 ① ② ③ ④ ⑤ ⑥

- ① Series No.
- ② Contacts: 02 to 13
- ③ M= SMT type header
- ④ Plating:  
 1= 100 $\mu$ " Min. Tin Plated  
 over 50 $\mu$ " Nickel
- ⑤ Type: H= Right angle
- ⑥ Other option:  
 R0= Tape & reel packing (Standard)  
 T0= Tube packing

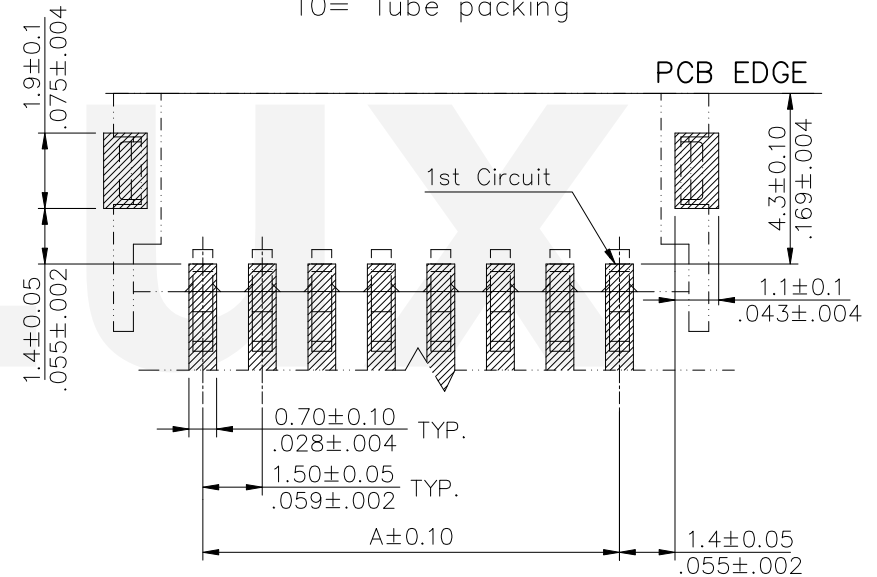
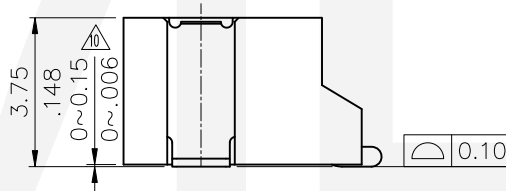
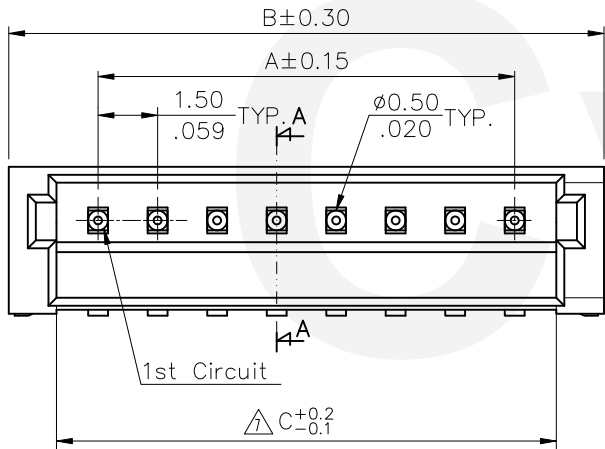
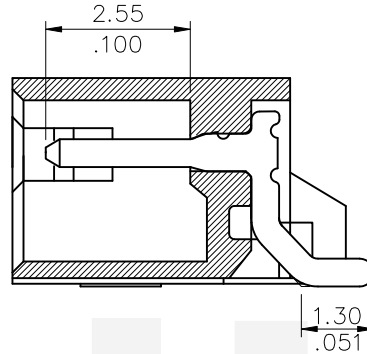
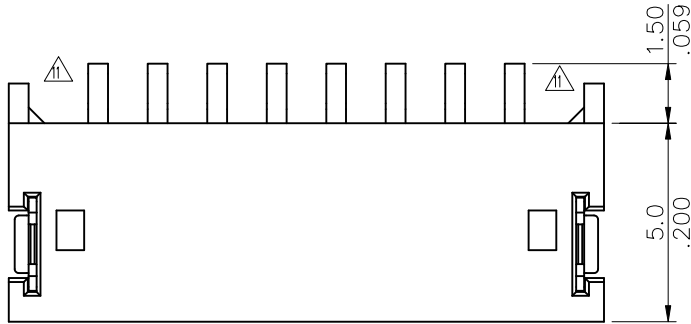

DIM. A = 1.50 x NO. OF SPACES

DIM. B = DIM. A + 4.5

DIM. C = DIM. A + 2.1

\* AVAILABLE IN 2 THROUGH 13 CIRCUITS

Tin-Lead Process      RoHS compliant

⑪	Yushu	9/11-19'	ECRQ119009/ECNT119310		DATE	UNIT: mm / inch	TITLE: 1.50MM(.059") Right Angle SMT Type Header	
⑩	Sun	7/05-16'	ECRH116023/ECNT116141		DRAWN BY: Yushu	TOLERANCE UNLESS OTHERWISE SPECIFIED	瀚荃股份有限公司 CviLux Corporation	
⑨	Enyo	9/11-13'	ECNT113054/ECRH113002		ENGINEER: Sun	12/12-19'		.X ± 0.30/.012    .X' ± 1'
⑧	Sun	9/22-11'	ECR11039-2/ECN11060		CHECKED BY: Eisley	12/12-19'		.XX ± 0.20/.008    .X' ±
SYM	NAME	DATE	REVISIONS		APPROVED BY: Eisley	12/12-19'		.XXX ± 0.10/.004    .XX' ±
							MATERIAL:	DRAWING NO. CI1501SK    PART NO. CI15**M1H*0
							FINISH:	SCALE 5 / 1    SHEET 1 OF 2

