

# CEP99 / CEP99B



## ◆ Outline

- Pulse transformer for Automobiles.

## ◆ Application

- Battery management system of automobiles

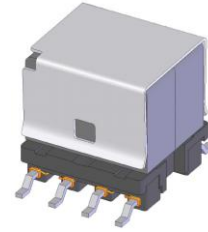

## ◆ Features

- SMD Type and 9mm square.
- High withstand Voltage : 2,500Vrms
- Operating temperature : - 40deg. ~ +125deg.

## ◆ Specifications

Item		Specification		Testing condition
		CEP99	CEP99B	
Inductance	(1-4)	Min. 618 $\mu$ H	Min. 1.62 mH	10 kHz, 20mV
Distributed Capacitance	(1-4)	Max. 5.2 pF	Max. 11.5 pF	CEP99 : 10 MHz, 20mV CEP99B : 5 MHz, 20mV
Interwinding Capacitance	(1~4-5~8)	Max. 2.5 pF	Max. 2.5 pF	CEP99 : 10 kHz, 20mV CEP99B : 100 kHz, 20mV
Leakage Inductance	(1-4)	Max. 28.6 $\mu$ H	Max. 67.6 $\mu$ H	CEP99 : 10 kHz, 20mV, (5~8)short CEP99B : 100 kHz, 20mV, (5~8)short
D.C.R.	(1-4)	Max. 1.34 ohm	Max. 2.06 ohm	at 20 deg.
Withstand Voltage	(1~4-5~8)	AC2,500V, 60sec		0.5mA, 50Hz/60Hz
Turn Ratio	(1-4:5-8)	1 : 1		-

## ◆ Dimension & Circuit (mm)

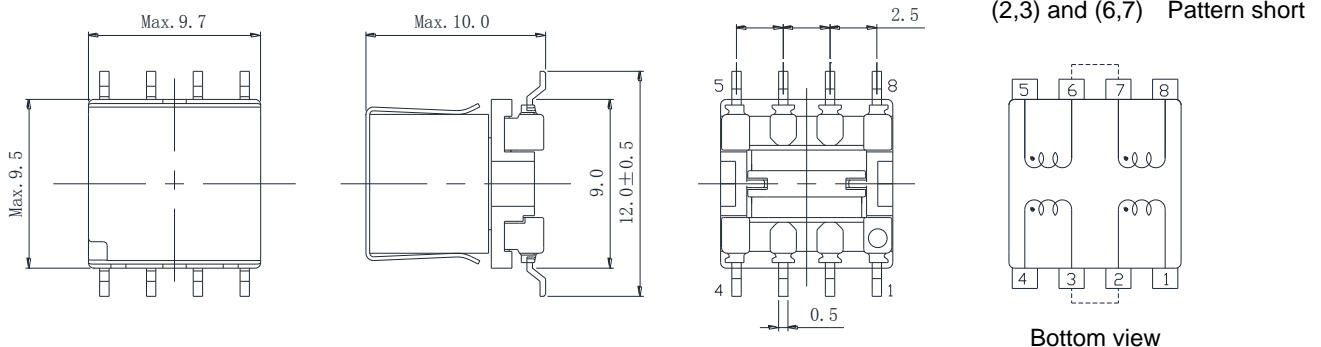

## ◆ Land Patterns (mm)

