

Film, Metallized Polypropylene, Power, C44A, 250 uF, 5%, 400 V, 250 V

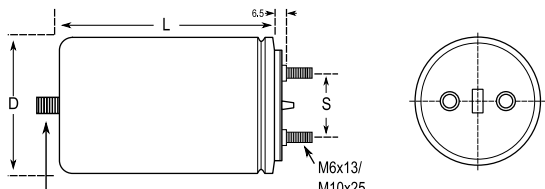

Threaded Mounting Stud  
 D < 55: M8x10  
 D >= 55: M12x12,5

**Dimensions**

<b>D</b>	85mm +/-0.5mm
<b>L</b>	150mm +/-2mm
<b>S</b>	35mm +/-0.5mm

**Packaging Specifications**

<b>Mounting:</b>	Bolt - M12x12.5
<b>Packaging:</b>	Bulk
<b>Packaging Quantity:</b>	9

**General Information**

<b>Dielectric:</b>	Metallized Polypropylene
<b>Style:</b>	Can
<b>Series:</b>	C44A
<b>RoHS:</b>	Yes
<b>Lead:</b>	Threaded Studs M10
<b>Miscellaneous:</b>	Thermal Resistance = 4 C/W

**Specifications**

<b>Capacitance:</b>	250 uF
<b>Capacitance Tolerance:</b>	5%
<b>Voltage DC:</b>	400 VDC
<b>Voltage AC:</b>	250 VAC
<b>Temperature Range:</b>	-40/+85C
<b>Rated Temperature:</b>	70C
<b>Max dVdt:</b>	10 V
<b>Resistance:</b>	4 mOhms (TYP)
<b>Current:</b>	32 Amps, 2500 Amps (Peak)