

RECOMMENDED PCB LAYOUT

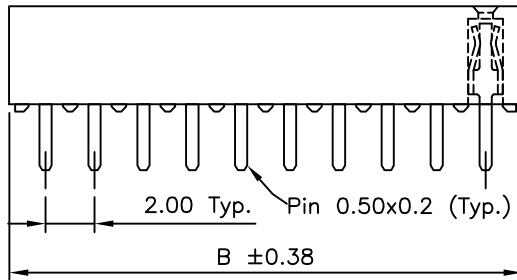
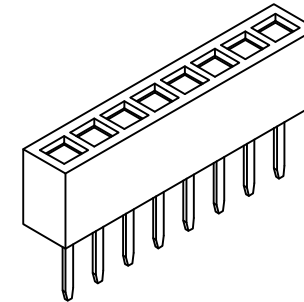
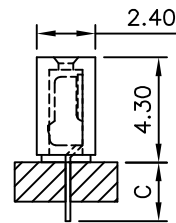

CONTACTS	DIMENSIONS	
	A	B
2	2.0	4.6
3	4.0	6.6
4	6.0	8.6
5	8.0	10.6
6	10.0	12.6
7	12.0	14.6
8	14.0	16.6
9	16.0	18.6
10	18.0	20.6
11	20.0	22.6
12	22.0	24.6
13	24.0	26.6
14	26.0	28.6
15	28.0	30.6
16	30.0	32.6
17	32.0	34.6
18	34.0	36.6
19	36.0	38.6
20	38.0	40.6
21	40.0	42.6
22	42.0	44.6
23	44.0	46.6
24	46.0	48.6
25	48.0	50.6
26	50.0	52.6
27	52.0	54.6
28	54.0	56.6
29	56.0	58.6
30	58.0	60.6
31	60.0	62.6
32	62.0	64.6
33	64.0	66.6
34	66.0	68.6
35	68.0	70.6
36	70.0	72.6
37	72.0	74.6
38	74.0	76.6
39	76.0	78.6
40	78.0	80.6

SPECIFICATIONS 规格

CURRENT RATING 电流额定值: 2 AMP
 INSULATOR RESISTANCE 绝缘电阻值: 1000 MEGOHMS MIN.
 CONTACT RESISTANCE 接触电阻值: 20 mOHMS MAX.
 DIELECTRIC WITHSTANDING 耐电压: AC 500 V
 OPERATING TEMPERATURE 工作温度: -40°C TO +105°C
 CONTACT MATERIAL 端子物料: PHOSPHOR BRONZE
 INSULATOR MATERIAL 绝缘体物料:
 STANDARD 标准物料: POLYAMIDE 聚酰胺, NYLON 6T, UL 94-V0
 OPTIONS 可选物料: POLYESTER 聚酯, LCP, UL 94-V0
 SOLDERING PROCESS 可焊性:
 NYLON 6T (STANDARD 标准物料) -
 IR REFLOW 回流焊: 260°C for 10 sec.
 WAVE 波峰焊: 230°C for 5-10 sec.
 MANUAL SOLDER 人工焊接: 350°C for 3-5 sec
 LCP (OPTION 可选物料) -
 IR REFLOW 回流焊: 260°C for 10 sec. Δ
 WAVE 波峰焊: 250°C for 5-10 sec.
 MANUAL SOLDER 人工焊接: 350°C for 3-5 sec Δ

MATES WITH 配套之母座 (SUBJECT TO PIN LENGTH 在端子长度适合的条件下):
 BF020 BF021 BF025 BF035 BF040
 BF130

Ordering Grid

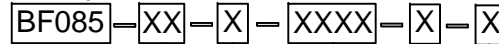

No. of Contacts: 02 to 40
 Contact Plating:
 A = Gold Flash All Over
 B = Selective Gold Flash Contact Area/
 Tin On Tail
 C = Tin All Over
 G = 10µ" Gold Contact Area/Tin On Tail
 I = 30µ" Gold Contact Area/Tin On Tail
Standard = Gold Flash All Over

Insulator Material:
 N = Nylon 6T (Standard)
 L = LCP

Dimension C (1/100mm)
 (Tail Length)
Standard - 2.40mm = 0240
 Or specify Dimension C
 e.g. 2.50mm = 0250
 TOL +/- 0.2mm Δ

Packing Options Δ
 D = Tube (Standard)
 E = Tube with Cap
 F = Tube with Film
 G = Plastic Box

REQUEST SAMPLES AND QUOTATION

By	LYH	PN	CB	DR	SA
DETAIL	DRAWING RELEASE	AMENDED TO VERTICAL ONLY	PACKING OPTIONS CHANGED	CHANGE TO SOLDER TEMP. INFORMATION	AMENDMENT TO STANDARD DIMENSIONS
REV DATE	A 31/10/07	B 09/03/09	C 27/04/09	D 05/08/09	E 08/12/09



Tolerances (Except as noted)	Part Number:-	Date:-
Dimensions in mm	BF085	31 OCT 07
X. ± 0.30		
X.X ± 0.20		
X.XX ± 0.15		
X.XXX ± 0.10		
X.° ± 5°		
X.° ± 2°		
XX° ± 1°		
XXX° ± 0.5°		
Third Angle Projection	Description:- 2.0mm PITCH SOCKET, SINGLE ROW, THROUGH HOLE, VERTICAL	
THIS DRAWING IS CONFIDENTIAL AND MUST NOT BE COPIED OR DISCLOSED WITHOUT WRITTEN CONSENT		

GCT

www.globalconnectortech.com

Scale	Revision	Material	Drawn by	Sheet No.
NTS	E	See Note	LYH	E & OE 1/1