

## TYPES TP AND BA

### VINYLU<sup>TM</sup>

Terminal — Polyvinylchloride Insulated, Ring Tongue

600 Volts Max., 105° C Max.

VINYLU<sup>TM</sup> Type TP is designed for commercial and light duty industrial control and power circuit applications. Supplied with an expanded polyvinyl chloride (PVC) insulation shroud, many tongue variations and rated 600V makes TP terminals versatile and economical.

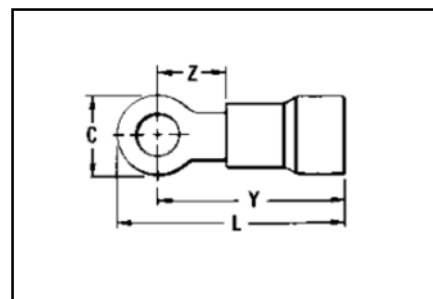
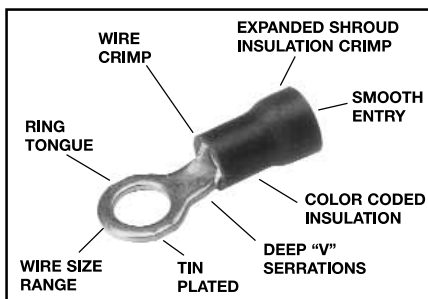

### Features and Benefits

- Expanded insulation support accepts standard and large wire diameters.
  - ◇ Lowers inventory requirements, permits greater flexibility and provides insulation support.
- Funnel entry.
  - ◇ Easy wire insertion.
- Manufactured of pure electrolytic copper.
  - ◇ Provides maximum conductivity, low resistance and ductility for excellent crimp forming properties.
- Deep V groove serrations in the inner barrel.
  - ◇ Provides added holding strength and better conductivity.
- Electro-tin plated.
  - ◇ Provides durable long-lasting corrosion resistance.

Catalog Number	Wire Range	Stud Size	Dimensions				Bulk Catalog Number*	Installation Tooling	Tape Mounted Catalog Number 2000/Reel	Installation Tooling	Wire Strip Length
			C	L	Y	Z					
TP16-4	22-16 Max. Insul. Dia. Accom.: .145 Color Code: Red	3-4	.22	.71	.61	.17	BA16E4	Plier Type: Y10-22, Y10D or Ratchet Tool: MR8-89-1, MR8-G96, MR15	BA16E4M	TFM with DFM3D-1 Die	13/64"
TP16-6		4-6	.25	.74	.62	.18	BA16E6		BA16E6M		
TP16-8		6-8	.31	.85	.70	.26	BA16E8		BA16E8M		
TP16-10		8-10	.31	.85	.70	.26	BA16E10		BA16E10M		
TP16-14		12, 1/4	.40	.99	.79	.36	BA16E14		BA16E14M		
TP16-38		3/8	.53	1.15	.88	.45	BA16E38		BA16E38M		
TP14-4	16-14 Max. Insul. Dia. Accom.: .180 Color Code: Blue	3-4	.22	.71	.61	.17	BA14E4	Plier Type: Y10-22, Y10D or Ratchet: MR8-89-1, MR8-G96, MR15	BA14E4M	TFM with DFM2D-1 Die	13/64"
TP14-6		4-6	.25	.74	.62	.18	BA14E6		BA14E6M		
TP14-8		6-8	.31	.85	.70	.26	BA14E8		BA14E8M		
TP14-10		8-10	.31	.85	.70	.26	BA14E10		BA14E10M		
TP14-14		12, 1/4	.40	.99	.79	.36	BA14E14		BA14E14M		
TP14-516		5/16	.53	1.15	.88	.45	BA14E516		BA14E516M		
TP14-38	3/8	.53	1.15	.88	.45	BA14E38	—				
TP10-6	12-10 Max. Insul. Dia. Accom.: .260 Color Code: Yellow	4-6	.31	.91	.75	.20	BA10E6	Plier Type: Y10-22, Y10D or Ratchet: MR8-89-1, MR15, M8ND w/N10HET-23	*BA10E6M	TFM with DFM1D5 Die	19/64"
TP10-8		6-8	.36	1.00	.81	.26	BA10E8		*BA10E8M		
TP10-10		8-10	.36	1.00	.81	.26	BA10E10		*BA10E10M		
TP10-14		12, 1/4	.53	1.22	.95	.40	BA10E14		*BA10E14M		
TP10-38		3/8	.53	1.27	1.00	.45	BA10E38		*BA10E38M		

\* 1000/Reel

Blue highlighted items are industry standard and most frequently ordered.