

**80**mm sq.

# San Ace 80

15mm thick, 20mm thick, 25mm thick  
 25mm thick (San Cooler), 32mm thick  
 38mm thick (GV type), 38mm thick (G type)



## General Specifications With a pulse sensor

With PWM speed control function

- Material..... Frame: Plastics (Flammability: UL94V-0),  
 Impeller: Plastics (Flammability: UL94V-1)
- Expected Life ..... Varies for each model (L10: Survival rate: 90% at 60°C,  
 rated voltage, and continuously run in a free air state)
- Lead Wire ..... ⊕red ⊖black (Sensor) yellow (Control) brown
- Storage Temperature ... -30°C to +70°C (Non-condensing)

**80×80×38mm** (Mass : 220g)

**GV type**

## Specifications

Model No.	Rated Voltage [V]	Operating Voltage Range [V]	PWM duty cycle※ [%]	Rated Current [A]	Rated Input [W]	Rated Speed [min <sup>-1</sup> ]	Max. Air Flow [m <sup>3</sup> /min] [CFM]	Max. Static Pressure [Pa] [inchH <sub>2</sub> O]	SPL [dB(A)]	Operating Temperature [°C]	Expected Life [h]
9GV0812P1M031	12	10.2 to 13.8	100	0.75	9	6,000	2.29 81.0	169.0 0.68	51	-10 to +70	40,000
			0	0.09	1.08	1,700	0.65 23.0	13.6 0.05	19		

※PWM Frequency : 25kHz

## Dimensions (Unit : mm)

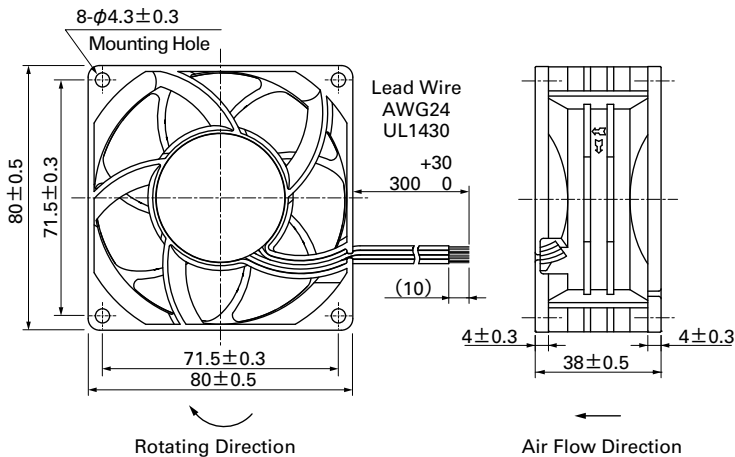

## Reference dimension of mounting holes and vent opening (Unit : mm)

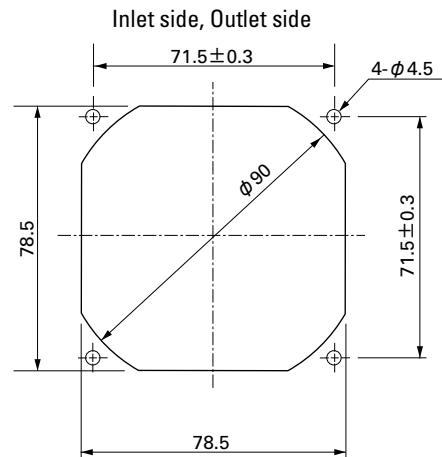

**Options (Unit : mm)**

**Finger guards**

Model : 109-049C Color : Nickel-chrome plating (silver)  
 Surface treatment : Nickel-chrome plating (silver)

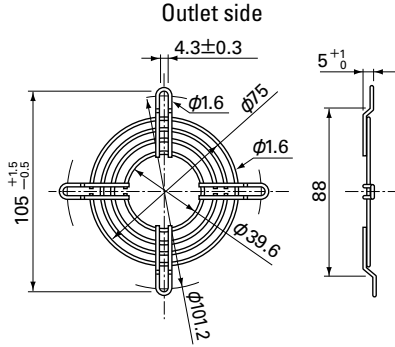

**Resin finger guards**

Model : 109-1002G

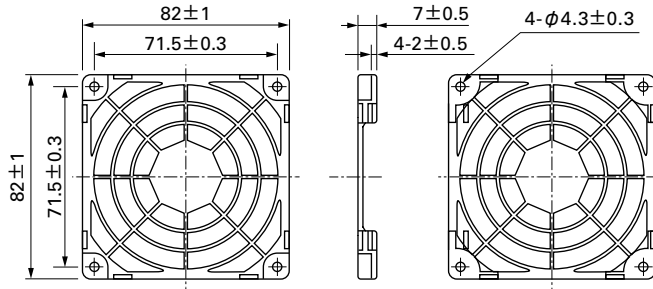

Model : 109-049E Color : Nickel-chrome plating (silver)  
 Surface treatment : Nickel-chrome plating (silver)  
 : 109-049H : Cation electropainting (black)

**Resin filter kits**

Model : 109-1002F13 (13PPI), 109-1002F20 (20PPI)  
 : 109-1002F30 (30PPI), 109-1002F40 (40PPI)

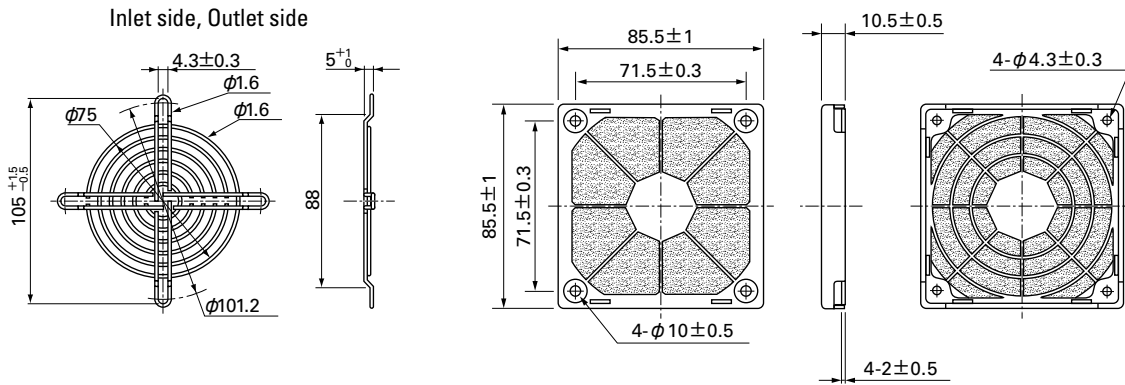

**Air Flow - Static Pressure Characteristics**

**PWM Duty Cycle**

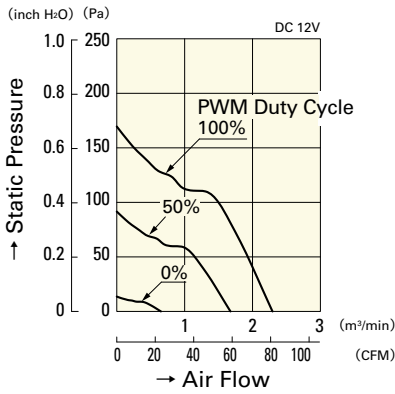

**9GV0812P1M031**

**Operating Voltage Range**

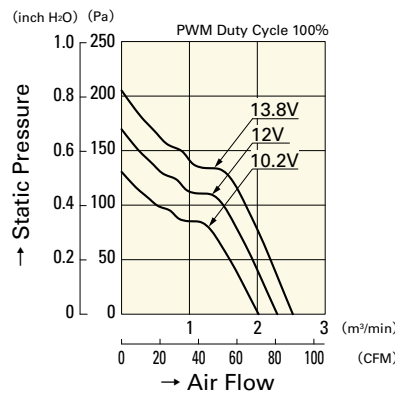

**9GV0812P1M031**

**PWM Duty - Speed Characteristics Example**

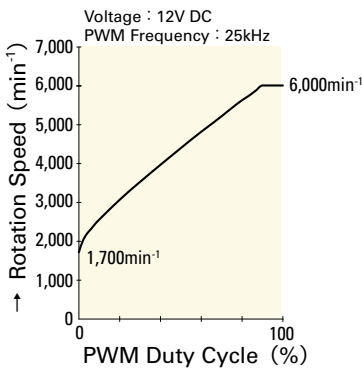

**9GV0812P1M031**