

THIS DRAWING IS UNPUBLISHED
 RELEASED FOR PUBLICATION 11. Dec, 1996.
 © COPYRIGHT 1996 BY AMP INCORPORATED. ALL RIGHTS RESERVED.

LOC	DIST	REVISIONS			
P	LTR	DESCRIPTION	DATE	DWN	APVD
AI	-				
A96-52310					

NOTES
Bemerkungen

- 1 AMP LOGO
AMP-Logo
- 2 AMP NUMBER
AMP-Nummer
- 3 MATERIAL MARKING
Werkstoffkennzeichnung
- 4 REVISION OF THE PART
Teileänderungsstand
- 5 PRODUCTION DATE
Produktionsdatum
- 6 CAVITY MARKING
Nestmarkierung
- 7 FOR INSULATION- ϕ : 4.0 - 5.2 mm
Für Isolations- ϕ :
- 8 FOR INSULATION- ϕ : 1.8 - 2.1 mm
Für Isolations- ϕ :
- 9 SUITABLE FOR PIN HOUSING PN 963006
AND SOCKET HOUSING PN 963008
Passend für Stiftgehäuse PN 963006
und Buchsengehäuse PN 963008
- SUITABLE PRESSURE PLATE: PN 968783
Passende Druckplatte:

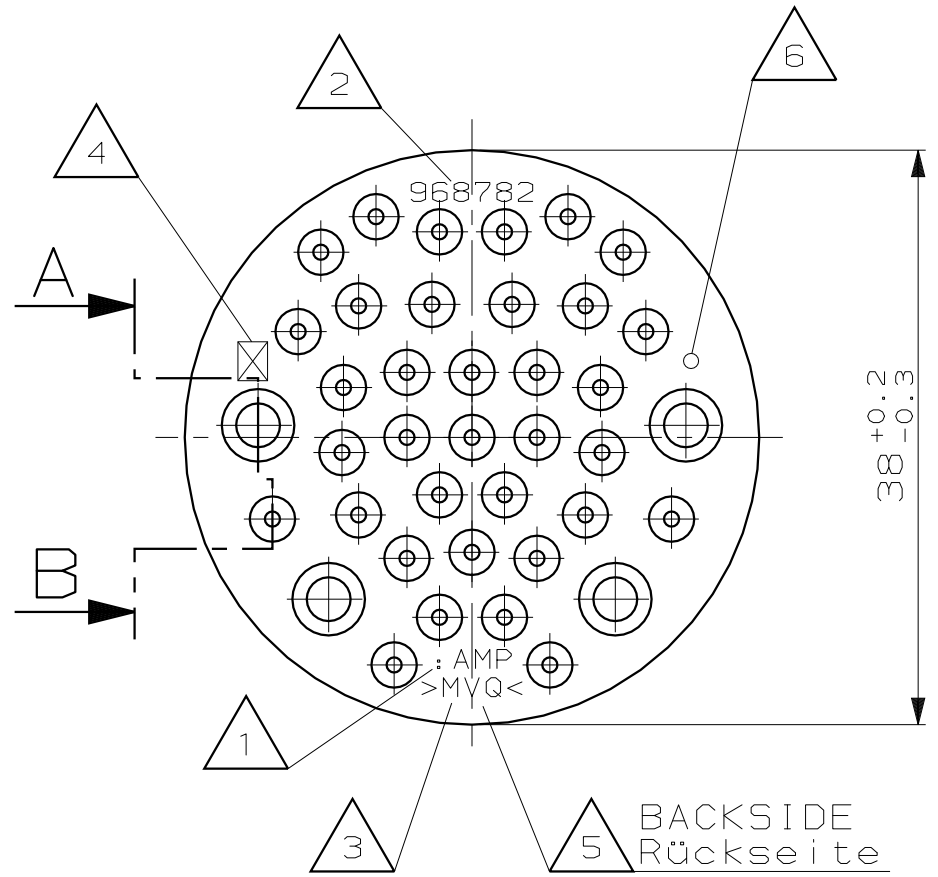

SECTION A-B
SCALE 5:1
Schnitt A-B
M 5:1

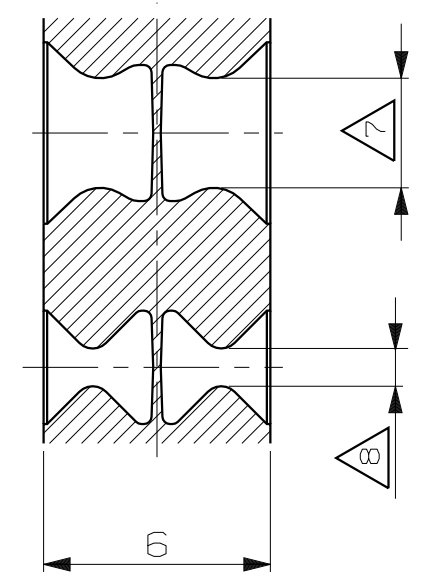

968782-1				THIS DRAWING IS A CONTROLLED DOCUMENT FOR AMP INCORPORATED. IT IS SUBJECT TO CHANGE AND THE CONTROLLING ENGINEERING ORGANIZATION SHOULD BE CONTACTED FOR THE LATEST REVISION.		DWN	K. Gerlach	27.11.96	AMP AMP Deutschland GmbH D - 63225 Langen							
				DIMENSIONS: mm		TOLERANCES UNLESS OTHERWISE SPECIFIED:		CHK		J. Granzow	29.11.96					
ORDER-NO. BESTELL-NR.		POS.	QTY. STÜCK	DESCRIPTION SINGLE PART BENENNUNG EINZELTEIL	MATERIAL	APVD		J. Hass	11.12.96	NAME	SEALING DISC FOR 39POS. CPC PIN-/SOCKET-HOUSING Dichtscheibe für 39pol. CPC Stift-/Buchsengehäuse					
SILICONE SHORE 30 A				ORANGE	PRODUCT SPEC		APPLICATION SPEC		SIZE	A3	CAGE CODE	00779	DRAWING NO	C-968782	RESTRICTED TO	DAF
CUSTOMER DRAWING						WEIGHT		SCALE		SHEET		OF		REV		
								2:1		1		1		A		