

PCB PIN POLARISATION
OPTION A AND B

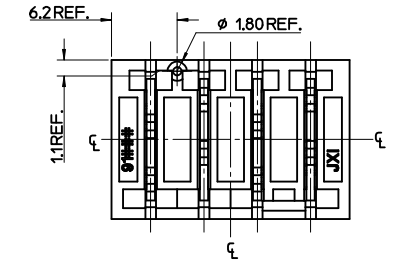
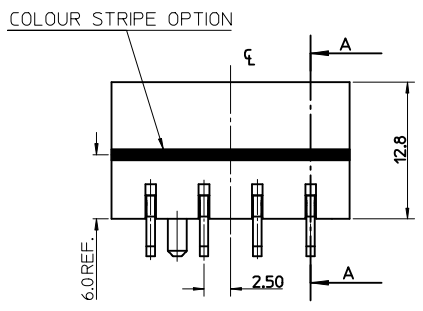
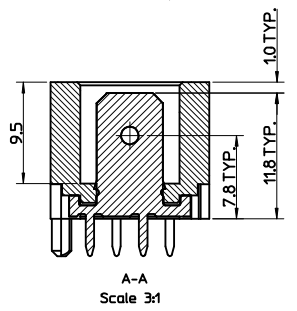
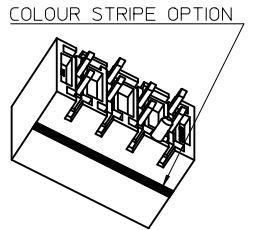
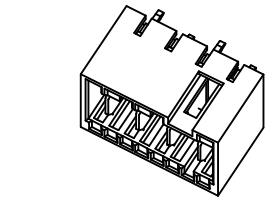
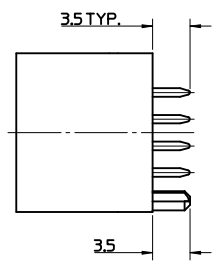

- NOTES:
- MATERIALS
HOUSING: PA 66, UL94 V-0 750°C GWT NO FLAME
TERMINAL: BRASS 0.80REF. THICK
PLATING: OPTIONAL (SEE CHARTS SHEETS 2-6)
54µm TIN OVER
2.54µm NICKEL ALLOVER
SELECTIVE SILVER
24µm MIN SILVER
3-54µm TIN OVER
2.54µm NICKEL ALLOVER
 - PRODUCT CONFORMS TO SPECIFICATION PS-99020-0037/39
 - MATES WITH MOLEX 91338, 90833, 90835, 91777, 91778, 91779, 91954 & 92000.
 - SEE PACKAGING SPECIFICATION PK-90858-001
TWO PACKAGING OPTIONS
"A" LOOSE IN POLYBAGS IN SHIPPING CARTON
"B" IN TUBES IN SHIPPING CARTON
SEE TABLES IN FOLLOWING SHEETS FOR PACKAGING TYPE FOR EACH PART NUMBER
 - PLATED THRU HOLE
 - NON-PLATED THRU HOLE
 - RECOMMENDED PCB THICKNESS: 1.4±0.1mm
 - PCB VIEW IS FROM SOLDER SIDE

CCT	DIM A	DIM B	DIM C	TOL
2	5.00	10.20	12.30	
3	10.00	15.20	17.30	
4	15.00	20.20	22.30	
5	20.00	25.20	27.30	
6	25.00	30.20	32.30	
7	30.00	35.20	37.30	
8	35.00	40.20	42.30	
9	40.00	45.20	47.30	
10	45.00	50.20	52.30	
11	50.00	55.20	57.30	
12	55.00	60.20	62.30	

OPTION "C"

PCB LAYOUT

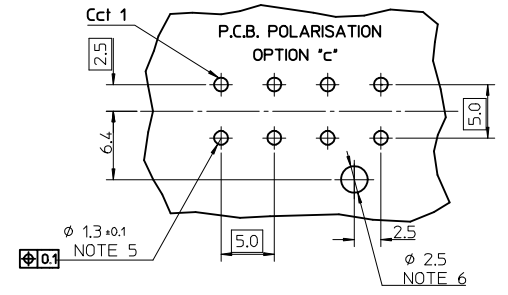
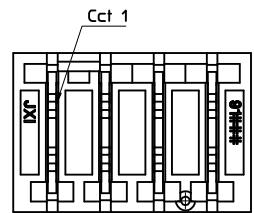

OPTION "B"

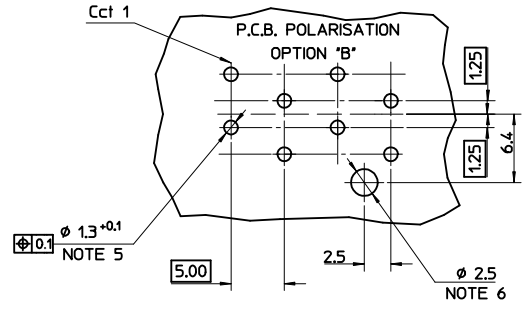
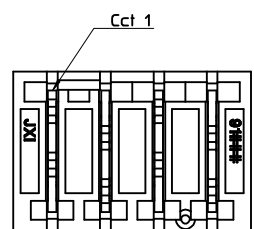

OPTION "A"

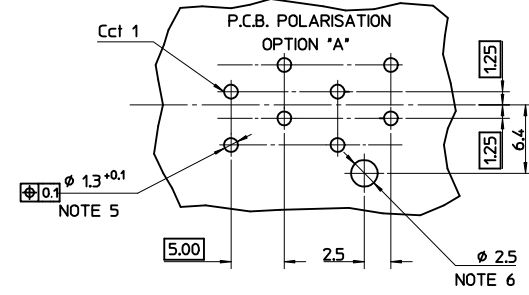
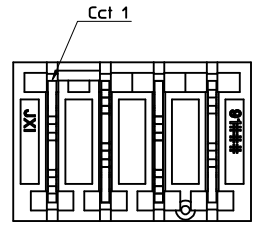

ADDED COLOUR LINE OPTION A, B, C
EC NO: E2003-0594
DRAWN: BRUTTLE 2009/06/03
CHKD: T. TOURSH 2009/06/03
APPR: BMAGUIRE 2009/06/04

QUALITY SYMBOLS
 = 0
 = 0.1
 = 0.2

GENERAL TOLERANCES (UNLESS SPECIFIED)

	mm	INCH
4 PLACES	± 0.1	± 0.004
3 PLACES	± 0.15	± 0.006
2 PLACES	± 0.2	± 0.008
1 PLACE	± 0.25	± 0.010

ANGULAR ± 2°

DRAFT WHERE APPLICABLE MUST REMAIN WITHIN DIMENSIONS

DIMENSION STYLE
MM ONLY

DRAWN BY B. RUTTLE
DATE 2006/10/04

CHECKED BY T. TOURSH
DATE 2006/10/04

APPROVED BY BMAGUIRE
DATE 2006/10/04

MATERIAL NO.

SCALE 1:1
DESIGN UNITS METRIC
THIRD ANGLE PROJECTION

TITLE
RAST 5 VERT HDR
PA 66 HOUSING

MOLEX MOLEX INCORPORATED

DOCUMENT NO. SD-91999-001
SHEET NO. 1 OF 6

THIS DRAWING CONTAINS INFORMATION THAT IS PROPRIETARY TO MOLEX INCORPORATED AND SHOULD NOT BE USED WITHOUT WRITTEN PERMISSION

2 CIRCUIT		SEE CODE DESIGNATION TABLE FOR NUMBERING FORMAT WHEN ADDING NEW PART NUMBERS						P.C.B. POLARISATION OPTION	PACKAGING OPTION *	COLOUR STRIPE
PART NO. (TIN)	COLOUR	UNBLOCKED POSITION KEYS	UNBLOCKED CODING KEYS	LATCH POSITION	CONFIGURATION (SEE NOTES)	REF	PART NO. (SILVER)			
91999-0003	NATURAL	1b 2a	01c d20	1/2		K01	91999-0499	A	A	NONE
91999-0004	NATURAL	1a 2b	01c	1/2		K02	91999-0482	A		
91999-0007	NATURAL	1b 2b	01c	1/2		K09	91999-0497	A		
91999-0018	NATURAL	2a	01c, d20	1/2		K03	91999-0495	A		
91999-0019	NATURAL	1a 2b	d20	1/2		K05	91999-0478	A		
91999-0021	NATURAL	1b	01c, d20	1/2		K16	91999-0492	A		
91999-0022	NATURAL	1a 2b	NONE	1/2		K06	91999-0491	A		
91999-0027	NATURAL	2b	NONE	1/2		K11	91999-0487	A		
91999-0029	NATURAL	1a 1b	d20	1/2		K13	91999-0486	A		
91999-0030	NATURAL	2a 2b	NONE	1/2		K31	91999-0485	A		
91999-0032	NATURAL	2b	d20	1/2		K38	91999-0484	A		
91999-0047	NATURAL	1a 2a	01c d20	1/2		K44	91999-0483	A		
91999-0055	NATURAL	1a 1b	NONE	1/2		K40	91999-0480	A		
91999-0020	NATURAL	1a 1b	01c	1/2		K04	91999-0475	A		
91999-0054	NATURAL	2b	01c d20	1/2		K15	91999-0476	A		
91999-0057	NATURAL	1a	01c d20	1/2		K12	91999-0477	A		
91999-0058	NATURAL	1a 2a	01c	1/2		K10	91999-0472	A		
91999-0059	NATURAL	ALL	d20	1/2		K34	91999-0474	A		
91999-0060	NATURAL	1b 2a 2b	d20	1/2		K07	91999-0473	A		
91999-0061	NATURAL	1b 2a	01c d20	1/2		K01	91999-0471	B		
91999-0062	NATURAL	2a	01c	1/2		K42	91999-0470	A		
91999-0063	NATURAL	1b, 2a	d20	1/2		K46	91999-0469	A		
91999-0064	NATURAL	1a, 2b	01c, d20	1/2		K48	91999-0468	A	A	NONE

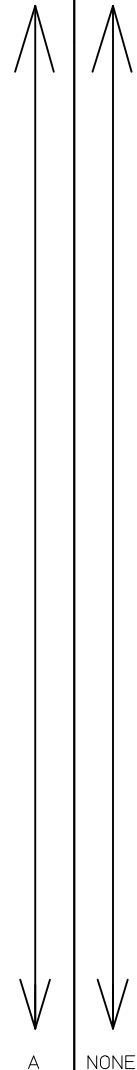

2 CIRCUIT		SEE CODE DESIGNATION TABLE FOR NUMBERING FORMAT WHEN ADDING NEW PART NUMBERS						P.C.B. POLARISATION OPTION	PACKAGING OPTION *	COLOUR STRIPE
PART NO. (TIN)	COLOUR	UNBLOCKED POSITION KEYS	UNBLOCKED CODING KEYS	LATCH POSITION	CONFIGURATION (SEE NOTES)	REF	PART NO. (SILVER)			
91999-0065	NATURAL	1b 2a	01c d20	1/2		K01	91999-0467	A	B	NONE
91999-0066	NATURAL	1a 2b	01c	1/2		K02	91999-0466	A	B	NONE
91999-0067	NATURAL	ALL	ALL	1/2		K00	91999-0465	A	A	NONE
91999-0068	NATURAL	1a 2b	01c	1/2		K02	91999-0464	A	B	RED
91999-0069	NATURAL	1a	01c	1/2		K57	91999-0463	A	A	NONE
91999-0070	NATURAL	2a 2b	01c	1/2		K32	91999-0462	A	B	NONE

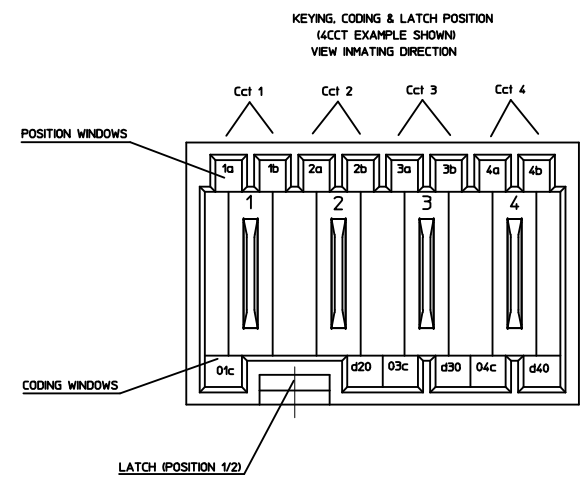

NOTES:
* SEE SHEET 1 NOTE 4

SEE SHEET 1 E.C. NO: E2009-0594 DRW: BRITTLE 2009/06/03 CHKD: TOURSH 2009/06/03 APPR: BMAGUIRE 2009/06/04	QUALITY SYMBOLS	GENERAL TOLERANCES (UNLESS SPECIFIED)	DIMENSION STYLE	SCALE	DESIGN UNITS	THIRD ANGLE PROJECTION
	$\nabla=0$ $\nabla=0$	mm INCH 4 PLACES ± --- ± --- 3 PLACES ± --- ± --- 2 PLACES ± 0.1 ± --- 1 PLACE ± 0.2 ± --- ANGULAR ± 2°	MM ONLY DRAWN BY DATE B. RUTLE 2006/10/04 CHECKED BY DATE T. TOURSH 2006/10/04 APPROVED BY DATE BMAGUIRE 2006/10/04	1:1	METRIC	
	DRAFT WHERE APPLICABLE MUST REMAIN WITHIN DIMENSIONS	SEE CHART	TITLE RAST 5 VERT HDR PA 66 HOUSING			
			MATERIAL NO. DOCUMENT NO. SD-91999-001 SHEET NO. 2 OF 6			

MOLEX INCORPORATED

THIS DRAWING CONTAINS INFORMATION THAT IS PROPRIETARY TO MOLEX INCORPORATED AND SHOULD NOT BE USED WITHOUT WRITTEN PERMISSION

3 CIRCUIT		SEE CODE DESIGNATION TABLE FOR NUMBERING FORMAT WHEN ADDING NEW PART NUMBERS					P.C.B. POLARISATION OPTION	PACKAGING OPTION *	COLOUR STRIPE
PART NO. (TIN)	COLOUR	UNBLOCKED POSITION KEYS	UNBLOCKED CODING KEYS	LATCH POSITION	CONFIGURATION (SEE NOTES)	REF	PART NO. (SILVER)		
91999-0502	NATURAL	1b	01c, d20	1/2		K01	91999-1249	A	
91999-0508	NATURAL	1a	03c	1/2		K04	91999-1248	A	
91999-0511	NATURAL	1a 1b	d30	1/2		K05	91999-1247	A	
91999-0512	NATURAL	1a 3b	01c	1/2		K06	91999-1246	A	
91999-0513	NATURAL	1b	d20 03c	1/2		K09	91999-1245	A	
91999-0524	NATURAL	1b 2a 2b	d30	1/2		K33	91999-1244	A	
91999-0525	NATURAL	2b	d20	1/2		K56	91999-1243	A	
91999-0528	NATURAL	ALL	d10 d30	2/3		K38	91999-1242	A	
91999-0527	NATURAL	ALL	d20	1/2		K40	91999-1240	A	
91999-0526	NATURAL	2b 3b	d10 02c	2/3		K02	91999-1241	A	
91999-0529	NATURAL	1b	01c d20	1/2		N/A	91999-1239	A	
91999-0530	NATURAL	2b 3b	ALL	2/3		k145	91999-1238	A	
91999-0531	NATURAL	3b	01c d30	2/3		k10	91999-1237	A	
91999-0532	NATURAL	3b	d10, 02c	2/3		N/A	91999-1236	A	
91999-0533	NATURAL	2b 3b	ALL	2/3		k145	91999-1235	A	
91999-0534	NATURAL	ALL	ALL	1/2		k00	91999-1234	A	
91999-0506	NATURAL	1a 3a	d20	1/2		k43	91999-1233	A	
91999-0507	NATURAL	2a	d10 d30	2/3		k44	91999-1232	A	
91999-0535	NATURAL	3b	d10 d30	2/3		N/A	91999-1231	A	
91999-0536	NATURAL	1b	01c	1/2		N/A	91999-1230	A	

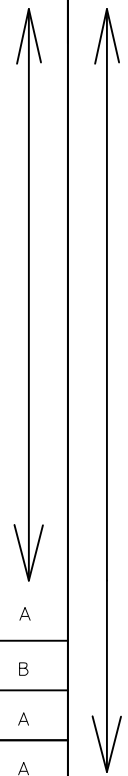

NOTES:
* SEE SHEET 1 NOTE 4

SEE SHEET 1 E.C. NO: E2009-0594 DRAWN: BRUTLE 2009/06/03 CHECKED: TOURSH 2009/06/03 APPROVED: BMAGUIRE 2009/06/04	QUALITY SYMBOLS	GENERAL TOLERANCES (UNLESS SPECIFIED)	DIMENSION STYLE	SCALE	DESIGN UNITS	THIRD ANGLE PROJECTION
	$\nabla=0$ $\nabla=0$	mm INCH 4 PLACES ± --- ± --- 3 PLACES ± --- ± --- 2 PLACES ± 0.1 ± --- 1 PLACE ± 0.2 ± --- ANGULAR ± 2°	MM ONLY DRAWN BY DATE B. RUTLE 2006/10/04 CHECKED BY DATE T. TOURSH 2006/10/04 APPROVED BY DATE BMAGUIRE 2006/10/04	1:1	METRIC	RAST 5 VERT HDR PA 66 HOUSING
	DRAFT WHERE APPLICABLE MUST REMAIN WITHIN DIMENSIONS	SEE CHART MATERIAL NO. SD-91999-001	MOLEX INCORPORATED DOCUMENT NO. SD-91999-001	SHEET NO. 3 OF 6	THIS DRAWING CONTAINS INFORMATION THAT IS PROPRIETARY TO MOLEX INCORPORATED AND SHOULD NOT BE USED WITHOUT WRITTEN PERMISSION	

4 CIRCUIT		SEE CODE DESIGNATION TABLE FOR NUMBERING FORMAT WHEN ADDING NEW PART NUMBERS					P.C.B. POLARISATION OPTION	PACKAGING OPTION *	COLOUR STRIPE
PART NO. (TIN)	COLOUR	UNBLOCKED POSITION KEYS	UNBLOCKED CODING KEYS	LATCH POSITION	CONFIGURATION (SEE NOTES)	REF	PART NO. (SILVER)		
91999-1254	NATURAL	1b	03c d40	1/2 3/4		K01	91999-1999	A	
91999-1264	NATURAL	1a 4b	d40	1/2 3/4		K03	91999-1998	A	
91999-1265	NATURAL	2a 4b	d20	1/2 3/4		K07	91999-1996	A	
91999-1267	NATURAL	1b 2a 3a 4b	01c d40	1/2 3/4		K37	91999-1994	A	
91999-1270	NATURAL	1a 2b 4b	01c 03c d40	1/2 3/4		K44	91999-1993	A	
91999-1274	NATURAL	1a 3a 3b	01c d20 d40	1/2 3/4		K32	91999-1992	A	
91999-1275	NATURAL	1b 2a 4b	01c d20 03c	1/2 3/4		K61	91999-1991	A	
91999-1276	NATURAL	1a 3a	d40	1/2 3/4		K06	91999-1987	A	
91999-1280	NATURAL	1a 2b 3b 4a	01c 03c d40	1/2 3/4		K65	91999-1988	A	
91999-1281	NATURAL	2a 4b	d20 03c	1/2 3/4		K30	91999-1986	A	
91999-1282	NATURAL	3b	d30	2/3		K04	91999-1985	A	
91999-1283	NATURAL	1b 2a 4b	ALL	1/2 3/4		N/A	91999-1984	A	
91999-1284	NATURAL	2a 3a 3b 4b	ALL	1/2 3/4		N/A	91999-1983	A	
91999-1285	NATURAL	2a 2b 3b 4b	ALL	1/2 3/4		k153	91999-1982	A	
91999-1286	NATURAL	2a 2b 3b 4b	ALL	1/2 3/4		k153	91999-1981	A	
91999-1287	NATURAL	1a, 4b	01c	1/2 3/4		k02	91999-1980	A	
91999-1288	NATURAL	1b, 2b, 3b, 4a	01c 03c d40	1/2 3/4		k--	91999-1979	A	
91999-1289	NATURAL	1b	03c d40	1/2 3/4		k01	91999-1978	C	
91999-1290	NATURAL	1b 2a 2b 3a 4a 4b	03c d40	1/2 3/4		k12	91999-1977	A	
91999-1291	NATURAL	ALL	ALL	1/2 3/4		k00	91999-1976	A	
91999-1292	NATURAL	1b 2a 3a 4a	01c d20 03c	1/2 3/4		k83	91999-1975	A	
91999-1293	NATURAL	1b 2b 3b 4a	01c 03c d40	1/2 3/4		k120	91999-1974	A	
91999-1294	NATURAL	1a 2a 2b 3a 3b 4a 4b	NONE	1/2 3/4		k102	91999-1973	A	
91999-1295	NATURAL	1b 3b 4b	01c d20 03c	1/2 3/4		k85	91999-1972	A	

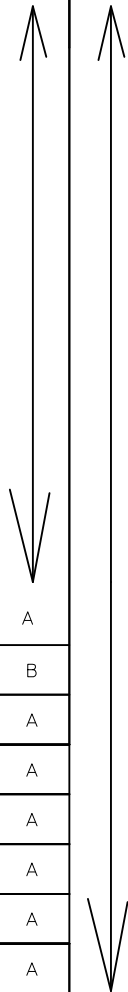

SEE SHEET 1 EC NO: E2009-0594 DRAWN BY: DRW:BRUTLE CHKD: TOURSH APPR: BMAGUIRE 2009/06/03 2009/06/04	QUALITY SYMBOLS	GENERAL TOLERANCES (UNLESS SPECIFIED)	DIMENSION STYLE	SCALE	DESIGN UNITS	THIRD ANGLE PROJECTION
	$\nabla=0$ $\nabla=0$	mm INCH 4 PLACES ± --- ± --- 3 PLACES ± --- ± --- 2 PLACES ± 0.1 ± --- 1 PLACE ± 0.2 ± --- ANGULAR ± 2 °	M M ONLY	1:1	METRIC	
	DRAWN BY: B. RUTLE DATE: 2006/10/04 CHECKED BY: DATE: 2006/10/04 APPROVED BY: T. TOURSH DATE: 2006/10/04 MATERIAL NO: BMAGUIRE DATE: 2006/10/04	TITLE: RAST 5 VERT HDR PA 66 HOUSING		MOLEX INCORPORATED		
	DRAFT WHERE APPLICABLE MUST REMAIN WITHIN DIMENSIONS		SEE CHART		DOCUMENT NO: SD-91999-001	

THIS DRAWING CONTAINS INFORMATION THAT IS PROPRIETARY TO MOLEX INCORPORATED AND SHOULD NOT BE USED WITHOUT WRITTEN PERMISSION

5 CIRCUIT										SEE CODE DESIGNATION TABLE FOR NUMBERING FORMAT WHEN ADDING NEW PART NUMBERS		P.C.B. POLARISATION OPTION	PACKAGING OPTION *	COLOUR STRIPE
PART NO. (TIN)	COLOUR	UNBLOCKED POSITION KEYS	UNBLOCKED CODING KEYS	LATCH POSITION	CONFIGURATION (SEE NOTES)	REF	PART NO. (SILVER)							
91999-2000	NATURAL	1a 5b	01c d30	1/2 2/3		K01	91999-2749	A		↑	↑	NONE		
91999-2001	NATURAL	1a 3a	01c d30	1/2 4/5		K30	91999-2748	A						
91999-2002	NATURAL	1a 5b	01c d20 03c d50	1/2 3/4		K31	91999-2747	A						
91999-2003	NATURAL	1b 2a 3b 5a	01c 03c	1/2 3/4		K35	91999-2746	A						
91999-2004	NATURAL	1a 2a 2b 4b 5b	01c d30 04c d50	1/2 2/3 4/5		K36	91999-2745	A						
91999-2006	NATURAL	2a	01c d50	2/3 4/5		K43	91999-2742	A						
91999-2012	NATURAL	2a 4b	01c d20 d40	1/2 3/4		K44	91999-2743	A						
91999-2013	NATURAL	2b	d20	1/2 4/5		K02	91999-2741	A						
91999-2014	NATURAL	4b 5a	01c d30 04c d50	1/2 4/5		K45	91999-2740	A						
91999-2015	NATURAL	NONE	01c d40	1/2 3/4		K46	91999-2739	A						
91999-2017	NATURAL	1a 4a	d30	1/2 4/5		K04	91999-2737	A						
91999-2024	NATURAL	1a 5b	d20 d40	1/2 3/4		K77	91999-2732	A						
91999-2025	NATURAL	2b	d20 d50	1/2 3/4		K95	91999-2733	A						
91999-2026	NATURAL	1a 5b	01c d20 03c d50	1/2 3/4		N/A	91999-2734	A						
91999-2027	NATURAL	1a 3a 4b 5a	03c 04c	1/2 4/5		K73	91999-2735	A						
91999-2028	NATURAL	2b	d20	1/2 4/5		N/A	91999-2731	A						
91999-2029	NATURAL	1b 2a 4a	01c 04c d50	1/2 4/5		K51	91999-2730	A						
91999-2030	NATURAL	2b 3b 4a	01c d20 d40	1/2 3/4		K52	91999-2729	A						
91999-2031	NATURAL	1a 5b	01c d20 03c d50	1/2 4/5		K86	91999-2728	A						
91999-2032	NATURAL	1a 1b 4a	d30 04c d50	1/2 4/5		K64	91999-2727	A						
91999-2033	NATURAL	1a 5b	01c d20 03c d50	1/2 3/4		N/A	91999-2726	B						
91999-2034	NATURAL	1a 3a	01c d30	1/2 4/5		K30	91999-2725	C						
91999-2035	NATURAL	ALL	ALL	1/2 4/5		K90	91999-2724	A						

NOTES:
* SEE SHEET 1 NOTE 4

6 CIRCUIT										SEE CODE DESIGNATION TABLE FOR NUMBERING FORMAT WHEN ADDING NEW PART NUMBERS		P.C.B. POLARISATION OPTION	PACKAGING OPTION *	COLOUR STRIPE
PART NO. (TIN)	COLOUR	UNBLOCKED POSITION KEYS	UNBLOCKED CODING KEYS	LATCH POSITION	CONFIGURATION (SEE NOTES)	REF	PART NO. (SILVER)							
91999-2753	NATURAL	1b	03c d60	1/2 4/5		K01	91999-3499	A		↑	↑	NONE		
91999-2754	NATURAL	1a 3b 4b	01c d50 06c	1/2 4/5		K30	91999-3498	A						
91999-2755	NATURAL	1a 1b 2b 3a 3b 4b	d30 04c d50	1/2 2/3 4/5		K37	91999-3497	A						
91999-2756	NATURAL	1a 1b 4a 4b	d10 d50	2/3 4/5		K39	91999-3496	A						
91999-2757	NATURAL	2a 4b 5a 6b	d20 03c 05c	1/2 3/4 5/6		K42	91999-3495	A						
91999-2758	NATURAL	1a 2b 3a 3b 5b 6b	01c d40 d60	1/2 3/4 5/6		K43	91999-3494	A						
91999-2759	NATURAL	1b 2a 3a 4b 5a 5b 6b	01c 03c d60	1/2 3/4 5/6		K44	91999-3493	A						
91999-2761	NATURAL	2b	d20 d60	1/2 5/6		K46	91999-3492	A						
91999-2762	NATURAL	2b 3b 4a	01c d50 06c	1/2 4/5		K36	91999-3491	A						
91999-2768	NATURAL	1b 4b	d20 03c d50 06c	1/2 4/5		K58	91999-3486	A						
91999-2769	NATURAL	1a 2b 3b 4a 6b	01c 03c d40 05c d60	1/2 3/4 5/6		K59	91999-3485	A						
91999-2770	NATURAL	1a 2b 4a 6b	01c d40	1/2 3/4 5/6		K62	91999-3484	A						
91999-2771	NATURAL	1b 6b	d40	1/2 5/6		K04	91999-3483	A						
91999-2772	NATURAL	1b 2a 3a 4b 5a 5b 6b	01c d60	2/3 5/6		K15	91999-3482	A						
91999-2773	NATURAL	1b	03c d60	1/2 4/5		K01	91999-3481	C						
91999-2774	NATURAL	1a 1b 2b 3b	d20 05c d60	1/2 3/4 5/6		N/A	91999-3480	c						
91999-2775	NATURAL	1b 2a 3a 4b 5a 5b 6b	01c. d60	2/3 5/6		K15	91999-3479	c						
91999-2776	NATURAL	ALL	ALL	1/2 4/5		K00	91999-3478	A						
91999-2777	NATURAL	1b	03c d60	1/2 5/6		K53	91999-3477	A						
91999-2778	NATURAL	1b 2b 3b	01c 05c d60	1/2 3/4 5/6		K51	91999-3476	A						
91999-2779	NATURAL	ALL	ALL	2/3 4/5		K90	91999-3475	A						

SEE SHEET 1 EC NO: E2009-0594 DRAWN BY: B. RUTTLE CHKD: TOURISH APPR: BMAGUIRE REV:	QUALITY SYMBOLS ▽=0 ▽=0	GENERAL TOLERANCES (UNLESS SPECIFIED) mm INCH 4 PLACES ± --- ± --- 3 PLACES ± --- ± --- 2 PLACES ± 0.1 ± --- 1 PLACE ± 0.2 ± --- ANGULAR ± 2°	DIMENSION STYLE MM ONLY DRAWN BY: B. RUTTLE DATE: 2006/10/04 CHECKED BY: DATE: T. TOURISH 2006/10/04 APPROVED BY: DATE: BMAGUIRE 2006/10/04	SCALE: 1:1 DESIGN UNITS: METRIC THIRD ANGLE PROJECTION	TITLE: RAST 5 VERT HDR PA 66 HOUSING	MOLEX INCORPORATED DOCUMENT NO. SD-91999-001	SHEET NO. 5 OF 6
	DRAFT WHERE APPLICABLE MUST REMAIN WITHIN DIMENSIONS		SEE CHART		THIS DRAWING CONTAINS INFORMATION THAT IS PROPRIETARY TO MOLEX INCORPORATED AND SHOULD NOT BE USED WITHOUT WRITTEN PERMISSION		

7 CIRCUIT		SEE CODE DESIGNATION TABLE FOR NUMBERING FORMAT WHEN ADDING NEW PART NUMBERS					P.C.B. POLARISATION OPTION	PACKAGIG OPTION *	COLOUR STRIPE
PART NO. (TIN)	COLOUR	UNBLOCKED POSITION KEYS	UNBLOCKED CODING KEYS	LATCH POSITION	CONFIGURATION (SEE NOTES)	REF	PART NO. (SILVER)		
91999-3511	NATURAL	NONE	03c d40 07c	1/2 5/6		K01	91999-4249	A	
91999-3512	NATURAL	3a 4a	d30 d70	1/2 5/6		K30	91999-4248	A	
91999-3504	NATURAL	2b	d20 d60	1/2 5/6		K32	91999-4247	A	
91999-3508	NATURAL	1a 1b 3a 4b 5a	01c 07c	1/2 3/4 5/6		K40	91999-4243	A	
91999-3509	NATURAL	2a	01c d50	2/3 4/5		K41	91999-4242	A	
91999-3515	NATURAL	7b	01c d40 d70	1/2 3/4 6/7		K43	91999-4240	A	
91999-3516	NATURAL	1b	03c d60	1/2 4/5		K31	91999-4239	A	
91999-3517	NATURAL	1a 3a 4b 7b	01c d20 03c 06c	1/2 3/4 6/7		K45	91999-4238	A	
91999-3519	NATURAL	1b 7a	02c d50	2/3 6/7		K48	91999-4237	A	
91999-3521	NATURAL	1a 2b 3a 4b 6a	d20 03c d40 d50 d70	1/2 3/4 6/7		K51	91999-4236	A	
91999-3522	NATURAL	1b 6a	d20 03c d50 d70	1/2 3/4 6/7		K69	91999-4235	A	
91999-3523	NATURAL	1b 2a 5a 5b 7b	d20 d50 06c d70	1/2 4/5 6/7		K34	91999-4234	A	
91999-3524	NATURAL	2b	d20 07c	1/2 3/4 5/6		K35	91999-4233	A	
91999-3525	NATURAL	2a 2b 4b 5b 6a	d20 03c d40 d60	1/2 3/4 5/6		K38	91999-4232	A	
91999-3526	NATURAL	2b 4a 4b 5b 6a	01c d20 d40 d60	1/2 3/4 5/6		K42	91999-4231	A	
91999-3527	NATURAL	1b, 2a, 3a 5b, 6a, 6b, 7b	01c, d70	2/3, 6/7		K05	91999-4230	A	
91999-3528	NATURAL	ALL	ALL	1/2, 5/6		K00	91999-4229	A	
91999-3529	NATURAL	2a 3b 4b 5a 6a 6b 7a	01c d30 04c 06c d60 d70	1/2 4/5		N/A	91999-4228	A	
91999-3530	NATURAL	NONE	04c 07c	1/2 5/6		N/A	91999-4227	A	



NOTES:
* SEE SHEET 1 NOTE 4

SEE SHEET 1 ELEC NO: E2009-0594 DRW: BRUTLE 2009/06/03 CHKD: T. TOURSH 2009/06/03 APPR: BMAGUIRE 2009/06/04	QUALITY SYMBOLS	GENERAL TOLERANCES (UNLESS SPECIFIED)	DIMENSION STYLE	SCALE	DESIGN UNITS	THIRD ANGLE PROJECTION
	$\nabla=0$ $\nabla=0$	mm INCH 4 PLACES ± --- ± --- 3 PLACES ± --- ± --- 2 PLACES ± 0.1 ± --- 1 PLACE ± 0.2 ± --- ANGULAR ± 2 °	MM ONLY DRAWN BY DATE B. RUTLE 2006/10/04 CHECKED BY DATE T. TOURSH 2006/10/04 APPROVED BY DATE BMAGUIRE 2006/10/04	1:1	METRIC	RAST 5 VERT HDR PA 66 HOUSING
	DRAFT WHERE APPLICABLE MUST REMAIN WITHIN DIMENSIONS	SEE CHART	MATERIAL NO. SD-91999-001	MOLEX INCORPORATED	SHEET NO. 6 OF 6	
	THIS DRAWING CONTAINS INFORMATION THAT IS PROPRIETARY TO MOLEX INCORPORATED AND SHOULD NOT BE USED WITHOUT WRITTEN PERMISSION					