

DIMENSIONS mm (inches)

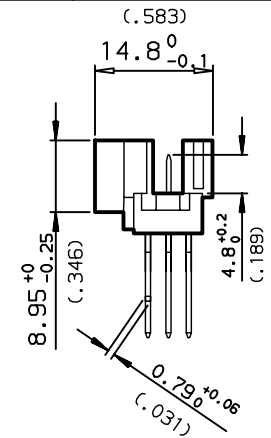

PART NUMBER	8609	08	7	5
PIN OUT	rows a-b-c	3	96	
	rows a-c	4	64	
NUMBER OF CONTACTS				
TERMINATION	L = 13.25 ± 0.25 (.521)	near plug up	96	
	L = 17.25 ± 0.25 (.679)	near plug up + 1 wrap	97	
	L = 20.95 ± 0.25 (.825)	near plug up + 2 wraps	98	
PERFORMANCE CLASS	DIN 41612 class 3			4
	DIN 41612 class 2			
	DIN 41612 class 1			
TERMINATION TYPE	TIN LEAD			000
	LEAD FREE			LF

PCB DRILLING

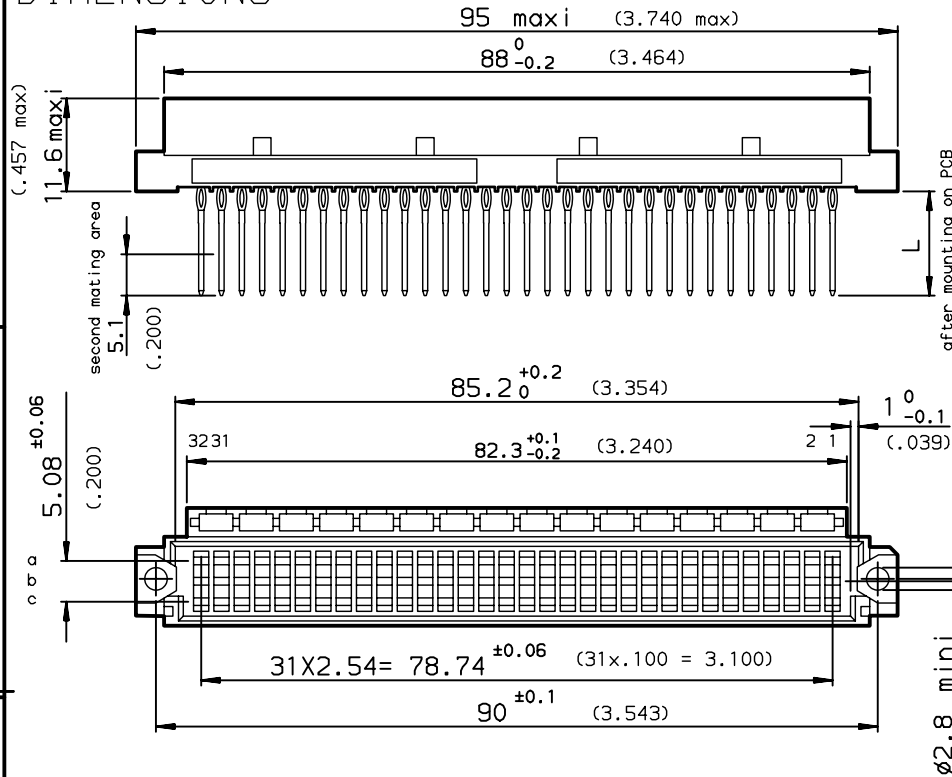
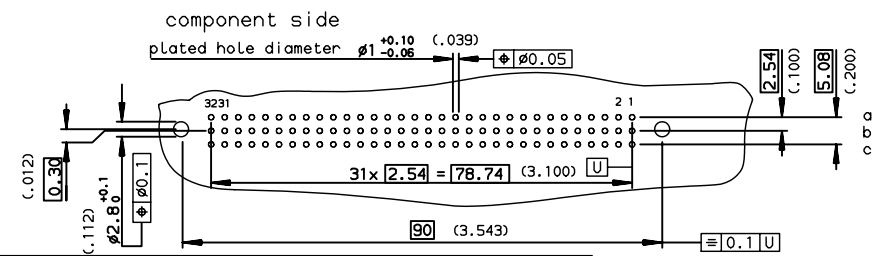

GENERAL CHARACTERISTICS AND ROHS INFORMATIONS:

SEE DRAWING C-8609-0000C European Views

www.fciconnect.com	surface ISO 1302	tolerance std ISO 406 ISO 1101	projection mm
TOLERANCES UNLESS OTHERWISE SPECIFIED			
Dr ROUILLARD 1996/09/04	ANGULAR	0.X ± 0.1	size A3
Eng TARON 1996/09/04	LINEAR	0.XX ± 0.1	Scale 1.5
Chr LEGARE 1996/09/04	0.XX' ± 2'	0.XXX ± 0.1	ECN LS06-0095
Appr LEGARE 1996/09/04	Product family	DIN 8609	Spec ref -

rev	ech no	dr	date
D	-	ROU	1997/11/05
E	LS05-004	JTA	2005/02/28
F	LS06-0095	LGO	2006/07/12
-	-	-	-
-	-	-	-
-	-	-	-

FCI	title	STRAIGHT MALE - STYLE R	dwg no	C-8609-0522	Rev. F
	catalog no	PRESS FIT REAR PLUG UP WITH KEYING			
CUSTOMER		sheet 1 of 1			