

Illuminated pushbutton Ø 22 mm silver contact

82-6551.1124



<https://eao.com/p/82-6551.1124>

Your product:



82-6551.1124

Illuminated pushbutton Ø 22 mm silver contact

FRONT

Front bezel material: Aluminium

MOUNTING

Mounting cut-out: Ø 22 mm

OPERATING-/INDICATION PART

Lens colour: Nature

Lens shape: flush

Lens optics: opaque

Shape of illumination: Ring

Lens illumination: illuminative

Lens material: Aluminium

Illumination colour: Blue

ELECTRICAL CHARACTERISTICS

Rated insulation voltage U_i : 250 V

Rated Operational Voltage U_e : 250 VAC

Contacts: 1 C

Pollution degree: 2, according to EN IEC 60947-1

Electrical lifetime: 50 000 cycles of operation

Electric strength: 1500 VAC, 50 Hz 1 minute between life terminals and ground

Operating voltage: 24 V AC/DC

Thermal current I_{th}:	5 A	
Switching voltage and switching current:	according to IEC 60947-5-1 (Silver contacts) Service categorie AC-15	
	Voltage	Current
	24 VAC	1 A
	35 VAC	1 A (M12 versio
	110 VAC	1 A
	220 VAC	0.5 A
	Switch rating DC service categorie DC-13 (Silver contacts)	
	Voltage	Current
	24 VDC	0.7 A
	35 VDC	0.5 A (M12 vers
	110 VDC	0.2 A
	220 VDC	0.1 A
	according to UL 508 (Silver contacts)	
	cosφ 0,75 ... 0,8	
	Voltage	Current
	120 VAC	5 A
	240 VAC	3 A
	24 VAC	1 A

MECHANICAL CHARACTERISTIC

Mechanical lifetime:	1 Mio. cycles of operation
Terminal:	Soldering terminal, 2.8 x 0.5 mm
Operating force:	4 N ... 7 N
Tightening torque:	0.5 ... 0.6 Nm
Weight:	0.018 kg
Operating Travel:	ca. 3 mm
Switching system:	Snap-action switching element
Contact material:	Silver
Switching action:	Momentary

AMBIENT CONDITION

Storage temperature:	- 40 °C ... + 80 °C
Vibration resistance:	10 ... 500 Hz, amplitude 1.5 mm p-p according to IEC 60068-2-6
Operating temperature:	- 30 °C ... + 70 °C
Shock resistance:	Max. 500 m / s ² as per IEC 60068-2-27
Climate resistance:	Damp heat, 21 days according to IEC 60512-11

CERTIFICATE

Conformities:

CE, 2011 / 65 / EC (RoHS), 2014 / 35 / EU (LVD)

Approbations:

CB, CCC, C UL, UL

OTHER

Short Description:

Illuminated pushbutton Ø 22 mm silver contact, Momentary, 24 V AC/DC, 1 C, Soldering terminal, 2.8 x 0.5 mm, Aluminium, Blue, Nature

Kind of illumination:

Single-LED

Mounting cut-outs:

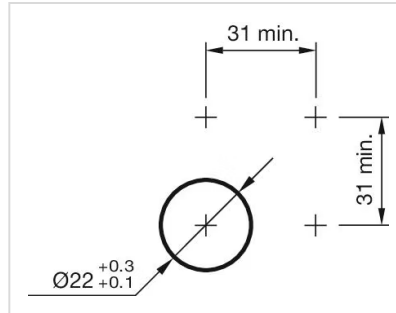

Component layouts:

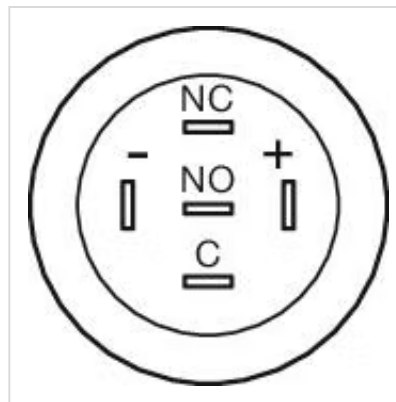

Wiring diagrams:

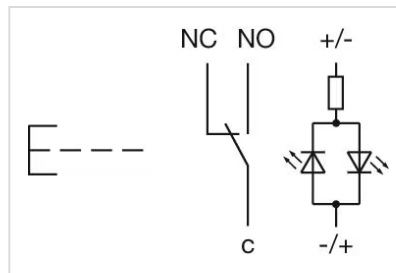

Dimension drawings:

