

Illuminated pushbutton Ø 22 mm silver contact

82-6151.1134.B002



<https://eao.com/p/82-6151.1134.B002>

Your product:



82-6151.1134.B002
Illuminated pushbutton Ø
22 mm silver contact

FRONT

Front bezel material: Stainless steel

MOUNTING

Mounting cut-out: Ø 22 mm

OPERATING-/INDICATION PART

Illumination colour: Green

Lens illumination: illuminative

Lens shape: flush

Shape of illumination: Ring

Lens colour: Silver

Lens optics: opaque

Lens material: Stainless steel

ELECTRICAL CHARACTERISTICS

Thermal current I_{th}: 5 A

Operating voltage: 24 V AC/DC

Contacts: 1 C

Switching voltage and switching current:

according to IEC 60947-5-1 (Silver contacts)	
Service categorie AC-15	
Voltage	Current
24 VAC	1 A
35 VAC	1 A (M12 version)
110 VAC	1 A
220 VAC	0.5 A
Switch rating DC service categorie DC-13 (Silver contacts)	
Voltage	Current
24 VDC	0.7 A
35 VDC	0.5 A (M12 version)
110 VDC	0.2 A
220 VDC	0.1 A

according to UL 508 (Silver contacts)	
cos ϕ 0,75 ... 0,8	
Voltage	Current
120 VAC	5 A
240 VAC	3 A
24 VAC	1 A

Rated insulation voltage Ui:	250 V
Rated Operational Voltage Ue:	250 VAC
Electrical lifetime:	50 000 cycles of operation
Electric strength:	1500 VAC, 50 Hz 1 minute between life terminals and ground
Pollution degree:	2, according to EN IEC 60947-1

MECHANICAL CHARACTERISTIC

Contact material:	Silver
Switching system:	Snap-action switching element
Mechanical lifetime:	1 Mio. cycles of operation
Operating force:	4 N ... 7 N
Terminal:	Soldering terminal, 2.8 x 0.5 mm
Switching action:	Momentary
Weight:	0.018 kg
Operating Travel:	ca. 3 mm
Tightening torque:	0.5 ... 0.6 Nm

AMBIENT CONDITION

Shock resistance:	Max. 500 m / s ² as per IEC 60068-2-27
Storage temperature:	- 40 °C ... + 80 °C
Operating temperature:	- 30 °C ... + 70 °C
Vibration resistance:	

10 ... 500 Hz, amplitude 1.5 mm p-p according to IEC 60068-2-6

Climate resistance: Damp heat, 21 days according to IEC 60512-11

CERTIFICATE

Approbations: CB, CCC, C UL, UL

Conformities: CE, 2011 / 65 / EC (RoHS), 2014 / 35 / EU (LVD)

OTHER

Kind of illumination: Single-LED

Symbol: Standby

Short Description: Illuminated pushbutton Ø 22 mm silver contact, Momentary, 24 V AC/DC, 1 C, Soldering terminal, 2.8 x 0.5 mm, Stainless steel, Green, Standby, Silver

Dimension drawings:

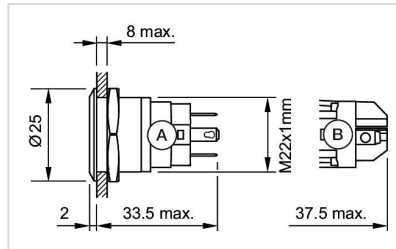

Mounting cut-outs:

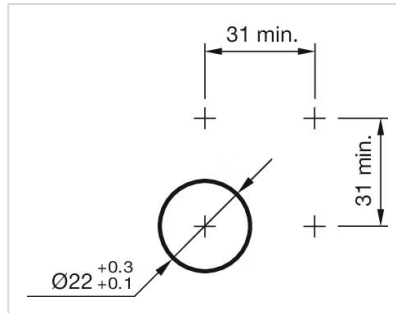

Wiring diagrams:

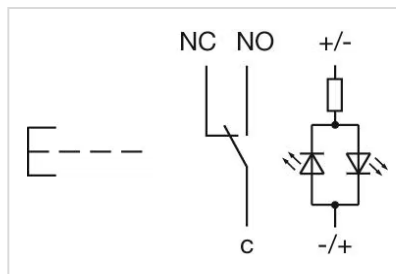

Component layouts:

