

Pushbutton Ø 16 mm silver contact

82-4151.1000



<https://eao.com/p/82-4151.1000>

Your product:



82-4151.1000 Pushbutton Ø 16 mm silver contact

FRONT

Front bezel material: Stainless steel

MOUNTING

Mounting cut-out: Ø 16 mm

OPERATING-/INDICATION PART

Lens optics: opaque

Lens illumination: non illuminative

Lens colour: Silver

Lens shape: flush

Lens material: Stainless steel

ELECTRICAL CHARACTERISTICS

Pollution degree: 2, according to EN IEC 60947-1

Thermal current I_{th}: 5 A

Rated Operational Voltage U_e: 250 VAC

Contacts: 1 C

Rated insulation voltage U_i: 250 V

Electric strength: 1500 VAC, 50 Hz 1 minute between life terminals and ground

Electrical lifetime: 50 000 cycles of operation

MECHANICAL CHARACTERISTIC

Mechanical lifetime:	1 Mio. cycles of operation
Operating force:	4 N ... 7 N
Switching action:	Momentary
Tightening torque:	0.5 ... 0.6 Nm
Operating Travel:	ca. 3 mm
Terminal:	Soldering terminal, 2.8 x 0.5 mm
Switching system:	Snap-action switching element
Weight:	0.018 kg
Contact material:	Silver

AMBIENT CONDITION

Operating temperature:	- 30 °C ... + 70 °C
Storage temperature:	- 40 °C ... + 80 °C
Vibration resistance:	10 ... 500 Hz, amplitude 1.5 mm p-p according to IEC 60068-2-6
Shock resistance:	Max. 500 m / s ² as per IEC 60068-2-27
Climate resistance:	Damp heat, 21 days according to IEC 60512-11

CERTIFICATE

Conformities:	CE, 2011 / 65 / EC (RoHS), 2014 / 35 / EU (LVD)
Approbations:	CB, CCC, C UL, UL

OTHER

Short Description: Pushbutton Ø 16 mm silver contact, Momentary, 1 C, Soldering terminal, 2.8 x 0.5 mm, Stainless steel, Silver

Mounting cut-outs:

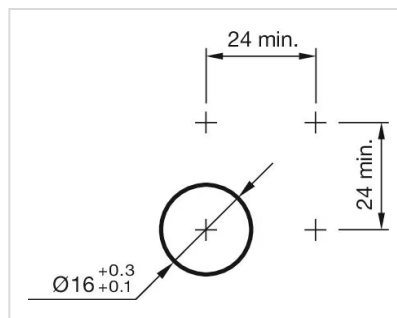

Dimension drawings:

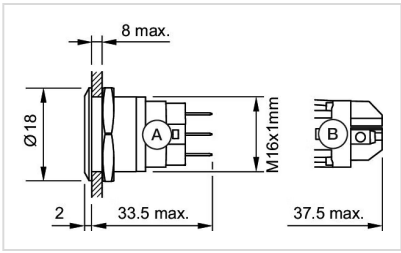

Component layouts:

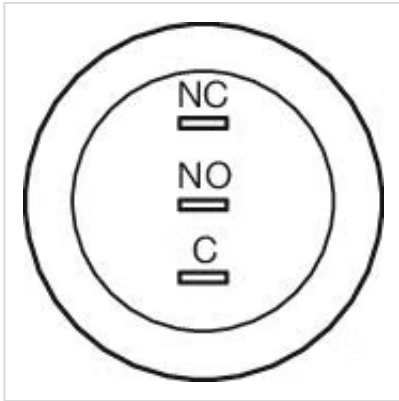

Wiring diagrams:

