



# NECTOR S POWER SYSTEM

## IDEAL SOLUTION FOR INDOOR LIGHTING DESIGNS

TE Connectivity's NECTOR S POWER SYSTEM is a flexible, fully pluggable, modular wiring connectors and cabling solution to meet the lighting industry's need for a compact easy-to-install interconnect solution. This 7.5mm connector can easily fit in an 8mm opening compared to other connectors that require much larger openings. The Nector S Line connector is ideal for applications where a power connection and coupling between lamps are needed. Whether it's showing you our value-added solutions or designing a new product; our commitment to advanced engineering and world-class manufacturing delivers innovation to advance your lighting project.

### TRAGET MARKETS

- Electrical Installation
- Lighting Installation

### SPECIFICATIONS

- Euro Style
  - Application: [114-18751](#)
  - Product: [108-94018](#)
  - Approvals: DIN EN IEC 60320 (VDE)
- UL Style
  - Application: [114-20140](#)
  - Product: [108-20294](#)
  - Approvals: UL 1977

### BENEFITS

- The smart wiring solution, that can easily fit into smaller 8 mm openings for space saving
- Improves installation efficiency with a plug and play interconnection system
- Ready-made cable assemblies save valuable installation time and ensure high quality performance throughout the full lifetime
- Reliable and globally approved connector system (IEC and UL certified)

### APPLICATIONS

#### Lighting



Residential; kitchen and bathroom



Retail; display, shelves, commercial refrigeration



Horticulture; vertical farming



Commercial Office; small spot lighting



Ship and yacht electrical installation

# SEEING IS BELIEVING

PLUG-AND PLAY PRINCIPLE. IT'S EASY AND RELIABLE.

## EASY. FAST. COMPACT.

It's our job to make connectors easy to use and fast to implement. The compact NECTOR S Line connector allows you to think freely with your design as its flexibility enables you to move fixtures around product displays for optimum lighting without worrying about any practical implications.

## READY-MADE CABLE ASSEMBLIES

By offering pre-assembled cable systems, TE Connectivity can take away all the hassle in the logistics and manufacturing of these products. Making sure that you can focus on your core competence of designing and delivering lighting equipment. We know the connector system in-and-out and have the right tools to provide you with highly reliable and efficiently produced cable assemblies. The portfolio consists out of the most common standard versions. Additionally, we can offer custom versions tuned to your project needs. Our connectors can make your lighting visualizations a reality.

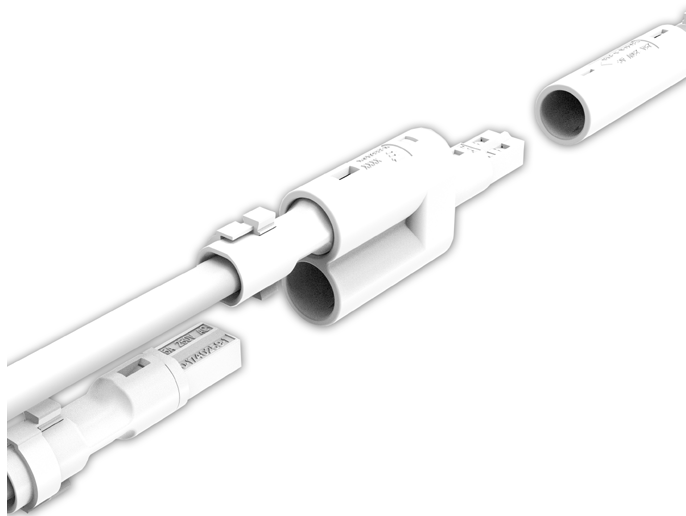

- Expand the power system and easily split power for two lamps
- Splitter has the function to switch power
- LEDs can be placed in the series using a splitter

Actual hole size fits a 7.5mm connector

# LIGHTING AS YOU IMAGINED IT

FLEXIBLE SOLUTIONS WITH EVERY DESIGN.

## THE CREATIVE USE OF LIGHT SOURCES

Every interior designer knows what proper lighting can do to a room, a desk or a cabinet. It can set a room's ambiance, tone a wall color, or apply an accent on just the right spot. Your wiring can be just as flexible as your imagination.



## JUST GIVE US 8MM

If you give us an opening as little as 8mm, the NECTOR S Line connector can fit there. You can power your lights just about anywhere: in a cabinet, inside kitchen furniture or in a headboard. The connector is easy to use, fast to implement and small enough to fit almost wherever.

## IT'S THE LITTLE THINGS

The overall atmosphere of any interior lighting design can change because of a 7.5mm connector. Those few millimeters can give you unparalleled freedom to power your lights. Whether it is 250V, 125V or a low voltage, the plug-and-play connector can expand a lighting system beyond its wall outlet.

- Six-way splitter to power six lamps

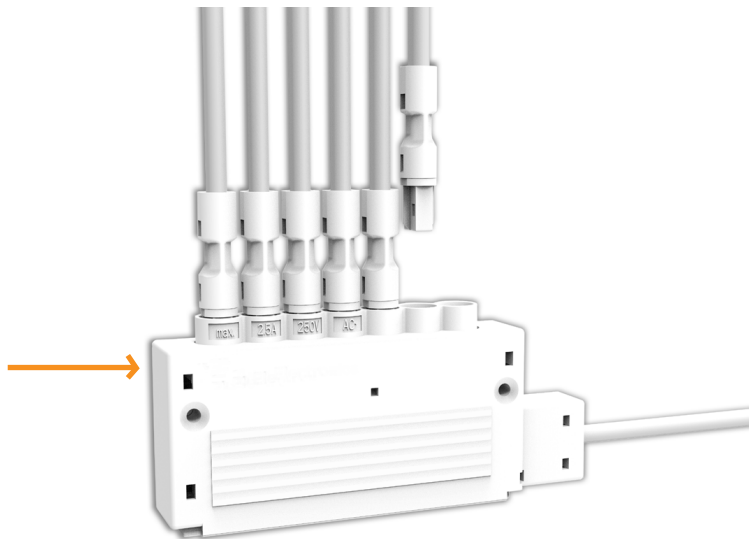

Actual hole size fits a 7.5mm connector

# SMALL CONNECTORS, OPTIMAL CONNECTIVITY

## FREEDOM IN ENERGY DISTRIBUTION

### LESS USE OF SPACE, ENERGY, AND DESIGN EQUALS BETTER LIGHTING INSTALLATIONS.

With the development of LEDs, lighting fixtures are now smaller in size and the possibilities of lighting are expanding. The NECTOR S Line connector can power small fixtures that are designed to fit into almost any space.

### OUR CONNECTOR GOES PLACES

Well balanced lighting inside a refrigerator or freezer system can increase sales. Products are more noticeable, more appealing and consequently they sell better. When you use the NECTOR S Line connector to power the lights inside your current conventionally-lit freezer or refrigerator case, you have the flexibility to quickly and easily change to a new LED lighting system.

### WHAT YOU SEE IS WHAT YOU GET

Customers want to take a good look at the products they are about to purchase. Supermarkets and department stores pay close attention to their overall use of lighting to ensure that the products on their shelves are noticeable. New systems are equipped with interior lighting that is optimized. Retrofitting an existing lighting system is a costly operation often not done unless other upgrades are needed.

### UPGRADE NOW

When you use the NECTOR S Line connector to retrofit the lighting inside your current system, you have the opportunity to use the latest in interconnect and lighting technology. Not only will the products on your shelves look and sell better, but your store will look better too!



- Bus bar can be placed anywhere on the cable
- Multiple bus bars can be placed on the cable
- Sealed bus bar and sealed plug provide IP67 protection

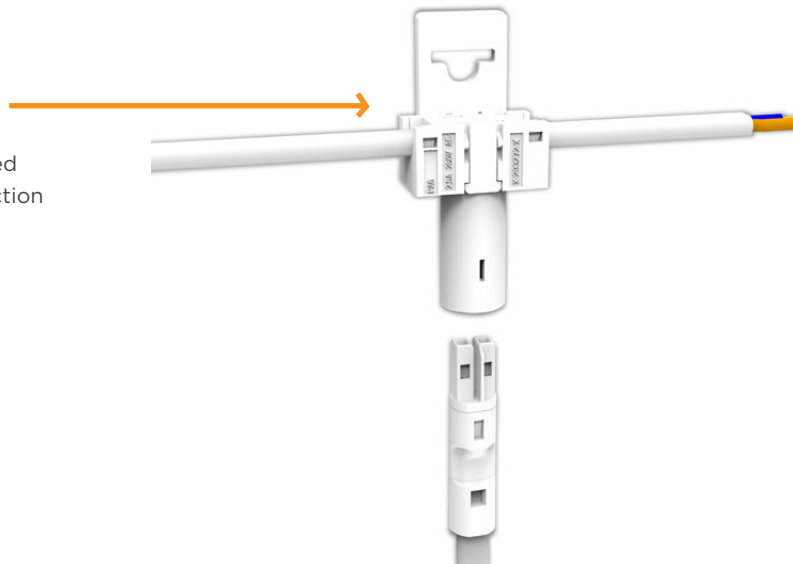

# NECTOR S POWER SYSTEM

## LOOSE PIECE COMPONENTS EURO STYLE

Housing Color ● Black ○ White ● Red



Description	Outlet Housing (to be used with pin contact)		Pin Contact	Tube H03 VYH2		Ring Clip	
250 VAC HV-1	<a href="#">1740262-1</a>	○	<a href="#">1740335-1 (unplated)</a>	<a href="#">1740260-1</a>	○	<a href="#">1740261-1</a>	○
	<a href="#">1740262-2</a>	●	<a href="#">1740335-4 (tin plated)</a>	<a href="#">1740260-2</a>	●	<a href="#">1740261-2</a>	●



Description	Plug Housing (to be used with socket contact)		Socket Contact	Tube H03 VYH2		Ring Clip	
250 VAC HV-1	<a href="#">1740259-1</a>	○	<a href="#">1740336-1 (unplated)</a>	<a href="#">1740260-1</a>	○	<a href="#">1740261-1</a>	○
	<a href="#">1740259-2</a>	●	<a href="#">1740336-4 (tin plated)</a>	<a href="#">1740260-2</a>	●	<a href="#">1740261-2</a>	●



Description	Panel Mount Outlet (to be used with pin contact)		Pin Contact	6 Way Distributor Body		Ring Clip	
42 VDC LV-2	<a href="#">293224-5</a>	○	<a href="#">1740335-1 (unplated)</a>	<a href="#">1740317-1</a>	○	<a href="#">1740315-1</a>	○
			<a href="#">1740335-4 (tin plated)</a>	<a href="#">1740317-3</a>	●	<a href="#">1740315-2</a>	●

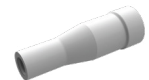

Description	6 Way Distributor Body (switchable, to be used with coding ring)		Coding Ring		Cover		IP Boot (to be used on plug and outlet)
250 VAC HV-1	<a href="#">1740262-1</a>	○	<a href="#">1740316-1</a>	●	<a href="#">1740315-1</a>	○	<a href="#">293284-1</a>
	<a href="#">1740262-2</a>	●		<a href="#">1740315-2</a>	●		



Description	Wall Outlet Assembly (inclusive blind boot)		Wall Outlet Frame Assembly		Chassis Mount Frame (Panel thickness 0.5mm to 1.5mm)		Chassis Mount Housing Support (to be used with chassis mount frame)
250 VAC HV-1	<a href="#">293285-1</a>	○	<a href="#">293286-1</a>	○	<a href="#">1740315-1</a>		<a href="#">293284-1</a>
42 VDC LV-2		●	<a href="#">293286-3</a>	●	<a href="#">1740315-2</a>		

# NECTOR S POWER SYSTEM

## STANDARD COMPONENTS EURO STYLE

Housing Color ● Black ○ White

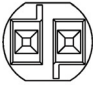
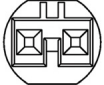

Description	Bus Bar With Fixing Hook		Bus Bar Without Fixing Hook		Splitter Parallel	
250 VAC HV-1 	<a href="#">293300-1</a>	○	<a href="#">293300-3<sup>3</sup></a>	○	<a href="#">293234-3</a>	
			<a href="#">293300-4<sup>3</sup></a>	●		
			<a href="#">293270-3<sup>1</sup></a>	○		
	<a href="#">293270-1<sup>1</sup></a>	○				
	<a href="#">293270-2<sup>2</sup></a>	○	<a href="#">293270-4<sup>2</sup></a>	○		
			<a href="#">293270-9<sup>2</sup></a>	●		
42 VDC LV-2 			<a href="#">1-293270-0<sup>1</sup></a>	●		

1 : through sealed 2 : end sealed 3 : through unsealed 4 : end unsealed

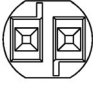

Description	Outlet PCB Connector (straight angled version)		Plug PCB Connector (straight version)		Plug PCB Connector (straight angled version)	
250 VAC HV-1 	<a href="#">293315-1</a>	○	<a href="#">293308-2</a>	●	<a href="#">293311-1</a>	○

# NECTOR S POWER SYSTEM

## LOOSE PIECE COMPONENTS UL STYLE

Housing Color ● Black ○ White



Description	Outlet Housing (to be used with pin contact)		Pin Contact (tin plated)	Tube SVT Style Cable	Plug Housing (to be used with socket contact)		Socket Contact (tin plated)	Tube SVT Style Cable
250 VAC HV-4	<a href="#">293387-2</a>	○	<a href="#">293389-1</a>	<a href="#">293359-1</a>	<a href="#">293388-3</a>	○	<a href="#">293390-1</a>	<a href="#">293359-1</a>
125 VDC LV-2	<a href="#">293387-4</a>	○			<a href="#">293388-5</a>	○		



Description	Panel Mount Outlet (to be used with pin contact)		Pin Contact (tin plated)	Tube SPT-2 Style Cable (alternative for tube SVT)	Coding Ring	Cover	
125 VDC LV-2	<a href="#">293648-2</a>	○	<a href="#">293389-1</a>	<a href="#">293358-1</a>	<a href="#">1740316-1</a>	<a href="#">293587-1</a>	○



Description	6 Way Distributor Body		Cover	
125 VDC LV-2	<a href="#">293651-3</a>	○	<a href="#">293587-1</a>	○

# NECTOR S POWER SYSTEM

## STANDARD COMPONENTS UL STYLE

Housing Color ● Black ○ White

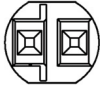
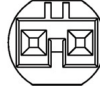

Description	Bus Bar With Fixing Hook		Bus Bar Without Fixing Hook		Splitter Parallel	
250 VAC HV-4 					<a href="#">293650-1</a>	○
42 VDC LV-2 	<a href="#">2213222-4<sup>2</sup></a>	○			<a href="#">293650-4</a>	○
			<a href="#">7-2213222-4<sup>3</sup></a>	○		



Description	Outlet PCB Connector (straight angled version)		Plug PCB Connector (straight version)		Plug PCB Connector (straight angled version)	
250 VAC HV-4	<a href="#">293653-3</a>	○	<a href="#">293655-3</a>	○	<a href="#">293654-3</a>	○

1 : Through Unsealed 2 : Through Sealed 3 : End Unsealed 4: End Sealed

## Connect With Us

We make it easy to connect with our experts and are ready to provide all the support you need.

Visit [te.com/support](https://te.com/support) to chat with a Product Information Specialist.

## [te.com/nector-connector-system](https://te.com/nector-connector-system)

TE Connectivity, TE, TE connectivity (logo) and EVERY CONNECTION COUNTS are trademarks owned or licensed by the TE Connectivity plc family of companies. All other logos, products and/or company names referred to herein might be trademarks of their respective owners.

While TE has made every reasonable effort to ensure the accuracy of the information in this document, TE does not guarantee that it is error-free, nor does TE make any other representation, warranty or guarantee that the information is accurate, correct, reliable or current. TE reserves the right to make any changes to the information contained herein without prior notice. TE Connectivity's obligations shall only be as set forth in TE Connectivity's Standard Terms and Conditions of Sale for this product and in no case will TE Connectivity be liable for any incidental, indirect, or consequential damages arising out of the sale, resale, use, or misapplication of the product. TE expressly disclaims any implied warranties with respect to the information contained herein, including, but not limited to, implied warranties of merchantability or fitness for a particular purpose. Dimensions, specifications and/or information contained herein are for reference purposes only and are subject to change without notice. Consult TE for the latest dimensions, specifications and/or information. Users of TE Connectivity products must make their own assessment as to whether the respective product is suitable for the respective desired application.

©2026 TE Connectivity. All Rights Reserved.

Published 01-26