

# s.90

full port 1/4"÷4"

hot forged brass ball valves



Pressure rating is now upgraded to 40 bar

## Features and Specifications:

- \* **Hot forged** sand blasted, nickel plated brass body and cap sealed with Loctite,
- \* **Approved** by Danish Board of European Technical Approval for Construction Products (DK),
- \* Finest brass according to **EN 12165** and **EN 12164** (formerly DIN 17660 and UNI 5705-65) specifications,
- \* **Full port** to DIN 3357 for maximum flow,
- \* 24h 100% seal test **guaranteed**,
- \* Pure **Teflon®** (Dupont registered trademark) self-lubricating seats with flexible-lip design,
- \* Dual sealing system allows valve to be operated in either directions making **installation easier**,
- \* Chrome plated brass ball for **longer life**,
- \* **No metal-to-metal** moving parts,
- \* **Blowout-proof** nickel plated brass stem,
- \* Two Viton O-rings at the stem for **maximum safety**,
- \* **No maintenance** ever required,
- \* Handle stops on body to **avoid stresses** at stem,
- \* **Dacrotized** carbon steel handle with thick PVC dip coating,
- \* Handle clearly shows **ball position**,
- \* **ISO 228** Female by Female threads,
- \* **Silicone-free** lubricant on all seals,

- \* 40 bar (Kg/cm<sup>2</sup>) up to 2", 30 bar over 2", non-shock cold working **pressure**,
- \* -20°C +170°C **temperature**.

## Options up to 2" size:

- \* **Dezincification Resistant** brass body and components,
- \* **Male by Female** threads,
- \* **Male by Male** threads,
- \* **Stem extension**,
- \* **T-handle**,
- \* **Oval lockable handle**,
- \* **AISI 430 stainless steel handle**,
- \* **Patented locking device** for valves up to 4".

## Upon request:

- \* **AISI 316 stainless steel ball and/or stem**,
- \* **Glass filled PTFE** seals,
- \* **Custom design**.

NOTE: Approvals apply to specific configurations only.



ACCORDING TO  
97/23 CE  
module A



it cannot be used with dangerous gases in sizes larger than 25mm.



1.1/4" ± 2" hollow ball

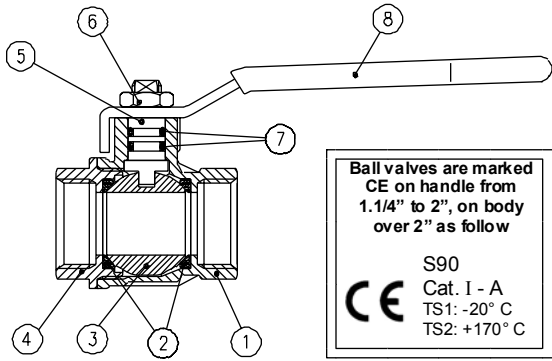

Ball valves are marked CE on handle from 1.1/4" to 2", on body over 2" as follow

S90  
Cat. I - A  
TS1: -20° C  
TS2: +170° C

PART DESCRIPTION	Material	Q.ty
1 Nickel plated body	CW617N RUB001	1
2 Ball seat	Ptfe RUB008	2
3 Chrome plated ball	CW617N RUB001	1
4 Nickel plated end cap	CW617N RUB001	1
5 Nickel plated stem O-Ring design	CW614N RUB001	1
6 Dactrotized nut	C10 RUB003	1
7 Green O-Ring	Viton RUB009	2
8 Red dactrotized steel handle	Fe50 RUB003	1

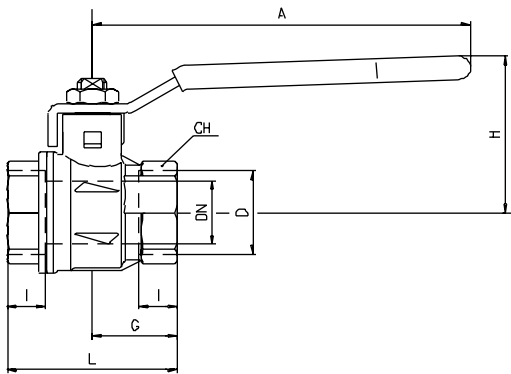

Code	S90B00	S90C00	S90L00	S90E00	S90F00	S90G00	S90H00	S90I00	S90L00	S90M00	S90N00
D (inch)	1/4	3/8	1/2	3/4	1	1 1/4	1 1/2	2	2 1/2	3	4
DN (mm)	8	10	15	20	25	32	40	50	65	80	100
I (mm)	9	9	11	12	14	15	17	19	22	25	29
L (mm)	39	39	50	54	67	77	90	106	136	157	191
G (mm)	19.5	19.5	25	27	33.5	38.5	45	53	68	78.5	95.5
A (mm)	82	82	100	120	120	158	158	158	255	255	255
H (mm)	38	38	43	50	54	73	79	86	132	140	154
CH (mm)	20	20	25	31	38	48	54	66	85	99	125

DN shows the nominal flow diameter. Actual flow diameter complies with full port DIN 3357 part 4.

Stem configuration of valves over 2" is slightly different. Ask for details at our Service Center.

