

# Actuator

704.032.618



<https://eao.com/p/704.032.618>

Your product:

---



## 704.032.618 Actuator

### FRONT

<b>Front bezel material:</b>	Aluminium
<b>Front dimension:</b>	Ø 35 mm
<b>Front bezel colour:</b>	Nature
<b>Front form:</b>	round

### MOUNTING

<b>Design:</b>	flush
----------------	-------

### OPERATING-/INDICATION PART

<b>Lens optics:</b>	transparent
<b>Lens colour:</b>	Blue
<b>Illumination colour:</b>	Blue
<b>Lens illumination:</b>	illuminative
<b>Lens shape:</b>	flush
<b>Lens material:</b>	Plastic

### ELECTRICAL CHARACTERISTICS

<b>Standards:</b>	The switches comply with the "Standards for low-voltage switching devices" DIN EN 60947-1
-------------------	---

### MECHANICAL CHARACTERISTIC

<b>Terminal:</b>	Screw terminal
<b>Operating force:</b>	8 N

**Mechanical lifetime:** ≤3 Mio. cycles of operation  
**Operating Travel:** ca. 5.8 mm ± 0.2 mm  
**Switching action:** Momentary  
**Weight:** 0.067 kg

### AMBIENT CONDITION

**Operating temperature:** – 40 °C ... + 55 °C  
**IP Protection:** IP65 front side  
**Storage temperature:** – 40 °C ... + 85 °C

### OTHER

**Short Description:** Actuator, Ø 35 mm, flush, illuminative, Blue, Plastic, transparent, round, Nature, Aluminium, anodised, Momentary, Screw terminal, Blue

**Housing colour:** Grey

**max. number of switching elements:** 3

**Housing material:** Plastic

**Hints:** Max. 3 switching elements can be clipped on, The lamp block will be delivered with screw terminal, The colour of anodised aluminium parts can vary due to technical production reasons

**Mounting cut-outs:**

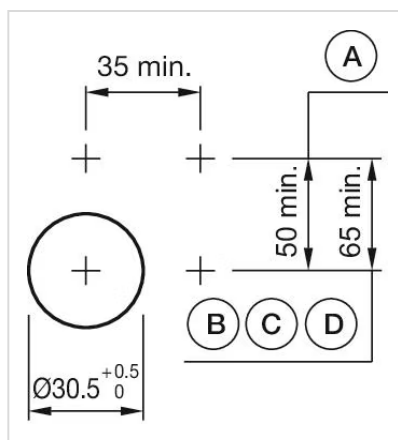

**Dimension drawings:**

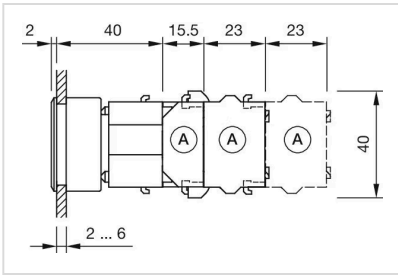

**Wiring diagrams:**

