

Actuator

704.032.518



<https://eao.com/p/704.032.518>

Your product:



704.032.518 Actuator

FRONT

Front form:	round
Front bezel material:	Aluminium
Front dimension:	Ø 35 mm
Front bezel colour:	Nature

MOUNTING

Design:	flush
----------------	-------

OPERATING-/INDICATION PART

Lens optics:	transparent
Lens colour:	Green
Lens illumination:	illuminative
Lens shape:	flush
Lens material:	Plastic
Illumination colour:	Green

ELECTRICAL CHARACTERISTICS

Standards:	The switches comply with the "Standards for low-voltage switching devices" DIN EN 60947-1
-------------------	---

MECHANICAL CHARACTERISTIC

Operating force:	8 N
Weight:	0.067 kg

Operating Travel: ca. 5.8 mm ± 0.2 mm
Switching action: Momentary
Mechanical lifetime: ≤3 Mio. cycles of operation
Terminal: Screw terminal

AMBIENT CONDITION

Operating temperature: - 40 °C ... + 55 °C
IP Protection: IP65 front side
Storage temperature: - 40 °C ... + 85 °C

OTHER

Housing material: Plastic
Housing colour: Grey

Hints: Max. 3 switching elements can be clipped on, The lamp block will be delivered with screw terminal, The colour of anodised aluminium parts can vary due to technical production reasons

max. number of switching elements: 3

Short Description: Actuator, Ø 35 mm, flush, illuminative, Green, Plastic, transparent, round, Nature, Aluminium, anodised, Momentary, Screw terminal, Green

Wiring diagrams:

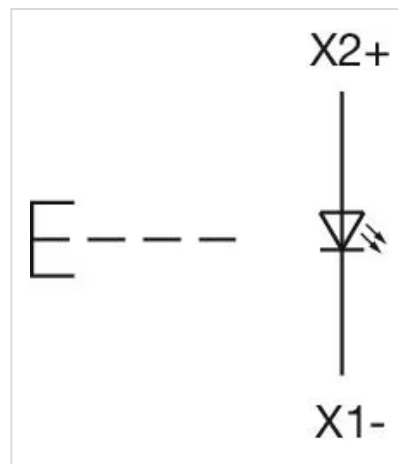

Mounting cut-outs:

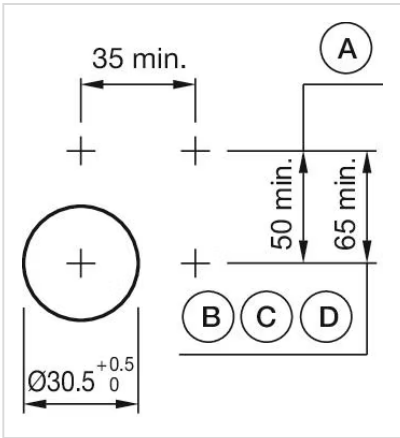

Dimension drawings:

