

Actuator

704.032.418



<https://eao.com/p/704.032.418>

Your product:



704.032.418 Actuator

FRONT

Front bezel material:	Aluminium
Front form:	round
Front bezel colour:	Nature
Front dimension:	Ø 35 mm

MOUNTING

Design:	flush
----------------	-------

OPERATING-/INDICATION PART

Lens shape:	flush
Lens illumination:	illuminative
Lens material:	Plastic
Illumination colour:	Yellow
Lens optics:	transparent
Lens colour:	Yellow

ELECTRICAL CHARACTERISTICS

Standards:	The switches comply with the "Standards for low-voltage switching devices" DIN EN 60947-1
-------------------	---

MECHANICAL CHARACTERISTIC

Terminal:	Screw terminal
Operating force:	8 N

Mechanical lifetime: ≤3 Mio. cycles of operation
Operating Travel: ca. 5.8 mm ± 0.2 mm
Weight: 0.067 kg
Switching action: Momentary

AMBIENT CONDITION

Storage temperature: - 40 °C ... + 85 °C
IP Protection: IP65 front side
Operating temperature: - 40 °C ... + 55 °C

OTHER

max. number of switching elements: 3

Hints: Max. 3 switching elements can be clipped on, The lamp block will be delivered with screw terminal, The colour of anodised aluminium parts can vary due to technical production reasons

Housing material: Plastic

Short Description: Actuator, Ø 35 mm, flush, illuminative, Yellow, Plastic, transparent, round, Nature, Aluminium, anodised, Momentary, Screw terminal, Yellow

Housing colour: Grey

Wiring diagrams:

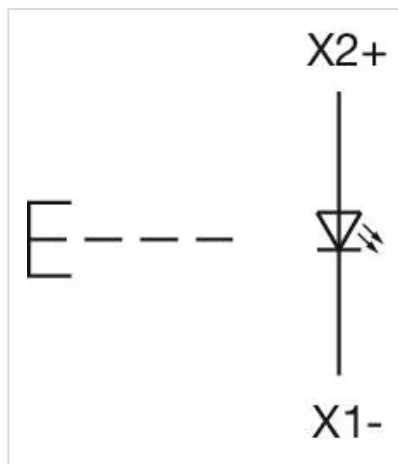

Dimension drawings:

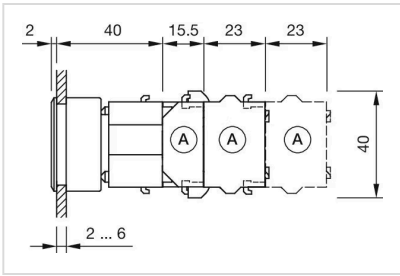

Mounting cut-outs:

