

Surface Mount Fuse, 7 x 2 mm, Quick-Acting F, 125 VAC, 125 VDC



UL 248-14 · 125VAC · 125VDC · Quick-Acting F



**Description**

- High breaking capacity
- Directly solderable on printed circuit boards

**Standards**

- UL 248-14
- CSA C22.2 no. 248.14

**Approvals**

- UL File Number: E42088
- CSA File Number: 34549

**Applications**

- Telecom
- Industrial electronic
- Household appliances

**References**

Packaging Details  
 Square Footprint Type MKF  
 Corresponding Fuseholder 231786; 231787

**Weblinks**

pdf-datasheet, html-datasheet, General Product Information, Approvals, RoHS, CHINA-RoHS, e-Shop, SCHURTER-Stock-Check, Distributor-Stock-Check, Detailed request for product

**Technical Data**

Rated Voltage	63 - 125VAC, 65 - 125VDC
Rated Current	0.063 - 15A
Breaking Capacity	300A
Characteristic	Quick-Acting F
Mounting	PCB,SMT
Admissible Ambient Air Temp.	-55°C to 125°C
Climatic Category	55/125/56 acc. to IEC 60068-1
Material: Tube	Ceramic
Material: Endcaps	Tin-Plated Copper Alloy
Unit Weight	0.07 g
Storage Conditions	0°C to 60°C, max. 70% r.h.
Product Marking	, Current

Soldering Methods	Reflow, Wave
Solderability	235 °C / 2 sec acc. to IEC 60068-2-58, Test Td, Fig. 2B (Reflow) // 245 °C / 3 sec (Wave)
Resistance to Soldering Heat	260 °C / 10 sec acc. to IEC 60068-2-58, Test Td

**Dimensions**

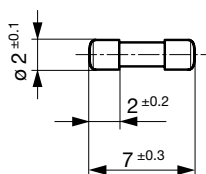
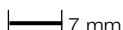

Soldering pads

**Pre-Arcing Time**

Rated Current In	1.0 x In min.	2.0 x In max.	2.75 x In max.	4.0 x In max.	10.0 x In max.
0.063 A - 0.75 A	4 h	5 s	300 ms	30 ms	5 ms
1 A - 15 A	4 h	10 s	-	60 ms	5 ms

### Variants

Rated Current [A]	Rated Voltage [VAC]	Rated Voltage [VDC]	Breaking Capacity	Voltage Drop 1.0 I <sub>n</sub> typ. [mV]	Power Dissipation 1.0 I <sub>n</sub> typ. [mW]	Melting I <sup>2</sup> t 10.0 I <sub>n</sub> typ. [A <sup>2</sup> s]		Order Number
0.063	125	125	1)	590	37	0.0022	●	7010.9750.xx
0.125	125	125	1)	640	80	0.0024	●	7010.9760.xx
0.25	125	125	1)	275	69	0.0061	●	7010.9770.xx
0.375	125	125	1)	215	81	0.012	●	7010.9780.xx
0.5	125	125	1)	205	103	0.046	●	7010.9790.xx
0.75	125	125	1)	190	143	0.09	●	7010.9800.xx
1	125	125	1)	180	180	0.11	●	7010.9810.xx
1.5	125	125	1)	185	278	0.25	●	7010.9820.xx
2	125	125	1)	160	320	0.72	●	7010.9830.xx
2.5	125	125	1)	160	400	0.91	●	7010.9840.xx
3	125	125	1)	155	465	1.3	●	7010.9850.xx
3.5	125	125	1)	145	510	1.7	●	7010.9860.xx
4	125	125	1)	140	560	2.6	●	7010.9870.xx
5	63	125	2)	125	625	4	●	7010.9880.xx
7	63	125	2)	120	840	8.5	●	7010.9890.xx
10	65	65	3)	110	1100	31	●	7010.9892.xx
12	65	65	3)	115	1380	48	●	7010.9894.xx
15	65	65	3)	105	1575	92	●	7010.9896.xx

1) 300 A @ 125 VAC , p.f. ≥ 0.95 / 300 A @ 125 VDC

2) 300 A @ 63 VAC , p.f. ≥ 0.95 / 300 A @ 125 VDC

3) 300 A @ 65 VAC , p.f. ≥ 0.95 / 300 A @ 65 VDC

### Packaging Unit

.xx = .63 Plastic Bag (100 pcs.)

.xx = .57 Blister Tape 18 cm Reel (1500 pcs.)

### Time-Current-Curves

