

PRODUCT NUMBER
SEE TABLE

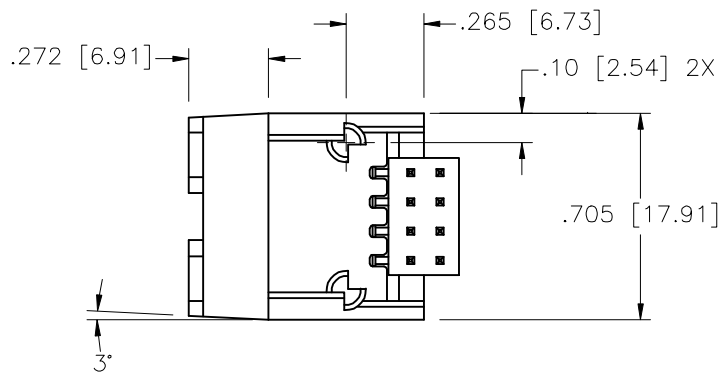
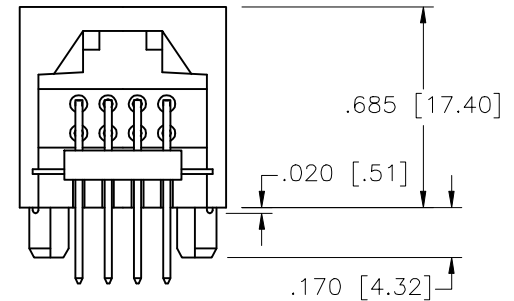
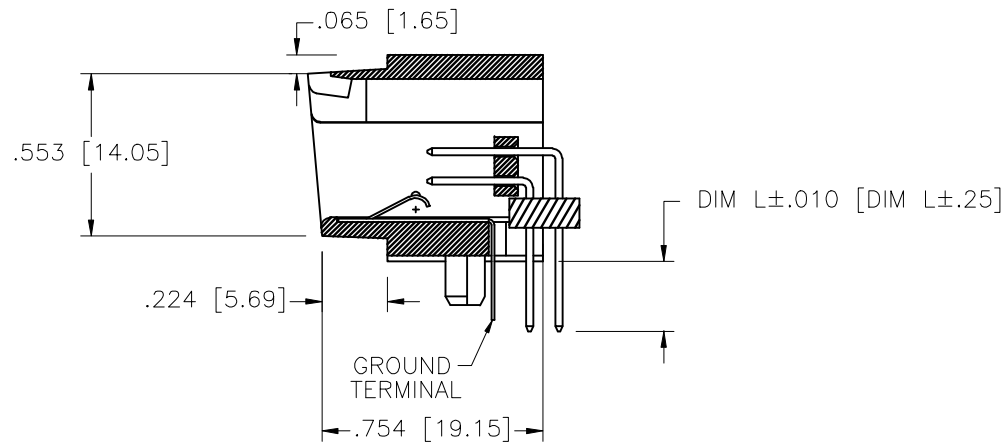

mat'l code		surface ISO 1302		tolerance ISO 406 ISO 1101		projection		product family LATCH-N-LOK	
ltr	ecr no	dr	date	tolerances unless otherwise specified		INCH/MM		title 2X4 LNL STANDARD RT. ANGLE HEADER ASS'Y	
C	M060005	AMR	11/5/96	angles	linear	scale 1:1		dwg no 68293	
D	V01703	TFG	7/24/00					sheet 1 of 2 size A3	
E	V10425	TFG	2/7/01	0° ± 2'				type Product Customer Drawing	
F	M05-0033	ERE	2/25/05	dr	D.A. SMITH	1/24/90			
G	M06-0285	AGS	7/28/06	engr	D. HORCHLER	11/5/90			
H	M06-0365	AGS	9/20/06	chr	D. HORCHLER	11/5/90			
J	M09-0048	MHT	3/12/09	appd	D. HORCHLER	11/5/90			
sheet	revision	J	J						
index	sheet	1	2						

FCJ
FCconnect.com
Copyright FCJ

form A3

PRODUCT NUMBER	COLOR	DIM L	LEAD FREE OPTION	
68293-X01	70343 LF GRAY			OBS
68293-X02	80166 OFF WHITE			
68293-X03	70634 DK GRAY			OBS
68293-X04	701 BLACK	SEE BELOW	NOTE 6 & 7	
68293-X05	70514 SLATE GRAY			OBS
68293-X07	70455 SILVER GRAY			
68293-X08	80189 PEARL WHITE			OBS
68293-X09	70419 PEBBLE GRAY			

PIN LENGTH

DASH No.	DIM L
68293-0XX	.200/5.08
68293-1XX	.130/3.30
68293-2XX	.270/6.86

NOTES:

- HEADER SHROUD
MAT'L: UNFILLED POLYCARBONATE,
94 VO RATED.
- GROUND CONTACT
MAT'L: 3/4 HARD PHOS BRONZE
PLATING: 100-160u"/2.54-4.06u TIN.
- SIGNAL CONTACT
MAT'L: 3/4 HARD PHOS BRONZE
PLATING: 30u"/0.76u PALLADIUM ALLOY WITH GOLD.
FLASS OVER 520u"/1.27u NICKEL
- NUMBERS SHOWN ARE FOR G.E. LEXAN AND ARE FOR REFERENCE ONLY
- THIS ASSEMBLY U.L. APPROVED PER FILE E66906 VOL. 1, SEC 84
AND CSA APPROVED PER MASTER FILE LR46923.
- ADD LF SUFFIX AT THE END OF PART NUMBER FOR LEAD FREE OPTION.
- THIS PRODUCT MEETS EUROPEAN UNION DIRECTIVES AND OTHER
COUNTRY REGULATION AS DESCRIBED IN GS-22-008.
- PLATING OPTIONS:
MAY BE EITHER GOLD OR GXT PLATED AT MANUFACTURER'S OPTION.

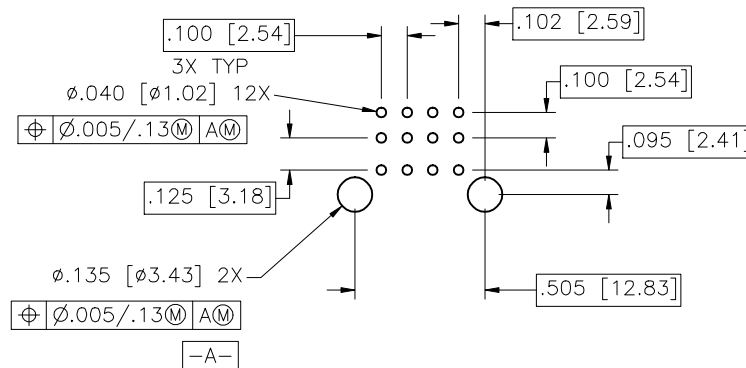

RECOMMENDED PCB LAYOUT

mat'l. code		surface ISO 1302	tolerance ISO 406 ISO 1101	projection INCH/MM	product family LATCH-N-LOK
ltr	ecn no	dr	date	title 2X4 LNL STANDARD RT. ANGLE HEADER ASS'Y	
J				scale 1:1	
angles		linear	tolerances unless otherwise specified .XX±.01/XX±0.3 .XXX±.006/XXX±0.13 XXX±.0020/XXX±0.051		
O'±2'		dr D.A. SMITH 1/24/90			
		engr D. HORCHLER 11/5/90			
		chr D. HORCHLER 11/5/90			
		appd D. HORCHLER 11/5/90			
sheet	revision	type Product Customer Drawing			
index	sheet	dwg no 68293 sheet 2 of 2 size A3			