

HONEYWELL
PART NUMBER
624EN334-R
FAA-PMA

REV	DOCUMENT	CHANGED BY	CHECK
5	0011614	KSR 04MAR05	AK

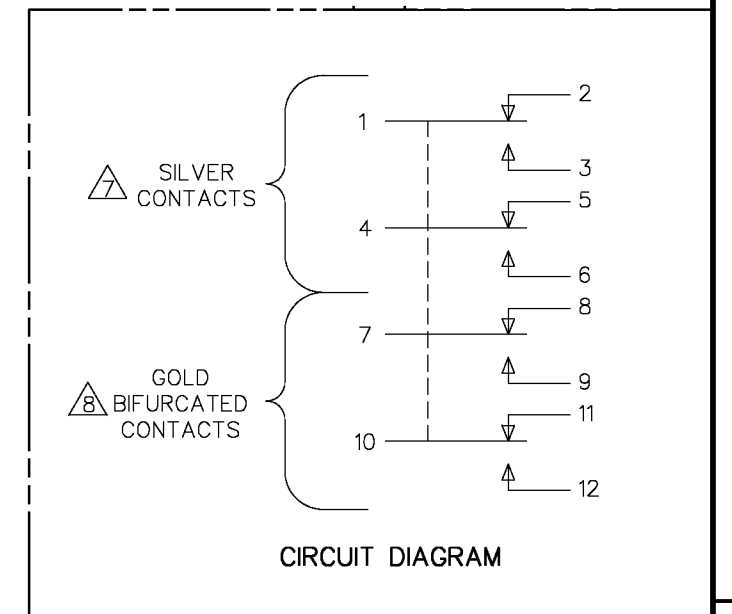

CHARACTERISTICS

OPERATING FORCE	6-12 LBS
FULL OVERTRAVEL FORCE	30 LBS MAX
RELEASE FORCE	4 LBS MIN
PRETRAVEL	.040 MAX
DIFFERENTIAL TRAVEL	.020 MAX
OVERTRAVEL	.125 MIN

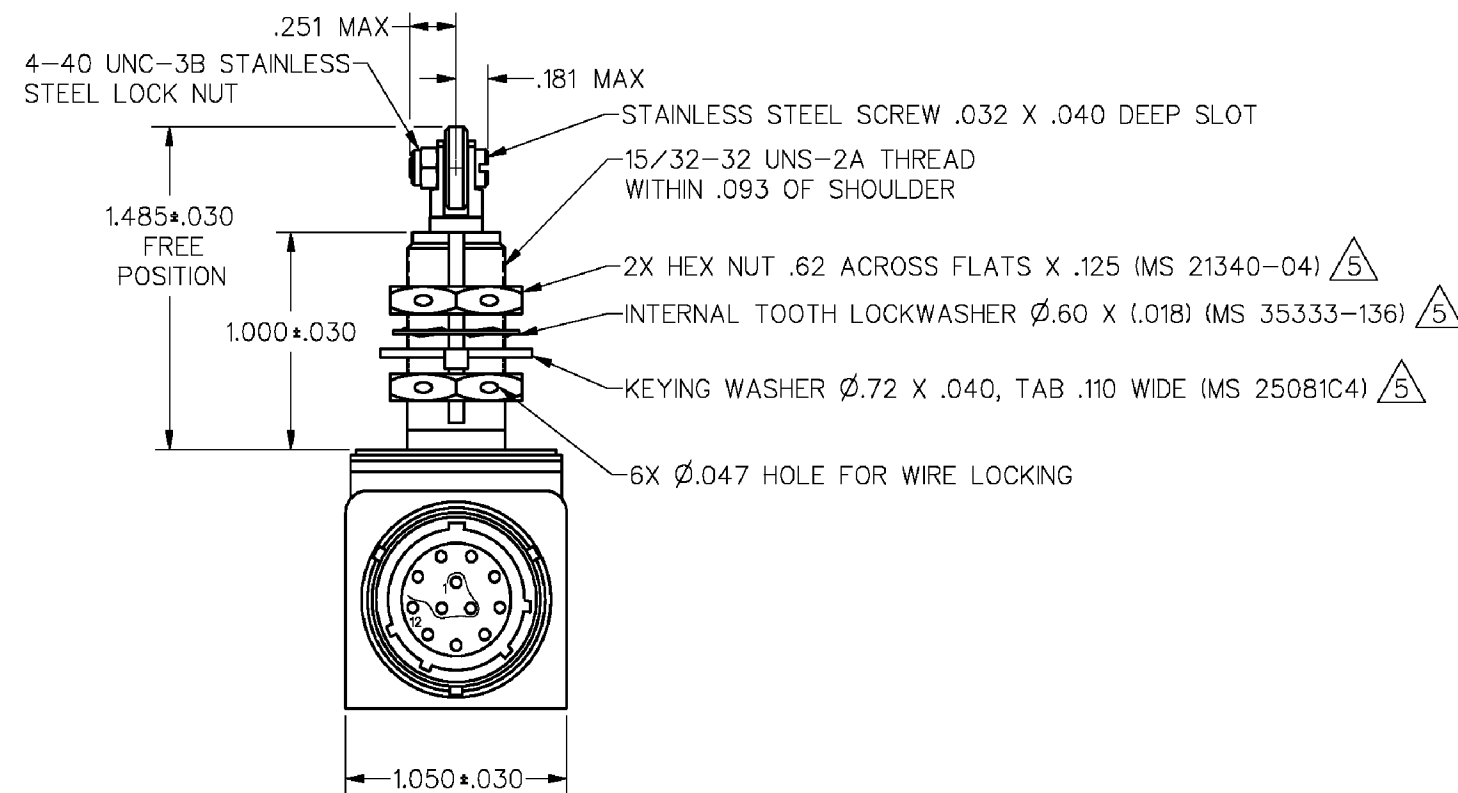
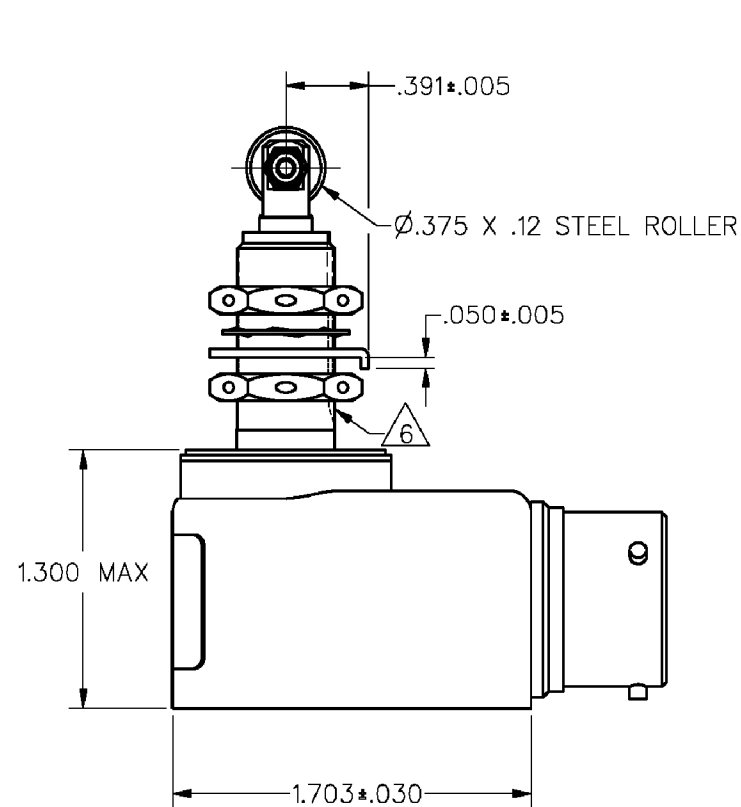
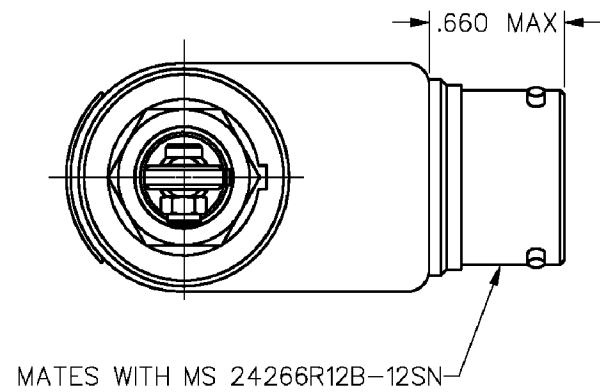

NOTES

- 1 - CORROSION RESISTANT STEEL ROLLER, PLUNGER, NUTS, WASHERS, BUSHING AND ENCLOSURE
- 2 - SWITCH SEALED PER MIL-S-8805 SYMBOL 4
- 3 - COINCIDENCE OF OPERATING AND RELEASING POINT: .010 INCH OF PLUNGER TRAVEL
- 4 - CIRCUIT DIAGRAM, CATALOG LISTING, FED MFG CODE, DATE CODE AND FAA-PMA ON NAMEPLATE
- 5 - HARDWARE MAY BE PACKAGED UNASSEMBLED PER MIL-S-8805
- 6 - KEYWAY .072 ± .004 WIDE X .031 ± .003 DEEP TO WITHIN .250 OF SHOULDER
- 7 - 1SX TYPE BASIC SWITCH
- 8 - 12SX TYPE BASIC SWITCH
- 9 - FURNISHED WITH SNUG FITTING DUST CAP
- 10 - FOR MANUFACTURING DETAILS SEE ASSEMBLY DRAWING 624EN334-R FOR FAA-PMA

ELECTRICAL DATA

CONTACT ARRANGEMENT: 4X S P D T

RATINGS APPLY TO CIRCUITS 7-12						RATINGS APPLY TO CIRCUITS 1-6			
SEA LEVEL						50,000 FT			
LOAD	28 VDC	5VDC	30 mVDC PEAK AC	28 VDC	5VDC	28 VDC	5VDC	28 VDC	28 VDC
RES	1.0	0.01	0.01	1.0	0.01	7		7	
IND	0.5			0.5		4		4	2.5
MOTOR						4			

DESIGN UNITS: INCH
TOLERANCES UNLESS NOTED:

NO PLACE	X	±	
ONE PLACE	.X	±	0.030
TWO PLACE	.XX	±	0.015
THREE PLACE	.XXX	±	0.005
FOUR PLACE	.XXXX	±	
ANGLES		±	

THIRD ANGLE PROJECTION

DRAWN	SAV	17FEB93
CHECK	WLS	25FEB93

THIS DRAWING COVERS A PROPRIETARY ITEM AND IS THE PROPERTY OF HONEYWELL. THIS DRAWING IS NOT TO BE COPIED OR USED WITHOUT THE PERMISSION OF HONEYWELL.

INTERPRET PER ASME Y14.5M-1994 OTHER HONEYWELL ENGINEERING STANDARDS MAY APPLY

RASTER

Honeywell

TITLE: **SWITCH - ENCLOSED**

SIZE	TYPE	DRAWING NAME	REV
C	I	624EN334-R	5

SCALE 1.5:1 WEIGHT 6 OZ MAX SHEET 1 OF 1